

How to Order?

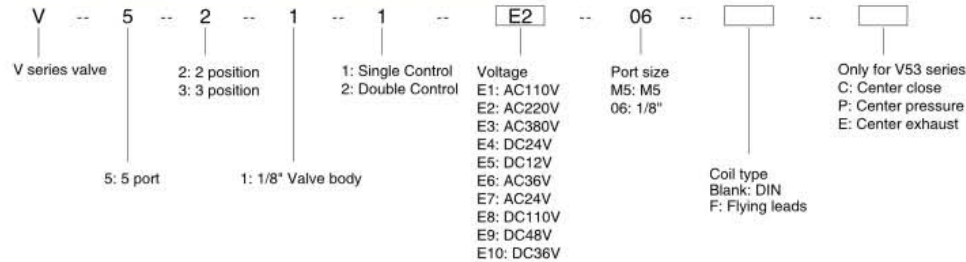

* V series, solenoid valve, 5 port, 2 position, single control, 1/8" valve body, AC110V, 1/8" port size, DIN coil, model: V5211E1-06
 * V series, solenoid valve, 5 port, 3 position, double control, 1/8" valve body, DC24V, 1/8" port size, DIN coil, center close, model: V5312E4-06C

Product Features

- * Stable life cycle, guaranteed 12,000,000 times.
- * Various voltage and working style are available.
- * Different surface treatment, thread types (BSPP, BSPT, NPT) are available.
- * Manifolds are available for all types and sizes.

Specifications

Model No.	V5211-M5/06	V5212-M5/06	V5312-M5C/06C	V5312-M5E/06E	V5312-M5P/06P
Working medium	Clean air (After 25 μm filtration)				
Acting type	Pilot type				
Sectional area (mm ²)	M5: 5.5 (CV=0.31) ** 06: 12 (CV=0.67)		M5: 5.5 (CV=0.28) ** 06: 9 (CV=0.50)		
Port size	In=Out=Exhaust=M5 In=Out=Exhaust=G1/8				
Lubrication	Not required				
Working pressure (Bar)	1.5-8				
Guaranteed pressure (Bar)	12				
Working temperature (°C)	-5-60				
Voltage range	-15% - 10%				
Power consumption	AC: 3.0VA, DC: 2.8W				
Insulation class	Class F				
Protective class	IP65 (DIN40050)				
Max. acting frequency	5 cycles/s		3 cycles/s		
Activate time(s)	<0.05				
Weight(g)	110	171	181	181	181

Internal structure

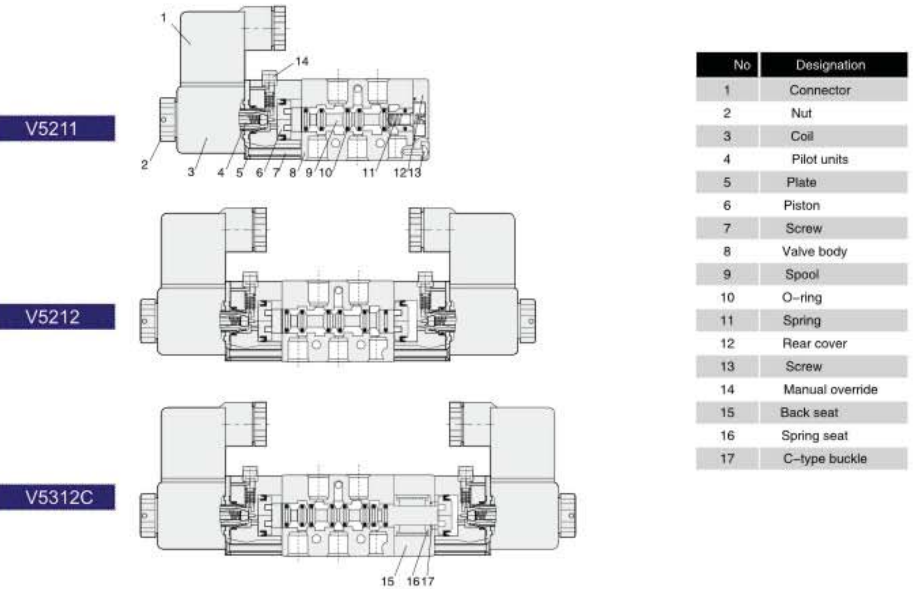

Flow Chart

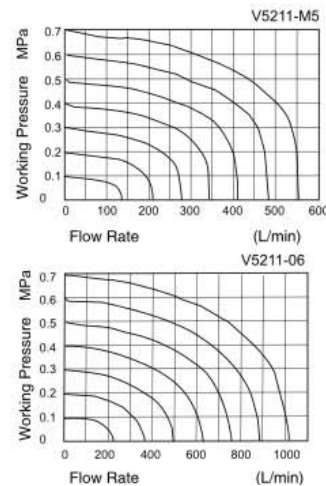

Main Parts Material

Part name	Material
Valve body	Aluminum alloy
Spool	Aluminum alloy
Manual override O-ring	NBR
Connector washer	NBR
Spool O-ring	HNBR
Seal	NBR
Piston	POM
Manual override	Cu
Plate	Steel
Nut	POM+Carbon steel
Rear cover	Zinc alloy
Manual override spring	Stainless steel
Spool spring	Stainless steel
Screw	Steel
Pilot units	Pure steel+Cu+Stainless steel
Back seat	Aluminum alloy
Spring seat	Aluminum alloy
C-type buckle	65Mn
Connector	Engineering plastic

Main Dimension (mm)

V5211

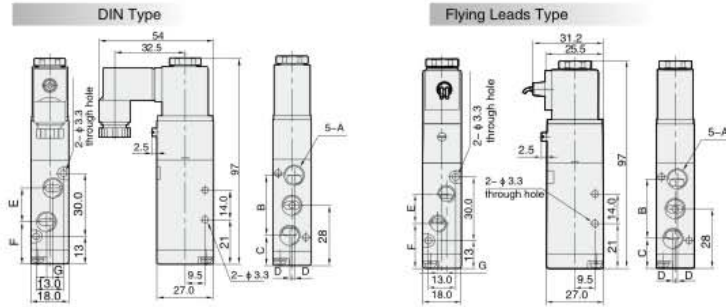

Sign/Model	A	B	C	D	E	F	G
V5211-M5	M5 x 0.8	27.5	14.2	0	14.5	20.7	0
V5211-06	G1/8	28	14	1	16	20	3

V5212

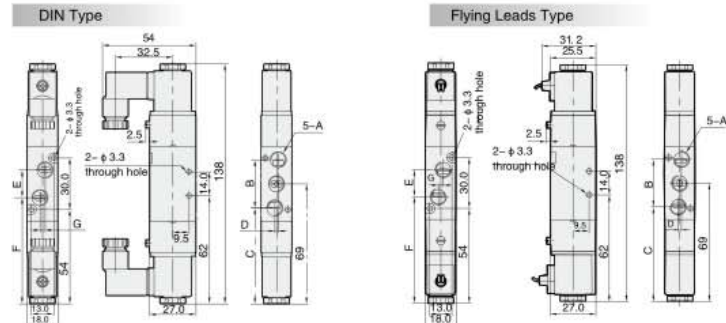

Sign/Model	A	B	C	D	E	F	G
V5212-M5	M5 x 0.8	27.5	55.25	0	14.5	61.75	0
V5212-06	G1/8	28	55	1	16	61	3

V5312

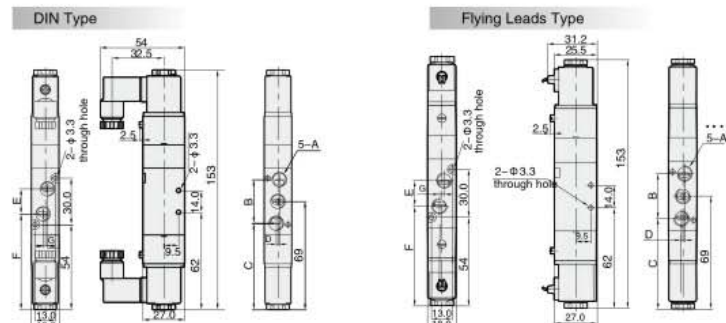

Sign/Model	A	B	C	D	E	F	G
V5312-M5	M5 x 0.8	27.5	55.25	0	14.5	61.75	0
V5312-06	G1/8	28	55	1	16	61	3

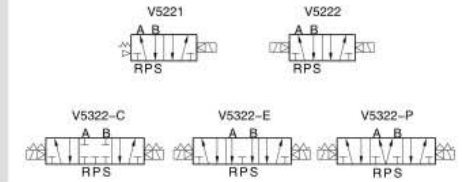

How to Order?

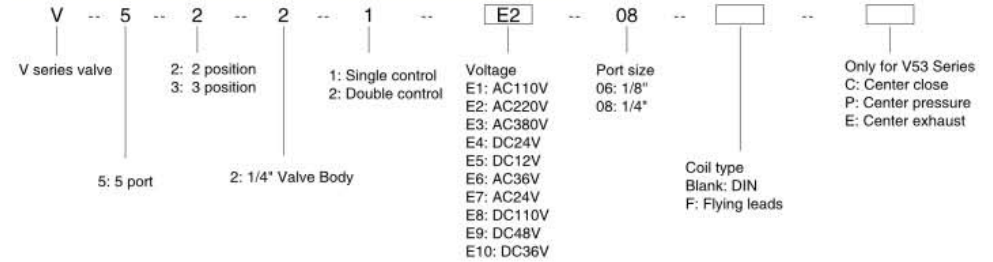

- * V series, solenoid valve, 5 port, 2 position, 1/4" valve body, single control, AC110V, 1/4" port size, DIN coil, model: V5221E1-08
- * V series, solenoid valve, 5 port, 3 position, 1/4" valve body, double control, DC24V, 1/4" port size, DIN coil, center close, model: V5322E4-08C

Product Features

- * Stable life cycle, guaranteed 12,000,000 times.
- * Various voltage and working style are available.
- * Different surface treatment, thread types (BSPP, BSPT, NPT) are available.
- * Manifolds are available for all types and sizes.

Specifications

Model No.	V5221-06/08	V5222-06/08	V5322-06C/08C	V5322-06E/08E	V5322-06P/08P
Working medium	Clean air (After 25 μm filtration)				
Acting type	Pilot type				
Sectional area (mm ²)	06: 14 (CV=0.78) ** 08: 16 (CV=0.89)		06: 12 (CV=0.67) ** 08: 12 (CV=0.67)		
Port size	In=Out=Exhaust=G1/8 In=Out=G1/4, Exhaust=G1/8				
Lubrication	Not required				
Working pressure (Bar)	1.5~8				
Guaranteed pressure (Bar)	12				
Working temperature (°C)	-5~60				
Voltage range	-15% +10%				
Power consumption	AC: 5.5VA, DC: 4.8W				
Insulation	Class F				
Protective class	IP65 (DIN40050)				
Max. acting frequency	5 cycle/s		3 cycle/s		
Activate time (s)	<0.05				
Weight (g)	209	314	357	357	357

Internal structure

V5221

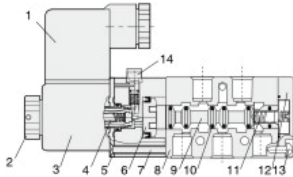

V5222

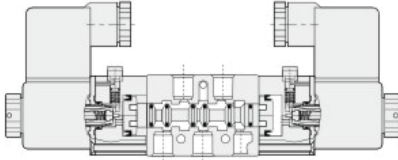

V5322-C

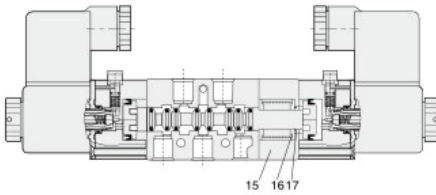

No	Designation
1	Connector
2	Nut
3	Coil
4	Pilot units
5	Plate
6	Piston
7	Screw
8	Valve body
9	Spool
10	O-ring
11	Spring
12	Rear cover
13	Screw
14	Manual override
15	Back seat
16	Spring seat
17	C-type buckle

Main Parts Material

Part name	Material
Valve body	Aluminum alloy
Spool	Aluminum alloy
Manual override O-ring	NBR
Connector washer	NBR
Spool O-ring	HNBR
Seal	NBR
Piston	POM
Manual override	Plastic
Plate	Steel
Nut	POM+Carbon steel
Rear cover	Zinc alloy
Manual override spring	Stainless steel
Spool spring	Stainless steel
Screw	Steel
Pilot units	Pure steel+Cu+Stainless steel
Back seat	Aluminum alloy
Spring seat	Aluminum alloy
C-type buckle	65Mn
Connector	Engineering plastic

Flow Chart

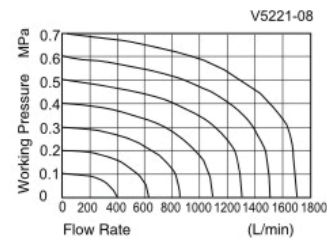
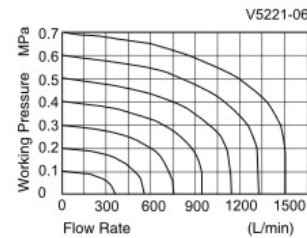

Main Dimension (mm)

V5221

DIN Type

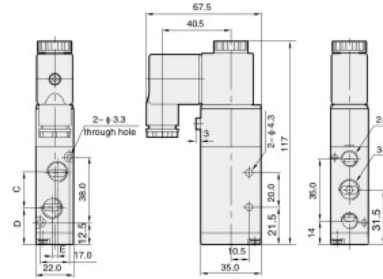

Flying Leads Type

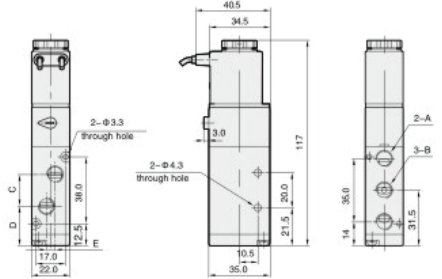

Sign/Model	A	B	C	D	E
V5221-06	G1/8	G1/8	18	22.5	0
V5221-08	G1/8	G1/4	20	21.5	3

V5222

DIN Type

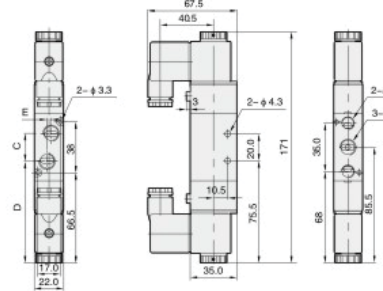

Flying Leads Type

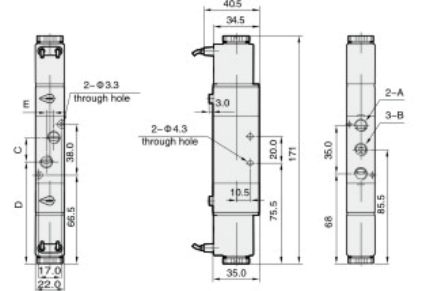

Sign/Model	A	B	C	D	E
V5222-06	G1/8	G1/8	18	76.5	0
V5222-08	G1/8	G1/4	20	75.5	3

V5322

DIN Type



Flying Leads Type

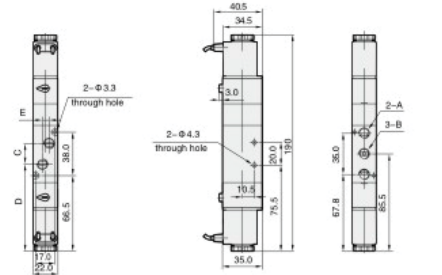

Sign/Model	A	B	C	D	E
V5322-06	G1/8	G1/8	18	76.5	0
V5322-08	G1/8	G1/4	20	75.5	3

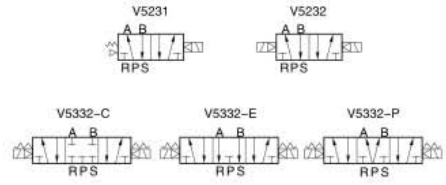

How to Order?

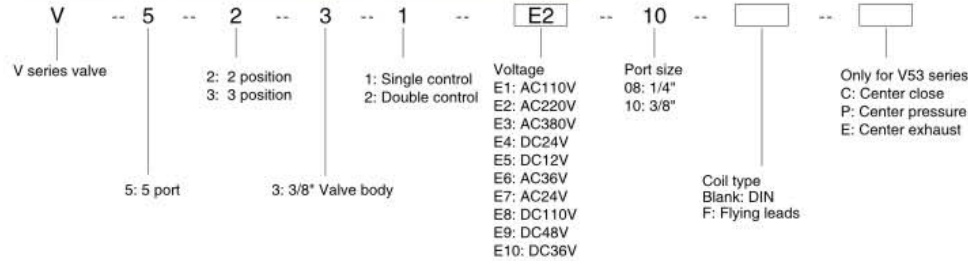

* V series, solenoid valve, 5 port, 2 position, single control, 3/8" valve body, AC110V, 3/8" port size, DIN coil, model: V5231E1-10

* V series, solenoid valve, 5 port, 3 position, double control, 3/8" valve body, DC24V, 3/8" port size, DIN coil, center close, model: V5332E4-10C

Product Features

- * Stable life cycle, guaranteed 12,000,000 times.
- * Various voltage and working style are available.
- * Different surface treatment, thread types (BSPP, BSPT, NPT) are available.
- * Manifolds are available for all types and sizes.

Specifications

Model No.	V5231-08/10	V5232-08/10	V5332-08C/10C	V5332-08E/10E	V5332-08P/10P
Working medium	Clean air (After 25 μm filtration)				
Acting type	Pilot type				
Sectional area (mm ²)	08: 25 (CV=1.40) ** 10: 30 (CV=1.68)	08: 18 (CV=1.00) ** 18 (CV=1.00)			
Port size	In=Out=Exhaust=G1/4 In=Out=G3/8, Exhaust=G1/4				
Lubrication	Not required				
Working pressure (Bar)	1.5-8				
Guaranteed pressure (Bar)	12				
Working temperature (°C)	-5-60				
Voltage range	-15% +10%				
Power consumption	AC: 5.5VA, DC: 4.8W				
Insulation class	Class F				
Protective class	IP65 (DIN40050)				
Max. acting frequency	5 cycles/s		3 cycles/s		
Activate time(s)	> 0.05				
Weight(g)	289	400	450	450	450

Internal structure

V5231

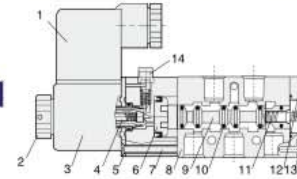

V5232

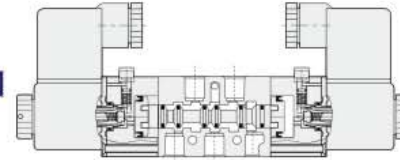

V5332-C

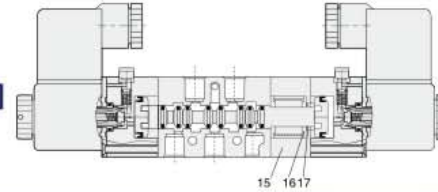

No	Designation
1	Connector
2	Nut
3	Coil
4	Pilot units
5	Plate
6	Piston
7	Screw
8	Valve body
9	Spool
10	O-ring
11	Spring
12	Rear cover
13	Screw
14	Manual override
15	Back seat
16	Spring seat
17	C-type buckle

Main Parts Material

Part name	Material
Valve body	Aluminum alloy
Spool	Aluminum alloy
Manual override O-ring	NBR
Connector washer	NBR
Spool O-ring	HNBR
Seal	NBR
Piston	POM
Manual override	Plastic
Plate	Steel
Nut	POM+Carbon steel
Rear cover	Zinc alloy
Manual override spring	Stainless steel
Spool spring	Stainless steel
Screw	Steel
Pilot units	Pure steel+Cu+Stainless steel
Back seat	Aluminum alloy
Spring seat	Aluminum alloy
C-type buckle	65Mn
Connector	Engineering plastic

Flow Chart

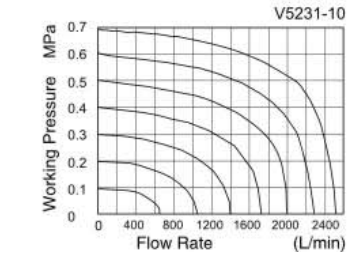
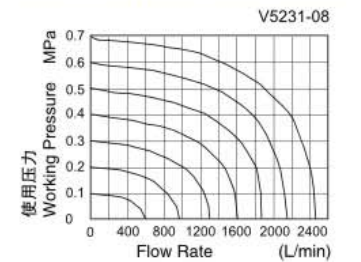

○ Main Dimension (mm)

V5231

DIN Type

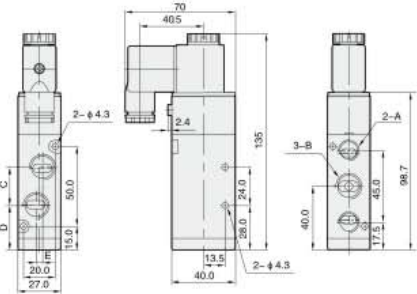

引出线式 Flying Leads Type

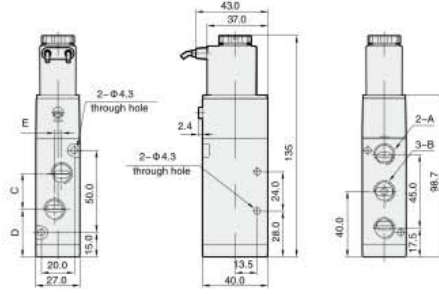

Sign/Model	A	B	C	D	E
V5231-08	G1/4	G1/4	24	28	0
V5231-10	G1/4	G3/8	24	28	4

V5232

DIN Type

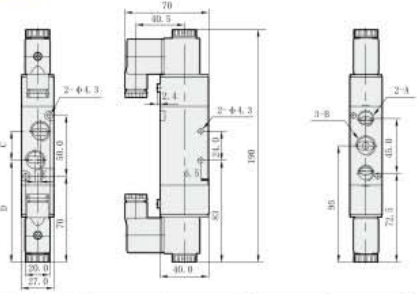

Flying Leads Type

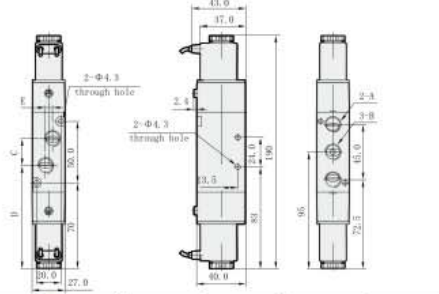

Sign/Model	A	B	C	D	E
V5232-08	G1/4	G1/4	24	83	0
V5232-10	G1/4	G3/8	24	83	4

V5332

DIN Type

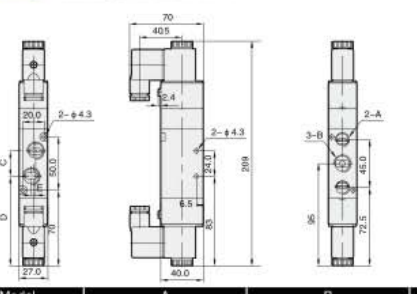

Flying Leads Type

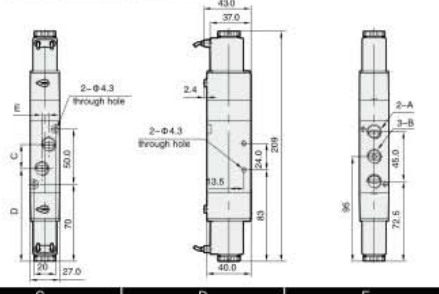

Sign/Model	A	B	C	D	E
V5233-08	G1/4	G1/4	24	83	0
V5233-10	G1/4	G3/8	24	83	4

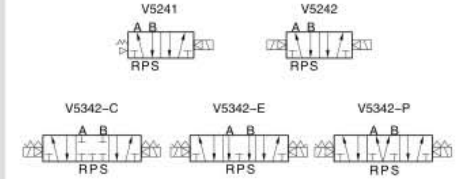

○ How to Order?

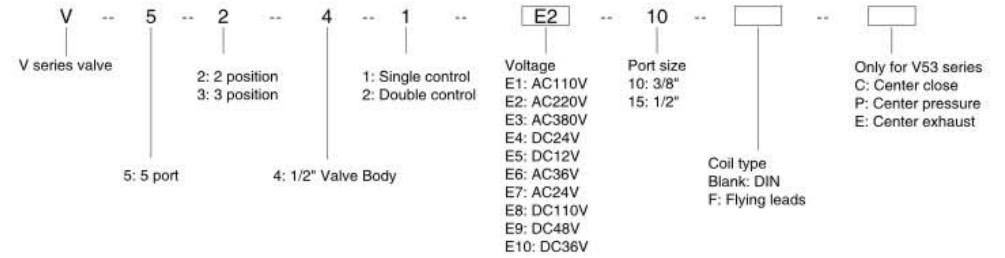

* V series, solenoid valve, 5 port, 3 position, 1/2" valve body, double control, DC24V, 1/2" port size, DIN coil, center close, model: V5342E4-15C

○ Product Features

- Stable life cycle, guaranteed 12,000,000 times.
- Various voltage and working styles are available.
- Different surface treatment, thread type (BSPP, BSPT, NPT) are available.
- Manifolds are available for all types and sizes.

○ Specifications

Model No.	V5241-15	V5242-15	V5342-15C	V5342-15E	V5342-15P
Working medium	Clean air (After 25 μm filtration)				
Acting type	Pilot type				
Sectional area (mm ²)	50 (CV=2.79)		30 (CV=1.67)		
Port size	In=Out=Exhaust=G1/2				
Lubrication	Not required				
Working pressure (Bar)	1.5-8				
Guaranteed pressure (Bar)	12				
Working temperature (°C)	-5-60				
Voltage range	-15% +10%				
Power consumption	AC: 5.5VA, DC: 4.8W				
Insulation	Class F				
Protective class	IP65 (DIN40050)				
Max. acting frequency	3 cycles/s				
Activate time (s)	<0.05				
Weight (g)	528	638	727	727	727

Internal structure

V5241

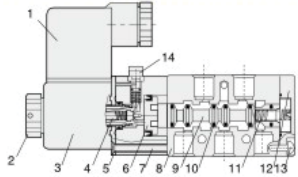

V5242

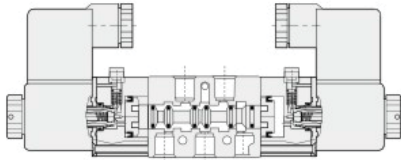

V5342-C

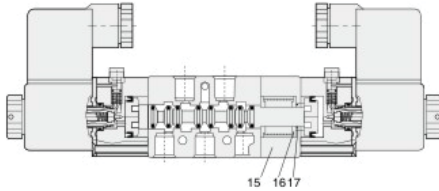

No	Designation
1	Connector
2	Nut
3	Coil
4	Pilot units
5	Plate
6	Piston
7	Screw
8	Valve body
9	Spool
10	O-ring
11	Spring
12	Rear cover
13	Screw
14	Manual override
15	Back seat
16	Spring seat
17	C-type buckle

Main Parts Material

Part name	Material
Valve body	Aluminum alloy
Spool	Aluminum alloy
Manual override O-ring	NBR
Connector washer	NBR
Spool O-ring	HNBR
Seal	NBR
Piston	POM
Manual override	Cu
Plate	Steel
Nut	POM+Carbon steel
Rear cover	Zinc alloy
Manual override spring	Stainless steel
Spool spring	Stainless steel
Screw	Steel
Pilot units	Pure steel+Cu+Stainless steel
Back seat	Aluminum alloy
Spring seat	Aluminum alloy
C-type buckle	65Mn
Connector	Engineering plastic

Flow Chart

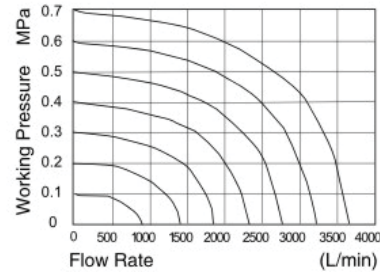

Main Dimension (mm)

V5241

DIN Type

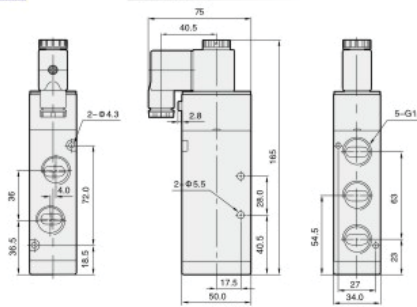

Flying Leads Type

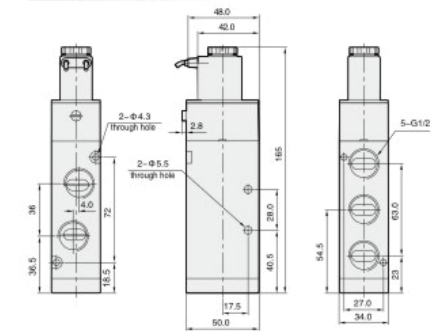

V5242

DIN Type

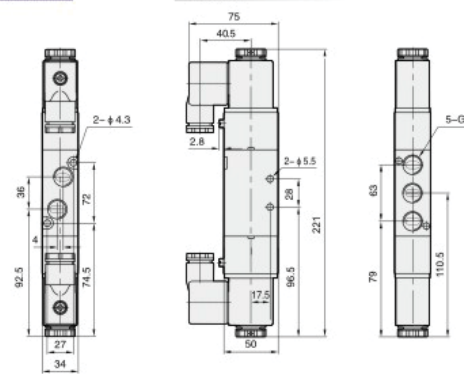

Flying Leads Type

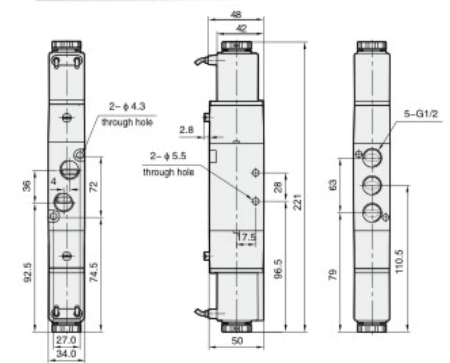

V5342-C

DIN Type

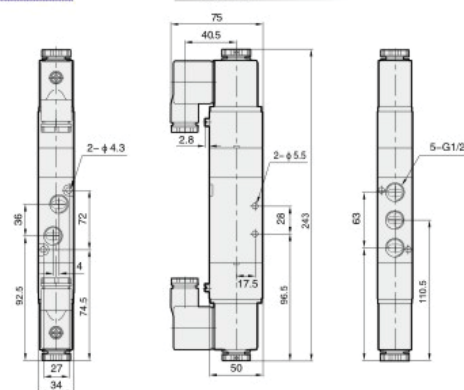

Flying Leads Type

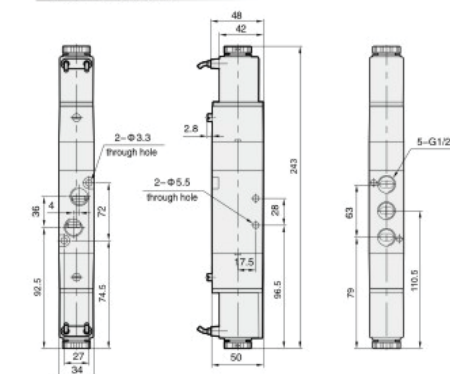

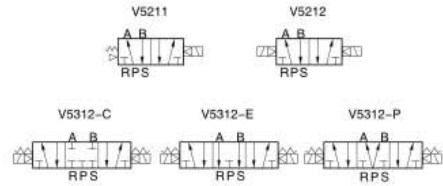

How to Order?

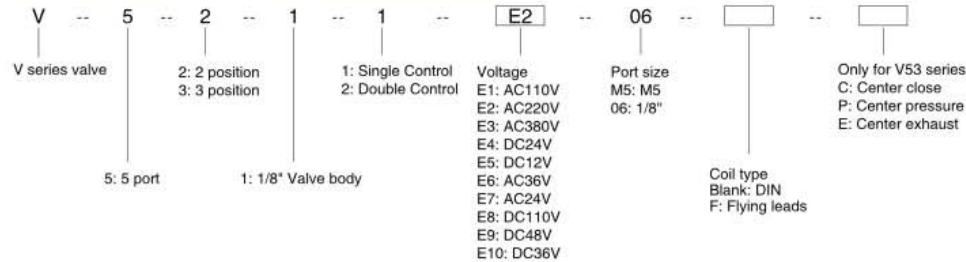

* V series, solenoid valve, 5 port, 2 position, single control, 1/8" valve body, AC110V, 1/8" port size, DIN coil, model: V5211E1-06
 * V series, solenoid valve, 5 port, 3 position, double control, 1/8" valve body, DC24V, 1/8" port size, DIN coil, center close, model: V5312E4-06C

Product Features

- * Stable life cycle, guaranteed 12,000,000 times.
- * Various voltage and working style are available.
- * Different surface treatment, thread types (BSPP, BSPT, NPT) are available.
- * Manifolds are available for all types and sizes.

Specifications

Model No.	V5211-M5/06	V5212-M5/06	V5312-M5C/06C	V5312-M5E/06E	V5312-M5P/06P
Working medium	Clean air (After 25 μm filtration)				
Acting type	Pilot type				
Sectional area (mm ²)	M5: 5.5 (CV=0.31) ** 06: 12 (CV=0.67)		M5: 5.5 (CV=0.28) ** 06: 9 (CV=0.50)		
Port size	In=Out=Exhaust=M5 In=Out=Exhaust=G1/8				
Lubrication	Not required				
Working pressure (Bar)	1.5-8				
Guaranteed pressure (Bar)	12				
Working temperature (°C)	-5-60				
Voltage range	-15% - 10%				
Power consumption	AC: 3.0VA, DC: 2.8W				
Insulation class	Class F				
Protective class	IP65 (DIN40050)				
Max. acting frequency	5 cycles/s		3 cycles/s		
Activate time(s)	<0.05				
Weight(g)	110	171	181	181	181

Internal structure

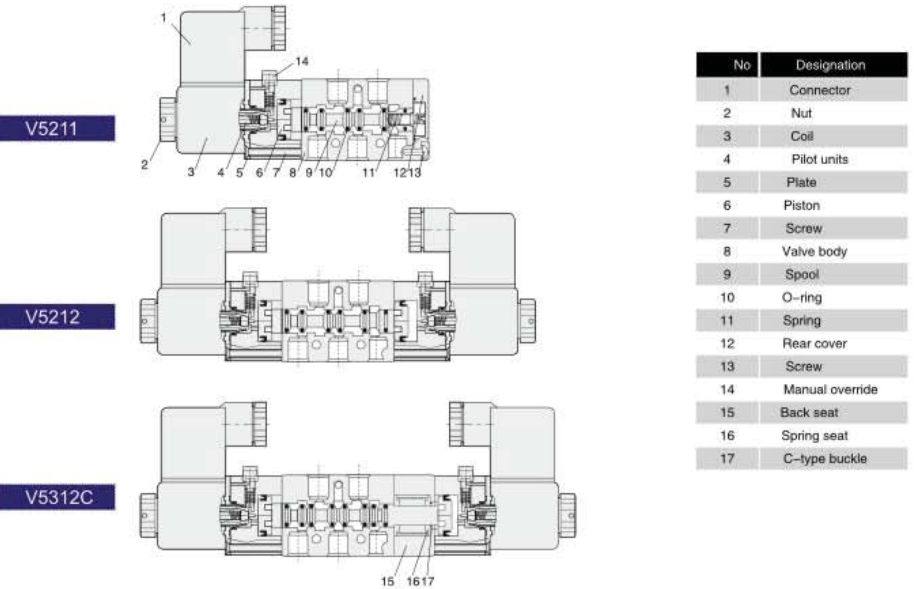

Flow Chart

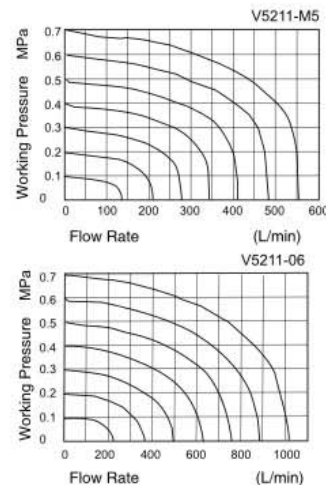

Main Parts Material

Part name	Material
Valve body	Aluminum alloy
Spool	Aluminum alloy
Manual override O-ring	NBR
Connector washer	NBR
Spool O-ring	HNBR
Seal	NBR
Piston	POM
Manual override	Cu
Plate	Steel
Nut	POM+Carbon steel
Rear cover	Zinc alloy
Manual override spring	Stainless steel
Spool spring	Stainless steel
Screw	Steel
Pilot units	Pure steel+Cu+Stainless steel
Back seat	Aluminum alloy
Spring seat	Aluminum alloy
C-type buckle	65Mn
Connector	Engineering plastic

Main Dimension (mm)

V5211

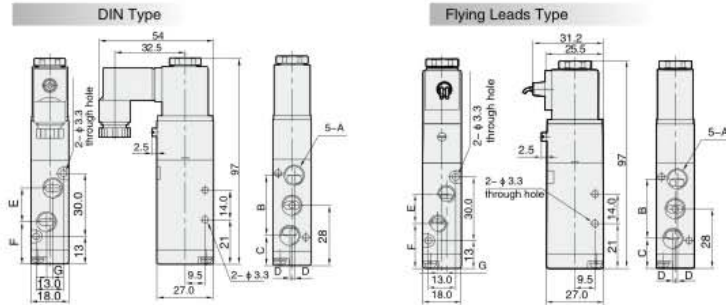

Sign/Model	A	B	C	D	E	F	G
V5211-M5	M5 x 0.8	27.5	14.2	0	14.5	20.7	0
V5211-06	G1/8	28	14	1	16	20	3

V5212

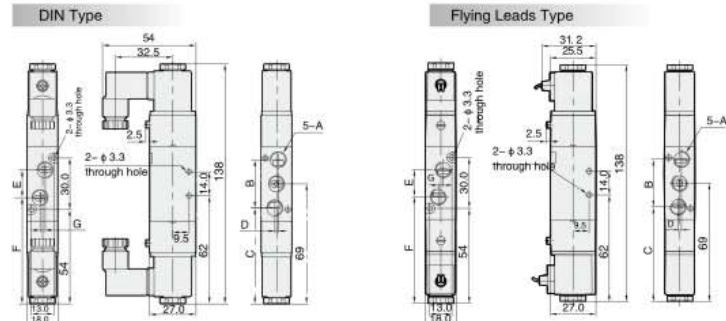

Sign/Model	A	B	C	D	E	F	G
V5212-M5	M5 x 0.8	27.5	55.25	0	14.5	61.75	0
V5212-06	G1/8	28	55	1	16	61	3

V5312

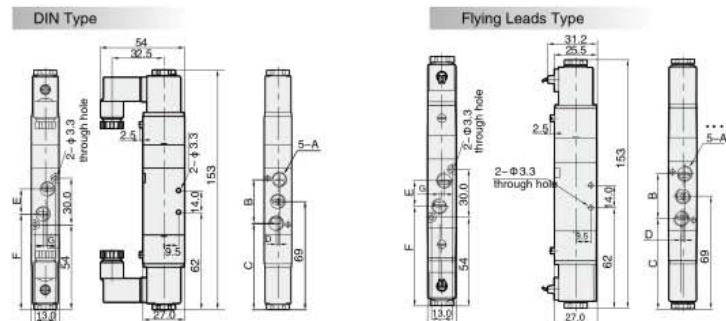

Sign/Model	A	B	C	D	E	F	G
V5312-M5	M5 x 0.8	27.5	55.25	0	14.5	61.75	0
V5312-06	G1/8	28	55	1	16	61	3

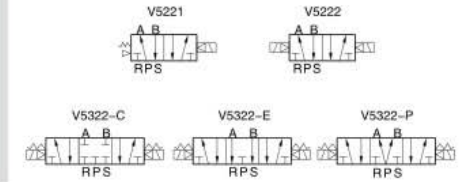

How to Order?

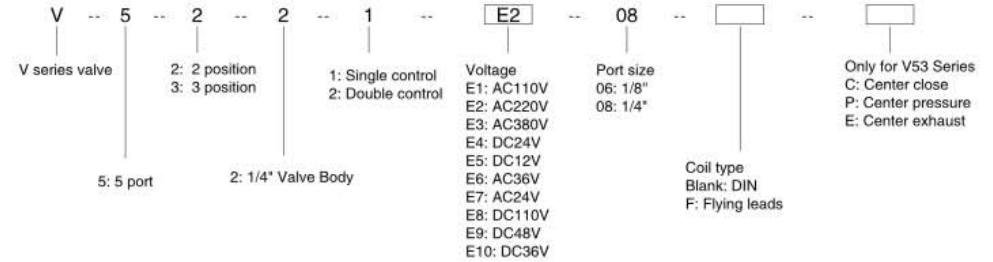

- * V series, solenoid valve, 5 port, 2 position, 1/4" valve body, single control, AC110V, 1/4" port size, DIN coil, model: V5221E1-08
- * V series, solenoid valve, 5 port, 3 position, 1/4" valve body, double control, DC24V, 1/4" port size, DIN coil, center close, model: V5322E4-08C

Product Features

- * Stable life cycle, guaranteed 12,000,000 times.
- * Various voltage and working style are available.
- * Different surface treatment, thread types (BSPP, BSPT, NPT) are available.
- * Manifolds are available for all types and sizes.

Specifications

Model No.	V5221-06/08	V5222-06/08	V5322-06C/08C	V5322-06E/08E	V5322-06P/08P
Working medium	Clean air (After 25 μm filtration)				
Acting type	Pilot type				
Sectional area (mm ²)	06: 14 (CV=0.78) ** 08: 16 (CV=0.89)		06: 12 (CV=0.67) ** 08: 12 (CV=0.67)		
Port size	In=Out=Exhaust=G1/8 In=Out=G1/4, Exhaust=G1/8				
Lubrication	Not required				
Working pressure (Bar)	1.5~8				
Guaranteed pressure (Bar)	12				
Working temperature (°C)	-5~60				
Voltage range	-15% +10%				
Power consumption	AC: 5.5VA, DC: 4.8W				
Insulation	Class F				
Protective class	IP65 (DIN40050)				
Max. acting frequency	5 cycle/s		3 cycle/s		
Activate time (s)	<0.05				
Weight (g)	209	314	357	357	357