



Minimum tube length



Spring loaded shaft

# MDR Brushless DC Motorized pulley PM320HS Roller diameter $\varnothing 32$

Roller diameter  $\varnothing 32$ 

10W

# PM320HS

- Roller diameter /  $\varnothing 32$
- Thickness / t2.0
- Voltage / 24V DC
- Tube material / SUS304

Insulation	Class E equivalent
Operation	Continuous duty
Thermal Protection	Protection
Protection	IP 65

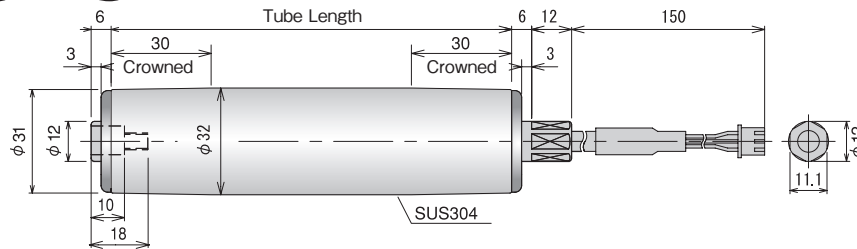

## Tube Length : PM320HS



Minimum tube length 170mm

Tube Length (mm)	170	220	270	320	370	420	470
Weight (kg)	0.7	0.9	1.0	1.0	1.1	1.2	1.3

- Spring loaded shaft is not available for this component.
- Dimensions other than those shown above cannot be produced.
- Conveyor frame inside dimension and frame hole shape vary by the manufacturer.
- A gap of 6mm is required between the frame inside dimension and Power Moller.

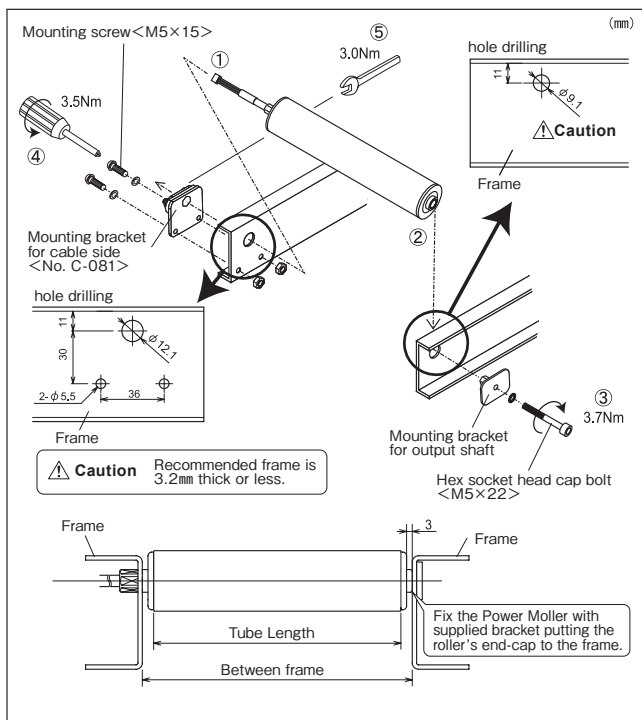

## Product Designation :

**PM320HS - 30 - 220 - D - 024 - PC**

Power Moller model    Nominal Speed    Tube Length    Voltage    Crowned

Motor type : HS

Nominal Speed : 30

Tube Length : 170, 220, 270, 320, 370, 420, 470

Voltage : D-024 (24VDC)

## Operating Characteristics : CB-018

Default

Nominal Speed (m/min)	Speed (m/min)		Tangential Force(N)		Current (A)		Driver setting			
	No load	Nominal	Nominal	Starting	No load	Nominal	Starting	SW4 CN2-3	SW5 CN2-4	SW6 CN2-5
30	28.0	25.8	24.4	37.2	0.32	0.90	2.2	ON	ON	ON
25	24.7	24.7	24.5		0.26	0.89		ON	ON	OFF
22	22.0	22.0	24.9		0.21	0.83		ON	OFF	ON
19	18.8	18.8	25.3		0.20	0.74		ON	OFF	OFF
16	15.9	15.9	25.8		0.16	0.67		OFF	ON	ON
13	13.0	13.0	26.2		0.13	0.61		OFF	ON	OFF
10	9.9	9.9	26.6		0.10	0.53		OFF	OFF	ON
6	5.8	5.8	27.2		0.06	0.44		OFF	OFF	OFF

## Mounting bracket for output shaft

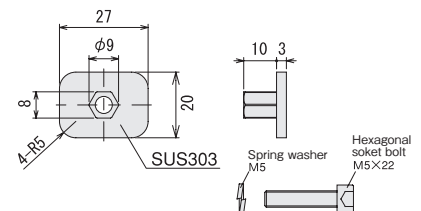

- Apply 3.7N·m torque for securing the power Moller mounting.

## No.C-081

### Mounting bracket for cable side

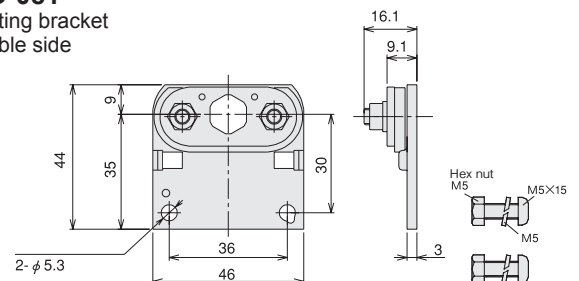

- Apply 3Nm torque for securing the Power Moller mounting shaft, and 3.5Nm for securing the bracket.
- In the case of water-proof environment, order No. C-081-D.

## [When Using in a Water-proof Environment]

Specify the following at the time of ordering.

- ① power cable extension → 1000mm [Model: C100]
- ② Change of the included bracket → No. C-081-D (SUS material) included

ex. **PM320HS - 30 - 220 - D - 024 - C100 - PC**  
**No.C - 081 - D**



Minimum tube length



Spring loaded shaft

# MDR Brushless DC Motor standard type PM486FE

Roller diameter  $\phi 48.6$ 

## Roller diameter $\phi 48.6$ PM486FE

- Roller diameter /  $\phi 48.6$
- Thickness / t1.4
- Voltage / 24V DC
- Tube material / STKM12
- Surface treatment / Trivalent chromate processing

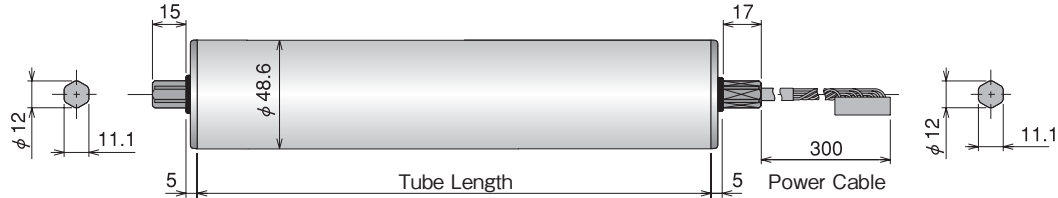

### Tube Length : PM486FE

	290mm	290mm $\leq$						
Tube Length (mm)	300	400	500	600	700	800	900	1000
Weight (kg)	2.4	2.5	2.7	2.8	3.0	3.1	3.3	3.4
Spring loaded shaft	<input type="radio"/>	<input type="radio"/>	<input type="radio"/>	<input type="radio"/>	<input type="radio"/>	<input type="radio"/>	<input type="radio"/>	<input type="radio"/>

- Conveyor frame inside dimension and frame hole shape vary by the manufacturer.
- A gap of 2-5mm is required between the frame inside dimension and Power Moller.

### Product Designation :

**PM486FE - 17 - 400 - D - 024 - BR**

Power Moller model    Nominal Speed    Tube Length    Voltage    Options

- Motor type : FE
- Nominal Speed : 17,60,210
- Tube Length : Specify in mm.
- Voltage : D-024 (24VDC)
- Options : Each of the following optional specification may be selected.

### Mounting Bracket : No.MBB-081

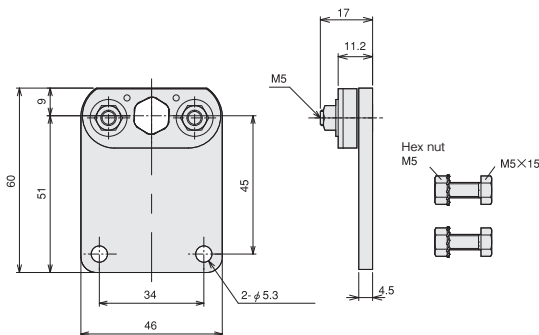

\*Attach to the power cable side.

- Apply 6-10Nm torque for securing the Power Moller mounting shaft, and 3.5Nm for securing the bracket.

### Options : PM486FE

	<b>Rubber Laggings - NR, UR, NB, CR</b> Natural rubber, Urethane, NBR, Neoprene	P.66
	<b>BR Built-In Brake - BR<sup>*1</sup></b> 360mm     360mm $\leq$	P.67
	<b>VG Poly V-Belt Pulley</b> 290mm     290mm $\leq$	P.70
	<b>VP V-Belt Pulley</b> 300mm     300mm $\leq$	P.71
	<b>P2 Double Grooved Tube<sup>**2</sup></b> 340mm     340mm $\leq$	P.72

**JD**

### Both-end D-shaped shaft

\*<sup>1</sup> When holding type built-in brake is required, specify along with a driver card compatible with such brake specification.

[Electric brake (no holding function)] is included in the standard specification.

\*\*<sup>2</sup> Up to 800mm can be produced.

- For other specification, refer to P.73.

 [MDR Selection Tool] is available on our web page.

## Operating characteristics with CB-016N6 driver card

### PM486FE-17

Speed (m/min)		Tangential Force (N)		Input Current (A)		Power Input (W)	Power Output (W)	Internal Rotary Switch No.		External input voltage (V)
No-load	Rated	Rated	Starting	No-load	Starting			SW1#5	SW5	
16.9	14.6	119		0.8		45	67	9	9.6~9.9	344
15.5	14.6	119		0.7		45	67	8	9.1~9.4	
14.8	14.6	119		0.7		45	67	7	8.6~8.9	
14.1	14.1	120		0.6		43	67	6	8.1~8.4	
13.4	13.4	120		0.6		41	65	5	7.6~7.9	
12.7	12.7	121		0.6		39	64	4	7.1~7.4	
11.2	11.2	123		0.5		35	60	3	6.6~6.9	
10.5	10.5	123		0.5		32	56	2	6.1~6.4	
9.8	9.8	124		0.5		30	53	1	5.6~5.9	
9.1	9.1	125		0.5	4.0	28	52	0	5.1~5.4	
8.4	8.4	125		0.4		26	50	9	4.6~4.9	
7.7	7.7	126		0.4		24	48	8	4.1~4.4	
7.0	7.0	127		0.4		22	44	7	3.6~3.9	
6.3	6.3	128		0.4		20	41	6	3.1~3.4	
5.6	5.6	129		0.3		17	38	5	2.6~2.9	
4.9	4.9	129		0.3		15	37	4	2.1~2.4	
4.2	4.2	130		0.3		13	34	3	1.6~1.9	
3.5	3.5	131		0.2		11	31	2	1.1~1.4	
2.8	2.8	131		0.2		9	27	1	0.6~0.9	
2.1	2.1	132		0.2		7	25	0	0.1~0.4	

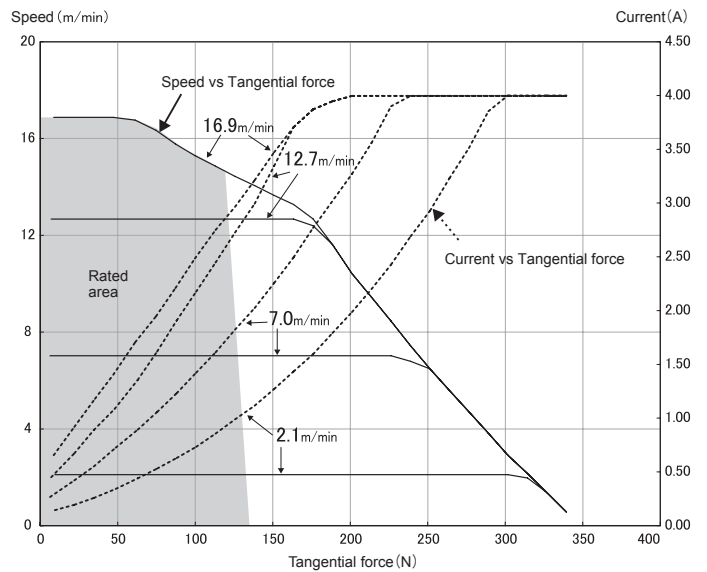

### PM486FE-60

Speed (m/min)		Tangential Force (N)		Input Current (A)		Power Input (W)	Power Output (W)	Internal Rotary Switch No.		External input voltage (V)
No-load	Rated	Rated	Starting	No-load	Starting			SW1#5	SW5	
60.0	52.0	38		0.8		45	67	9	9.6~9.9	110
55.0	52.0	38		0.7		45	67	8	9.1~9.4	
52.5	52.0	38		0.7		45	67	7	8.6~8.9	
50.0	50.0	38		0.6		43	67	6	8.1~8.4	
47.5	47.5	38		0.6		41	65	5	7.6~7.9	
45.0	45.0	39		0.6		39	64	4	7.1~7.4	
40.0	40.0	39		0.5		35	60	3	6.6~6.9	
37.5	37.5	39		0.5		32	56	2	6.1~6.4	
35.0	35.0	40		0.5	4.0	30	53	1	5.6~5.9	
32.5	32.5	40		0.5		28	52	0	5.1~5.4	
30.0	30.0	40		0.4		26	50	9	4.6~4.9	
27.5	27.5	40		0.4		24	48	8	4.1~4.4	
25.0	25.0	41		0.4		22	44	7	3.6~3.9	
22.5	22.5	41		0.4		20	41	6	3.1~3.4	
20.0	20.0	41		0.3		17	38	5	2.6~2.9	
17.5	17.5	41		0.3		15	37	4	2.1~2.4	
15.0	15.0	42		0.3		13	34	3	1.6~1.9	
12.5	12.5	42		0.2		11	31	2	1.1~1.4	
10.0	10.0	42		0.2		9	28	1	0.6~0.9	
7.5	7.5	42		0.2		7	25	0	0.1~0.4	

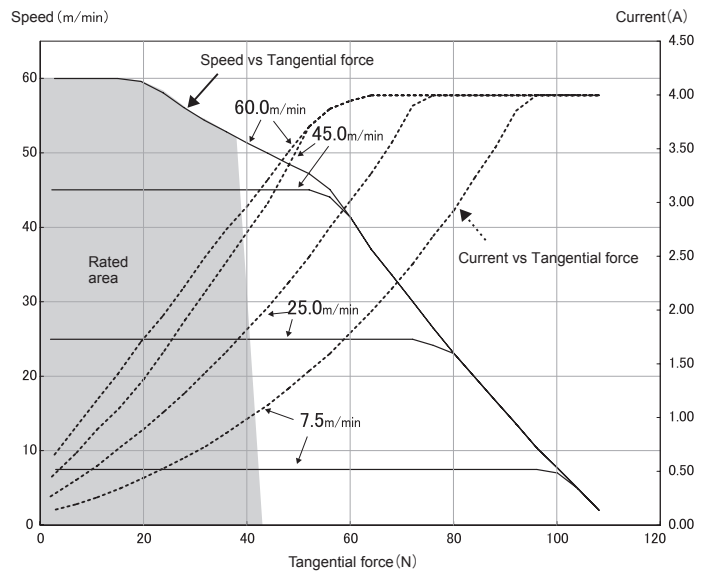

### PM486FE-210

Speed (m/min)		Tangential Force (N)		Input Current (A)		Power Input (W)	Power Output (W)	Internal Rotary Switch No.		External input voltage (V)
No-load	Rated	Rated	Starting	No-load	Starting			SW1#5	SW5	
213.3	184.9	12		0.8		45	67	9	9.6~9.9	35
195.6	184.9	12		0.7		45	67	8	9.1~9.4	
186.7	184.9	12		0.7		45	67	7	8.6~8.9	
177.8	177.8	12		0.6		43	67	6	8.1~8.4	
168.9	168.9	12		0.6		41	65	5	7.6~7.9	
160.0	160.0	12		0.6		39	64	4	7.1~7.4	
142.2	142.2	13		0.5		35	60	3	6.6~6.9	
133.3	133.3	13		0.5		32	56	2	6.1~6.4	
124.4	124.4	13		0.5		30	53	1	5.6~5.9	
115.6	115.6	13		0.5	4.0	28	52	0	5.1~5.4	
106.7	106.7	13		0.4		26	50	9	4.6~4.9	
97.8	97.8	13		0.4		24	48	8	4.1~4.4	
88.9	88.9	13		0.4		22	44	7	3.6~3.9	
80.0	80.0	13		0.4		20	41	6	3.1~3.4	
71.1	71.1	13		0.3		17	38	5	2.6~2.9	
62.2	62.2	13		0.3		15	37	4	2.1~2.4	
53.3	53.3	13		0.3		13	34	3	1.6~1.9	
44.4	44.4	13		0.2		11	31	2	1.1~1.4	
35.6	35.6	13		0.2		9	28	1	0.6~0.9	
26.7	26.7	14		0.2		7	25	0	0.1~0.4	

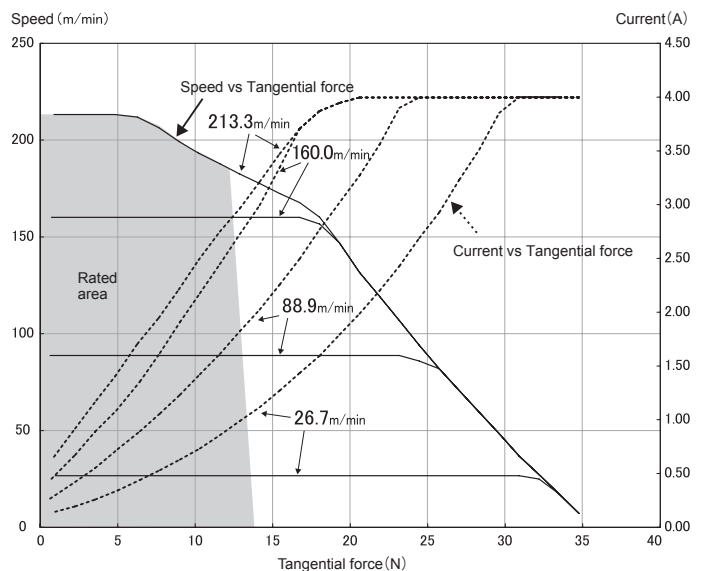

\*The values in the characteristics list are only for your reference and not the warranted values. The values represent the characteristics of a single standard motor roller (no linked operation) without including other specifications, and the values may change when including other characteristics or with linked operation.

 [MDR Selection Tool] is available on our web page.

## Operating characteristics with HB-510N driver card

### PM486FE-17

Speed (m/min)		Tangential Force (N)		Input Current (A)		Power Input (W)	Power Output (W)	Rotary SW No	External input voltage (V)
No-load	Rated	Rated	Starting	No-load	Starting				
16.9	15.2	103		0.8		42	62	9	9.3~9.7
15.5	15.2	103		0.7		42	62	8	8.3~8.7
14.1	14.1	104		0.6		39	60	7	7.3~7.7
12.7	12.7	106		0.6		35	56	6	6.3~6.7
11.2	11.2	107		0.5		31	51	5	5.3~5.7
9.8	9.8	109		0.5		27	47	4	4.3~4.7
8.4	8.4	110		0.4		23	43	3	3.3~3.7
7.0	7.0	111		0.4		19	38	2	2.3~2.7
5.6	5.6	113		0.3		16	34	1	1.3~1.7
4.2	4.2	115		0.3		12	29	0	0.3~0.7

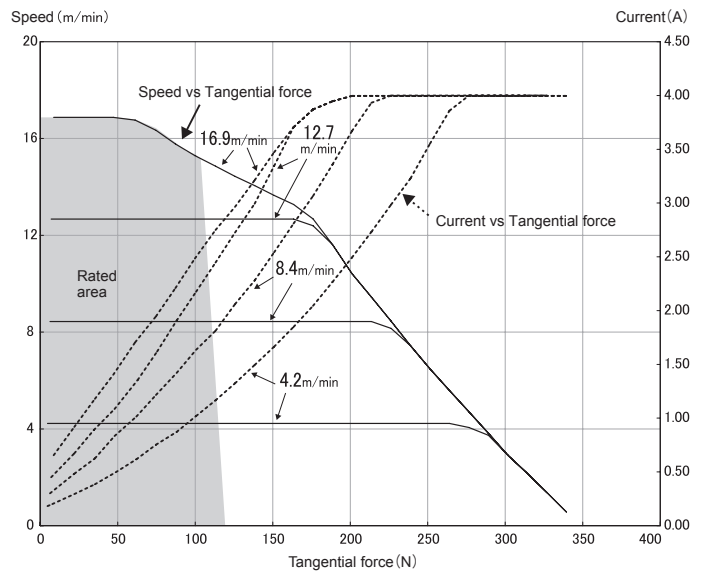

### PM486FE-60

Speed (m/min)		Tangential Force (N)		Input Current (A)		Power Input (W)	Power Output (W)	Rotary SW No	External input voltage (V)
No-load	Rated	Rated	Starting	No-load	Starting				
60.0	54.0	33		0.8		42	62	9	9.3~9.7
55.0	54.0	33		0.7		42	62	8	8.3~8.7
50.0	50.0	33		0.6		39	60	7	7.3~7.7
45.0	45.0	34		0.6		35	56	6	6.3~6.7
40.0	40.0	34		0.5		31	51	5	5.3~5.7
35.0	35.0	35		0.5		27	47	4	4.3~4.7
30.0	30.0	35		0.4		23	43	3	3.3~3.7
25.0	25.0	36		0.4		19	38	2	2.3~2.7
20.0	20.0	36		0.3		16	34	1	1.3~1.7
15.0	15.0	37		0.3		12	29	0	0.3~0.7

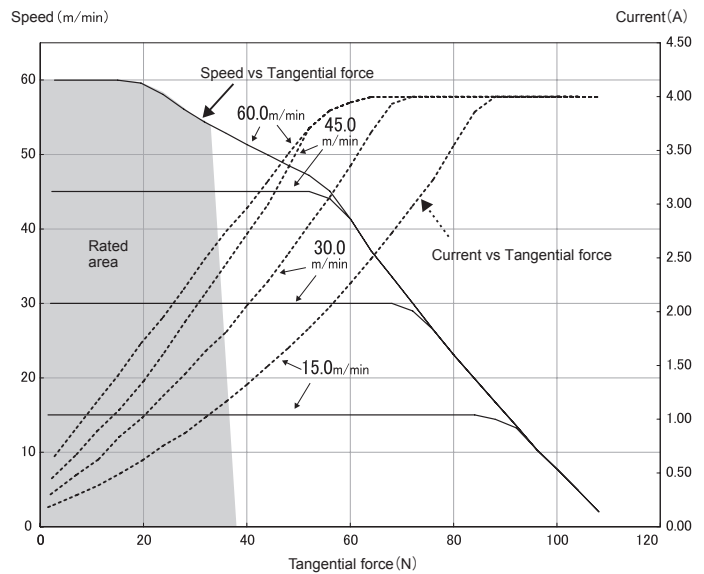

### PM486FE-210

Speed (m/min)		Tangential Force (N)		Input Current (A)		Power Input (W)	Power Output (W)	Rotary SW No	External input voltage (V)
No-load	Rated	Rated	Starting	No-load	Starting				
213.3	192.0	11		0.8		42	62	9	9.3~9.7
195.6	192.0	11		0.7		42	62	8	8.3~8.7
177.8	177.8	11		0.6		39	60	7	7.3~7.7
160.0	160.0	11		0.6		35	56	6	6.3~6.7
142.2	142.2	11		0.5		31	51	5	5.3~5.7
124.4	124.4	11		0.5		27	47	4	4.3~4.7
106.7	106.7	11		0.4		23	43	3	3.3~3.7
88.9	88.9	11		0.4		19	38	2	2.3~2.7
71.1	71.1	12		0.3		16	34	1	1.3~1.7
53.3	53.3	12		0.3		12	29	0	0.3~0.7

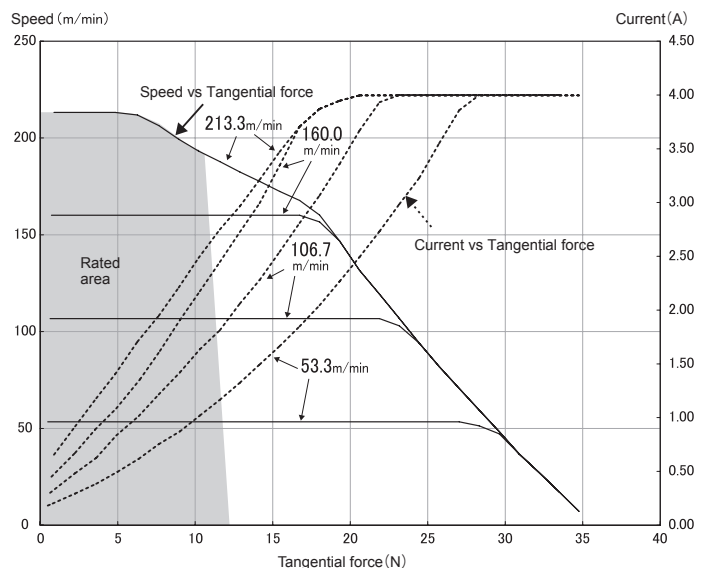

\*The values in the characteristics list are only for your reference and not the warranted values. The values represent the characteristics of a single standard motor roller (no linked operation) without including other specifications, and the values may change when including other specifications or with linked operation.



Minimum tube length



Spring loaded shaft

# MDR Brushless DC Motor standard type PM500FE

Roller diameter  $\varnothing 50$ 

## Roller diameter $\varnothing 50$ PM500FE

- Roller diameter /  $\varnothing 50$
- Thickness / t1.4
- Voltage / 24V DC
- Tube material / STKM12
- Surface treatment / Trivalent chromate processing

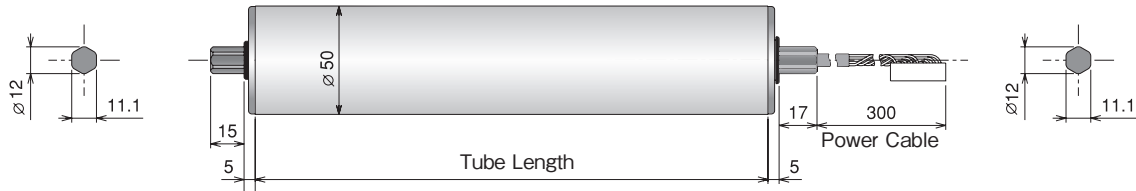

### Tube Length : PM500FE

	290mm	290mm $\leq$						
Tube Length (mm)	300	400	500	600	700	800	900	1000
Weight (kg)	2.4	2.5	2.7	2.8	3.0	3.1	3.3	3.4
Spring loaded shaft	<input type="checkbox"/>	<input type="checkbox"/>	<input type="checkbox"/>	<input type="checkbox"/>	<input type="checkbox"/>	<input type="checkbox"/>	<input type="checkbox"/>	<input type="checkbox"/>

- Conveyor frame inside dimension and frame hole shape vary by the manufacturer.
- A gap of 2-5mm is required between the frame inside dimension and Power Moller.

### Product Designation :

**PM500FE - 17 - 400 - D - 024 - BR**

Power Moller model: 17, Nominal Speed: 400, Tube Length: D, Voltage: 024, Options: BR

- Motor type : FE
- Nominal Speed : 17,60,210
- Tube Length : Specify in mm.
- Voltage : D-024 (24VDC)
- Options : Each of the following optional specification may be selected.

### Mounting Bracket : No.MBB-081

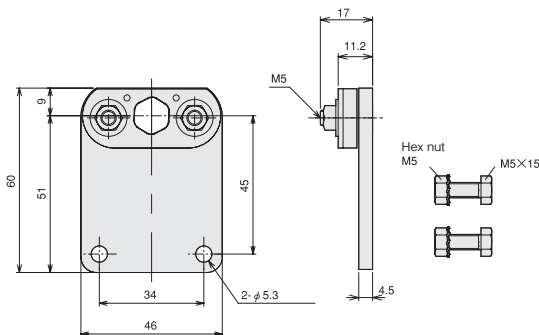

\*Attach to the power cable side.

- Apply 6~10Nm torque for securing the Power Moller mounting shaft, and 3.5Nm for securing the bracket.

### Options : PM500FE

	<b>Rubber Laggings - NR, UR, NB, CR</b> Natural rubber, Urethane, NBR, Neoprene	P.66
	<b>BR Built-In Brake - BR<sup>*1</sup></b> 360mm  360mm $\leq$	P.67
	<b>VG Poly V-Belt Pulley</b> 290mm  290mm $\leq$	P.70
	<b>VP V-Belt Pulley</b> 290mm  290mm $\leq$	P.71
	<b>P2 Double Grooved Tube<sup>**2</sup></b> 340mm  340mm $\leq$	P.72

**JD**

### Both-end D-shaped shaft

\*1 When holding type built-in brake is required, specify along with a driver card compatible with such brake specification.

[Electric brake (no holding function)] is included in the standard specification.

\*\*2 Up to 800mm can be produced.

- For other specification, refer to P.73.

# MDR Brushless DC Motor standard type PM500FE

Roller diameter  $\varnothing 50$

 [MDR Selection Tool] is available on our web page.

## Operating characteristics with CB-016N6 driver card

### PM500FE-17

Speed (m/min)		Tangential Force (N)		Input Current (A)		Power Input (W)	Power Output (W)	Internal Rotary Switch No.		External input voltage (V)
No-load	Rated	Rated	Starting	No-load	Starting			SW1#5	SW5	
17.4	15.0	116		0.8		45	67	9	9.6~9.9	335
15.9	15.0	116		0.7		45	67	8	9.1~9.4	
15.2	15.0	116		0.7		45	67	7	8.6~8.9	
14.5	14.5	116		0.6		43	67	6	8.1~8.4	
13.7	13.7	117		0.6		41	65	5	7.6~7.9	
13.0	13.0	118		0.6		39	64	4	7.1~7.4	
11.6	11.6	119		0.5		35	60	3	6.6~6.9	
10.9	10.9	120		0.5		32	56	2	6.1~6.4	
10.1	10.1	120		0.5		30	53	1	5.6~5.9	
9.4	9.4	121		0.5		28	52	0	5.1~5.4	
8.7	8.7	122		0.4		26	50	9	4.6~4.9	
8.0	8.0	123		0.4		24	48	8	4.1~4.4	
7.2	7.2	123		0.4		22	44	7	3.6~3.9	
6.5	6.5	124		0.4		20	41	6	3.1~3.4	
5.8	5.8	125		0.3		17	38	5	2.6~2.9	
5.1	5.1	126		0.3		15	37	4	2.1~2.4	
4.3	4.3	127		0.3		13	34	3	1.6~1.9	
3.6	3.6	127		0.2		11	31	2	1.1~1.4	
2.9	2.9	128		0.2		9	28	1	0.6~0.9	
2.2	2.2	129		0.2		7	25	0	0.1~0.4	

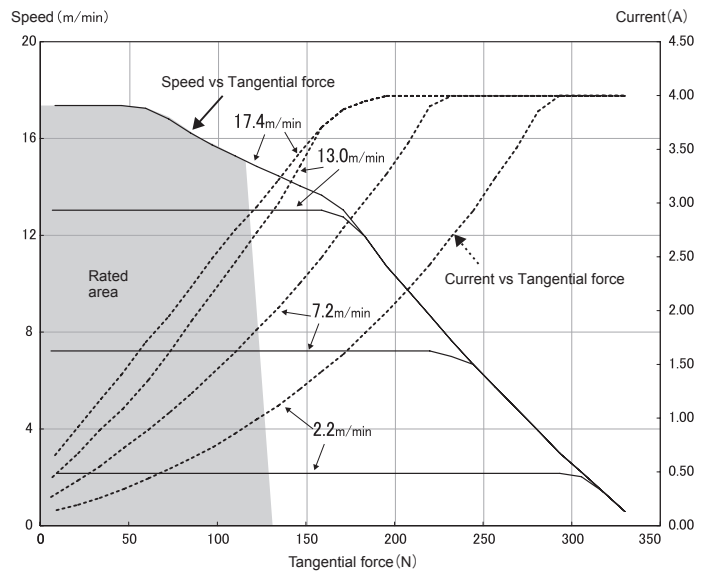

### PM500FE-60

Speed (m/min)		Tangential Force (N)		Input Current (A)		Power Input (W)	Power Output (W)	Internal Rotary Switch No.		External input voltage (V)
No-load	Rated	Rated	Starting	No-load	Starting			SW1#5	SW5	
61.7	53.5	37		0.8		45	67	9	9.6~9.9	107
56.6	53.5	37		0.7		45	67	8	9.1~9.4	
54.0	53.5	37		0.7		45	67	7	8.6~8.9	
51.4	51.4	37		0.6		43	67	6	8.1~8.4	
48.9	48.9	37		0.6		41	65	5	7.6~7.9	
46.3	46.3	38		0.6		39	64	4	7.1~7.4	
41.2	41.2	38		0.5		35	60	3	6.6~6.9	
38.6	38.6	38		0.5		32	56	2	6.1~6.4	
36.0	36.0	38		0.5		30	53	1	5.6~5.9	
33.4	33.4	39		0.5		28	52	0	5.1~5.4	
30.9	30.9	39		0.4		26	50	9	4.6~4.9	
28.3	28.3	39		0.4		24	48	8	4.1~4.4	
25.7	25.7	39		0.4		22	44	7	3.6~3.9	
23.1	23.1	40		0.4		20	41	6	3.1~3.4	
20.6	20.6	40		0.3		17	38	5	2.6~2.9	
18.0	18.0	40		0.3		15	37	4	2.1~2.4	
15.4	15.4	40		0.3		13	34	3	1.6~1.9	
12.9	12.9	41		0.2		11	31	2	1.1~1.4	
10.3	10.3	41		0.2		9	28	1	0.6~0.9	
7.7	7.7	41		0.2		7	25	0	0.1~0.4	

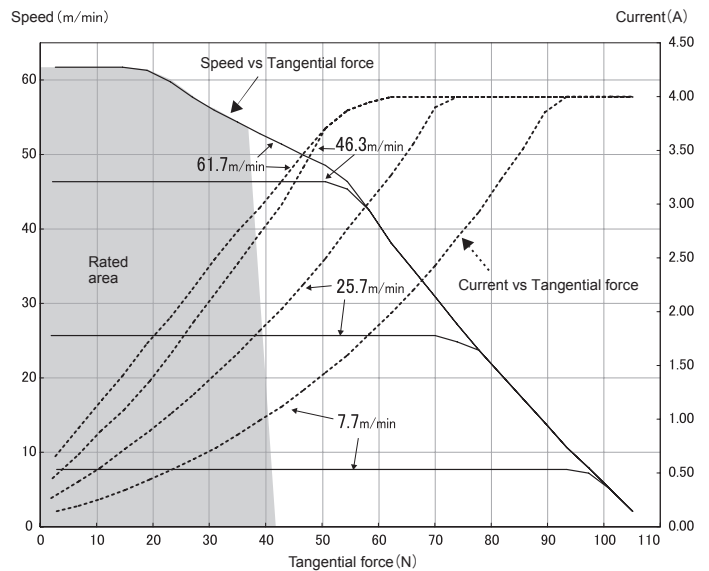

### PM500FE-210

Speed (m/min)		Tangential Force (N)		Input Current (A)		Power Input (W)	Power Output (W)	Internal Rotary Switch No.		External input voltage (V)
No-load	Rated	Rated	Starting	No-load	Starting			SW1#5	SW5	
219.5	190.2	12		0.8		45	67	9	9.6~9.9	34
201.2	190.2	12		0.7		45	67	8	9.1~9.4	
192.0	190.2	12		0.7		45	67	7	8.6~8.9	
182.9	182.9	12		0.6		43	67	6	8.1~8.4	
173.8	173.8	12		0.6		41	65	5	7.6~7.9	
164.6	164.6	12		0.6		39	64	4	7.1~7.4	
146.3	146.3	12		0.5		35	60	3	6.6~6.9	
137.2	137.2	12		0.5		32	56	2	6.1~6.4	
128.0	128.0	12		0.5		30	53	1	5.6~5.9	
118.9	118.9	12		0.5		28	52	0	5.1~5.4	
109.7	109.7	12		0.4		26	50	9	4.6~4.9	
100.6	100.6	13		0.4		24	48	8	4.1~4.4	
91.5	91.5	13		0.4		22	44	7	3.6~3.9	
82.3	82.3	13		0.4		20	41	6	3.1~3.4	
73.2	73.2	13		0.3		17	38	5	2.6~2.9	
64.0	64.0	13		0.3		15	37	4	2.1~2.4	
54.9	54.9	13		0.3		13	34	3	1.6~1.9	
45.7	45.7	13		0.2		11	31	2	1.1~1.4	
36.6	36.6	13		0.2		9	28	1	0.6~0.9	
27.4	27.4	13		0.2		7	25	0	0.1~0.4	

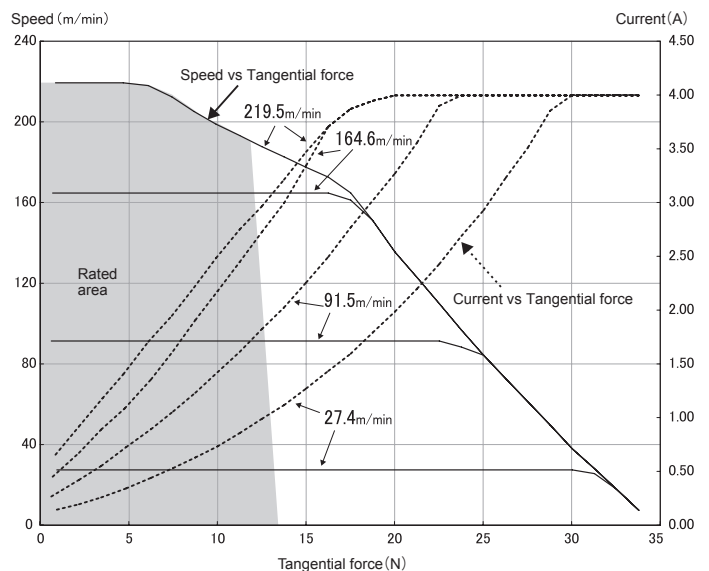

\*The values in the characteristics list are only for your reference and not the warranted values. The values represent the characteristics of a single standard motor roller (no linked operation) without including other specifications, and the values may change when including other characteristics or with linked operation.

 [MDR Selection Tool] is available on our web page.

## Operating characteristics with HB-510N driver card

### PM500FE-17

Speed (m/min)		Tangential Force (N)		Input Current (A)		Power Input (W)	Power Output (W)	Rotary SW No	External input voltage (V)
No-load	Rated	Rated	Starting	No-load	Starting				
17.4	15.6	100		0.8		42	62	9	9.3~9.7
15.9	15.6	100		0.7		42	62	8	8.3~8.7
14.5	14.5	101		0.6		39	60	7	7.3~7.7
13.0	13.0	103		0.6		35	56	6	6.3~6.7
11.6	11.6	104		0.5		31	51	5	5.3~5.7
10.1	10.1	106		0.5		27	47	4	4.3~4.7
8.7	8.7	107		0.4		23	43	3	3.3~3.7
7.2	7.2	108		0.4		19	38	2	2.3~2.7
5.8	5.8	110		0.3		16	34	1	1.3~1.7
4.3	4.3	111		0.3		12	29	0	0.3~0.7

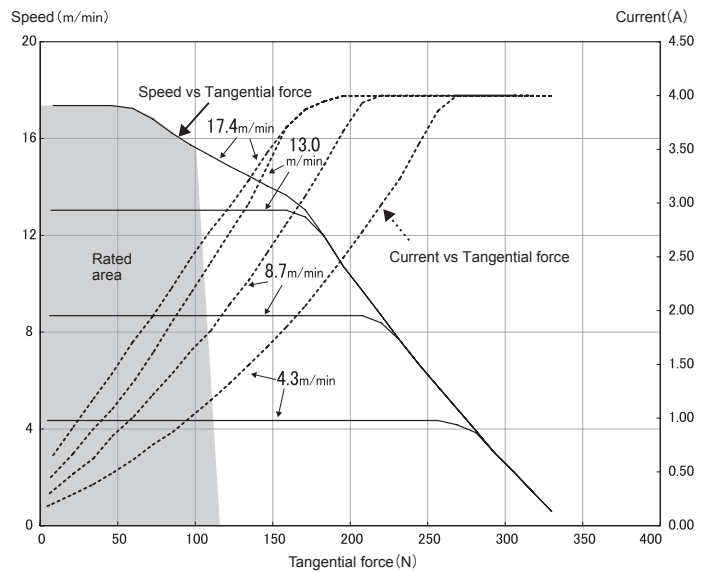

### PM500FE-60

Speed (m/min)		Tangential Force (N)		Input Current (A)		Power Input (W)	Power Output (W)	Rotary SW No	External input voltage (V)
No-load	Rated	Rated	Starting	No-load	Starting				
61.7	55.6	32		0.8		42	62	9	9.3~9.7
56.6	55.6	32		0.7		42	62	8	8.3~8.7
51.4	51.4	32		0.6		39	60	7	7.3~7.7
46.3	46.3	33		0.6		35	56	6	6.3~6.7
41.2	41.2	33		0.5		31	51	5	5.3~5.7
36.0	36.0	34		0.5		27	47	4	4.3~4.7
30.9	30.9	34		0.4		23	43	3	3.3~3.7
25.7	25.7	35		0.4		19	38	2	2.3~2.7
20.6	20.6	35		0.3		16	34	1	1.3~1.7
15.4	15.4	36		0.3		12	29	0	0.3~0.7

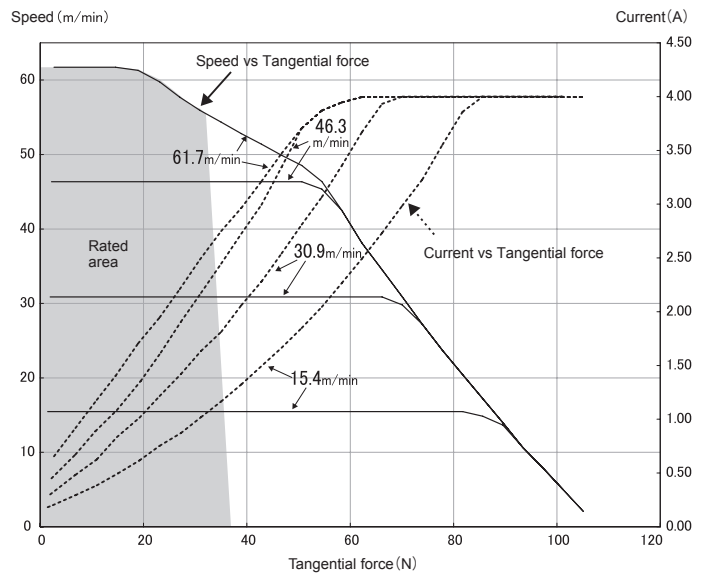

### PM500FE-210

Speed (m/min)		Tangential Force (N)		Input Current (A)		Power Input (W)	Power Output (W)	Rotary SW No	External input voltage (V)
No-load	Rated	Rated	Starting	No-load	Starting				
219.5	197.5	10		0.8		42	62	9	9.3~9.7
201.2	197.5	10		0.7		42	62	8	8.3~8.7
182.9	182.9	10		0.6		39	60	7	7.3~7.7
164.6	164.6	10		0.6		35	56	6	6.3~6.7
146.3	146.3	11		0.5		31	51	5	5.3~5.7
128.0	128.0	11		0.5		27	47	4	4.3~4.7
109.7	109.7	11		0.4		23	43	3	3.3~3.7
91.5	91.5	11		0.4		19	38	2	2.3~2.7
73.2	73.2	11		0.3		16	34	1	1.3~1.7
54.9	54.9	11		0.3		12	29	0	0.3~0.7

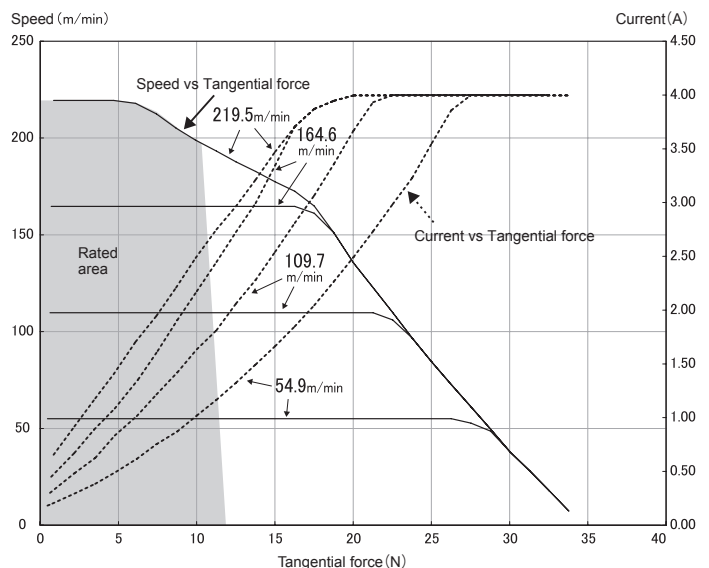

\*The values in the characteristics list are only for your reference and not the warranted values. The values represent the characteristics of a single standard motor roller (no linked operation) without including other specifications, and the values may change when including other specifications or with linked operation.





Minimum tube length



Spring loaded shaft

# MDR Brushless DC Motor standard type PM570FE

Roller diameter  $\varnothing 57$ 

## Roller diameter $\varnothing 57$ PM570FE

- Roller diameter /  $\varnothing 57$
- Thickness / t1.5
- Voltage / 24V DC
- Tube material / STKM12
- Surface treatment / Trivalent chromate processing

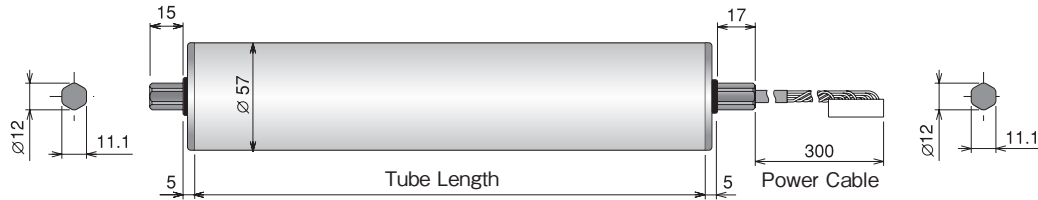

### Tube Length : PM570FE

	300mm	300mm $\leq$						
Tube Length (mm)	300	400	500	600	700	800	900	1000
Weight (kg)	2.8	3.0	3.2	3.4	3.6	3.8	4.0	4.2
Spring loaded shaft	<input type="checkbox"/>	<input type="checkbox"/>	<input type="checkbox"/>	<input type="checkbox"/>	<input type="checkbox"/>	<input type="checkbox"/>	<input type="checkbox"/>	<input type="checkbox"/>

- Conveyor frame inside dimension and frame hole shape vary by the manufacturer.
- A gap of 2-5mm is required between the frame inside dimension and Power Moller.

### Product Designation :

**PM570FE - 17 - 400 - D - 024 - BR**

Power Moller model    Nominal Speed    Tube Length    Voltage    Options

- Motor type : FE
- Nominal Speed : 17,60,210
- Tube Length : Specify in mm.
- Voltage : D-024 (24VDC)
- Options : Each of the following optional specification may be selected.

### Mounting Bracket : No.MBB-081

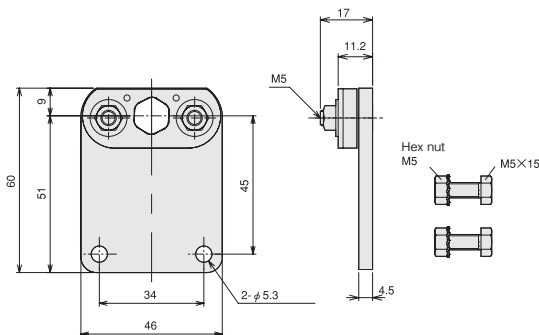

\*Attach to the power cable side.

- Apply 6-10Nm torque for securing the Power Moller mounting shaft, and 3.5Nm for securing the bracket.

### Options : PM570FE

	<b>Rubber Laggings - NR, UR, NB, CR</b> Natural rubber, Urethane, NBR, Neoprene	P.66
	<b>BR Built-In Brake - BR<sup>*1</sup></b> 370mm     370mm $\leq$	P.67
	<b>VG Poly V-Belt Pulley</b> 300mm     300mm $\leq$	P.70
	<b>VP V-Belt Pulley</b> 300mm     300mm $\leq$	P.71
	<b>P2 Double Grooved Tube<sup>**2</sup></b> 360mm     360mm $\leq$	P.72

**JD**

### Both-end D-shaped shaft

\*1 When holding type built-in brake is required, specify along with a driver card compatible with such brake specification.

[Electric brake (no holding function)] is included in the standard specification.

\*\*2 Up to 800mm can be produced.

- For other specification, refer to P.73.



 [MDR Selection Tool] is available on our web page.

## Operating characteristics with CB-016N6 driver card

### PM570FE-17

Speed (m/min)		Tangential Force (N)		Input Current (A)		Power Input (W)	Power Output (W)	Internal Rotary Switch No.		External input voltage (V)
No-load	Rated	Rated	Starting	No-load	Starting			SW1#5	SW5	
19.8	17.2	101		0.8		45	67	9	9.6~9.9	293
18.1	17.2	101		0.7		45	67	8	9.1~9.4	
17.3	17.2	101		0.7		45	67	7	8.6~8.9	
16.5	16.5	102		0.6		43	67	6	8.1~8.4	
15.7	15.7	102		0.6		41	65	5	7.6~7.9	
14.8	14.8	103		0.6		39	64	4	7.1~7.4	
13.2	13.2	105		0.5		35	60	3	6.6~6.9	
12.4	12.4	105		0.5		32	56	2	6.1~6.4	
11.5	11.5	106		0.5		30	53	1	5.6~5.9	
10.7	10.7	106		0.5	4.0	28	52	0	5.1~5.4	
9.9	9.9	107		0.4		26	50	9	4.6~4.9	
9.1	9.1	108		0.4		24	48	8	4.1~4.4	
8.2	8.2	108		0.4		22	44	7	3.6~3.9	
7.4	7.4	109		0.4		20	41	6	3.1~3.4	
6.6	6.6	110		0.3		17	38	5	2.6~2.9	
5.8	5.8	110		0.3		15	37	4	2.1~2.4	
4.9	4.9	111		0.3		13	34	3	1.6~1.9	
4.1	4.1	112		0.2		11	31	2	1.1~1.4	
3.3	3.3	112		0.2		9	28	1	0.6~0.9	
2.5	2.5	113		0.2		7	25	0	0.1~0.4	

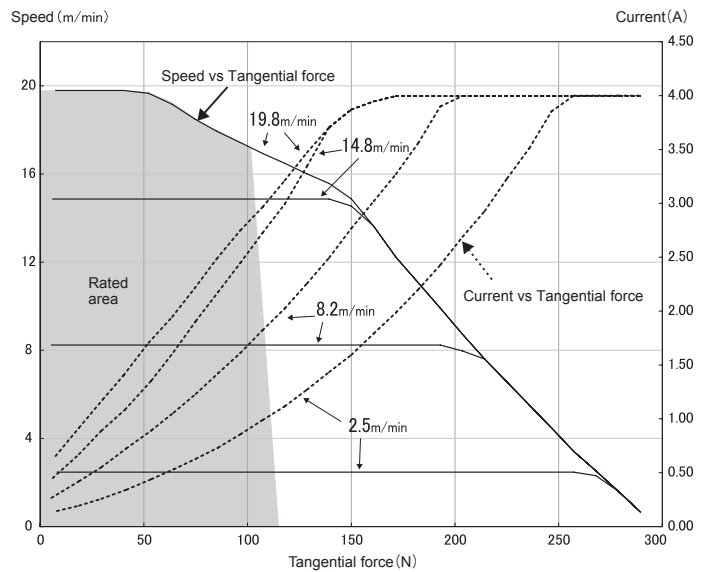

### PM570FE-60

Speed (m/min)		Tangential Force (N)		Input Current (A)		Power Input (W)	Power Output (W)	Internal Rotary Switch No.		External input voltage (V)
No-load	Rated	Rated	Starting	No-load	Starting			SW1#5	SW5	
70.4	61.0	32		0.8		45	67	9	9.6~9.9	94
64.5	61.0	32		0.7		45	67	8	9.1~9.4	
61.6	61.0	32		0.7		45	67	7	8.6~8.9	
58.6	58.6	33		0.6		43	67	6	8.1~8.4	
55.7	55.7	33		0.6		41	65	5	7.6~7.9	
52.8	52.8	33		0.6		39	64	4	7.1~7.4	
46.9	46.9	33		0.5		35	60	3	6.6~6.9	
44.0	44.0	34		0.5		32	56	2	6.1~6.4	
41.0	41.0	34		0.5	4.0	30	53	1	5.6~5.9	
38.1	38.1	34		0.5		28	52	0	5.1~5.4	
35.2	35.2	34		0.4		26	50	9	4.6~4.9	
32.3	32.3	34		0.4		24	48	8	4.1~4.4	
29.3	29.3	35		0.4		22	44	7	3.6~3.9	
26.4	26.4	35		0.4		20	41	6	3.1~3.4	
23.5	23.5	35		0.3		17	38	5	2.6~2.9	
20.5	20.5	35		0.3		15	37	4	2.1~2.4	
17.6	17.6	35		0.3		13	34	3	1.6~1.9	
14.7	14.7	36		0.2		11	31	2	1.1~1.4	
11.7	11.7	36		0.2		9	28	1	0.6~0.9	
8.8	8.8	36		0.2		7	25	0	0.1~0.4	

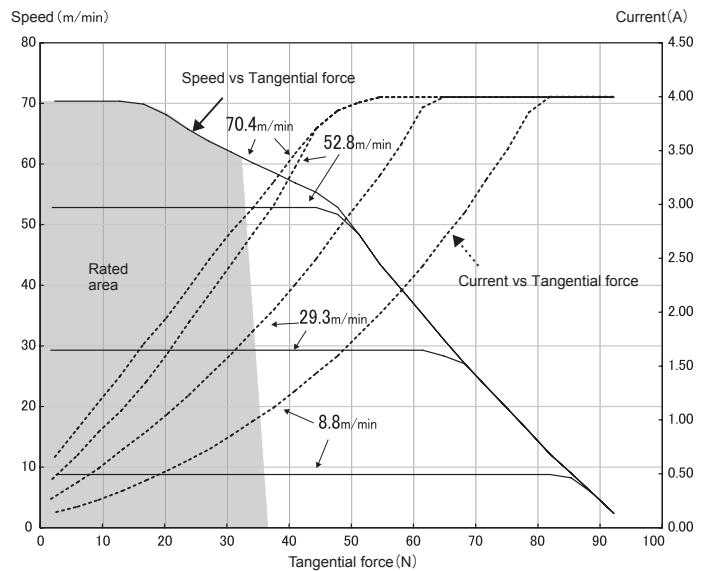

### PM570FE-210

Speed (m/min)		Tangential Force (N)		Input Current (A)		Power Input (W)	Power Output (W)	Internal Rotary Switch No.		External input voltage (V)
No-load	Rated	Rated	Starting	No-load	Starting			SW1#5	SW5	
250.2	216.8	10		0.8		45	67	9	9.6~9.9	30
229.4	216.8	10		0.7		45	67	8	9.1~9.4	
218.9	216.8	10		0.7		45	67	7	8.6~8.9	
208.5	208.5	10		0.6		43	67	6	8.1~8.4	
198.1	198.1	10		0.6		41	65	5	7.6~7.9	
187.7	187.7	11		0.6		39	64	4	7.1~7.4	
166.8	166.8	11		0.5		35	60	3	6.6~6.9	
156.4	156.4	11		0.5		32	56	2	6.1~6.4	
146.0	146.0	11		0.5		30	53	1	5.6~5.9	
135.5	135.5	11		0.5	4.0	28	52	0	5.1~5.4	
125.1	125.1	11		0.4		26	50	9	4.6~4.9	
114.7	114.7	11		0.4		24	48	8	4.1~4.4	
104.3	104.3	11		0.4		22	44	7	3.6~3.9	
93.8	93.8	11		0.4		20	41	6	3.1~3.4	
83.4	83.4	11		0.3		17	38	5	2.6~2.9	
73.0	73.0	11		0.3		15	37	4	2.1~2.4	
62.6	62.6	11		0.3		13	34	3	1.6~1.9	
52.1	52.1	11		0.2		11	31	2	1.1~1.4	
41.7	41.7	11		0.2		9	28	1	0.6~0.9	
31.3	31.3	12		0.2		7	25	0	0.1~0.4	

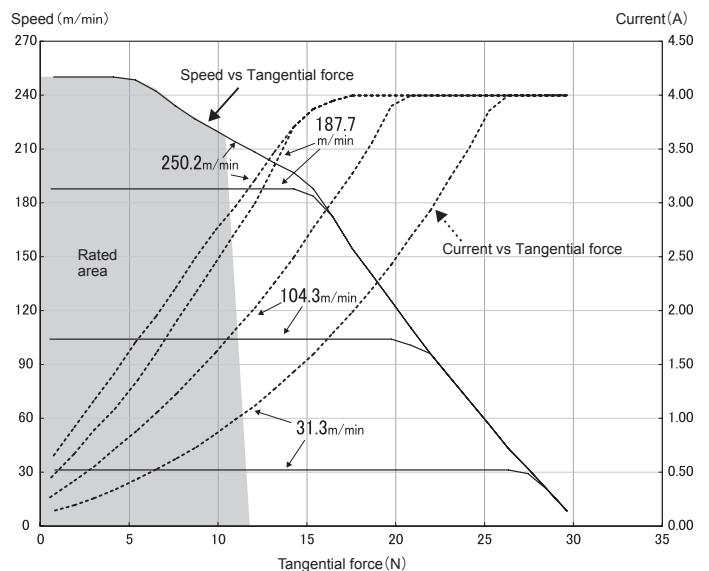

\*The values in the characteristics list are only for your reference and not the warranted values. The values represent the characteristics of a single standard motor roller (no linked operation) without including other specifications, and the values may change when including other specifications or with linked operation.

 [MDR Selection Tool] is available on our web page.

## Operating characteristics with HB-510N driver card

### PM570FE-17

Speed (m/min)		Tangential Force (N)		Input Current (A)		Power Input (W)	Power Output (W)	Rotary SW No	External input voltage (V)
No-load	Rated	Rated	Starting	No-load	Starting				
19.8	17.8	88	293	0.8	4.0	42	62	9	9.3~9.7
18.1	17.8	88		0.7		42	62	8	8.3~8.7
16.5	16.5	89		0.6		39	60	7	7.3~7.7
14.8	14.8	90		0.6		35	56	6	6.3~6.7
13.2	13.2	91		0.5		31	51	5	5.3~5.7
11.5	11.5	93		0.5		27	47	4	4.3~4.7
9.9	9.9	94		0.4		23	43	3	3.3~3.7
8.2	8.2	95		0.4		19	38	2	2.3~2.7
6.6	6.6	96		0.3		16	34	1	1.3~1.7
4.9	4.9	98		0.3		12	29	0	0.3~0.7

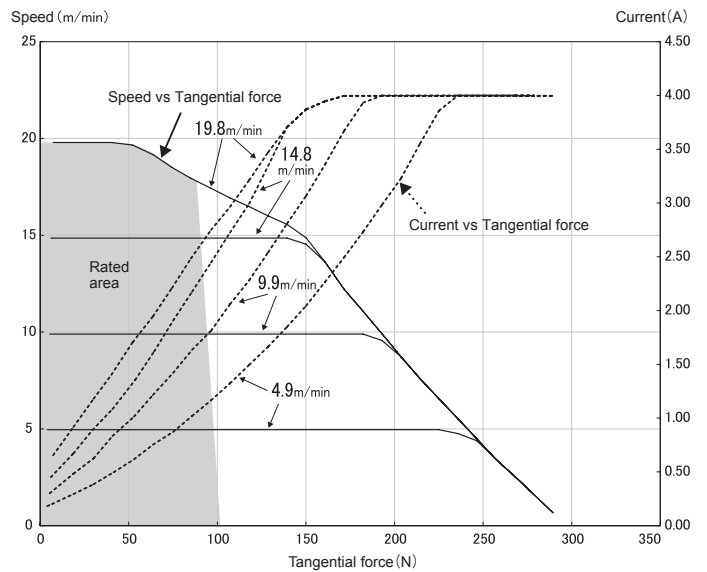

### PM570FE-60

Speed (m/min)		Tangential Force (N)		Input Current (A)		Power Input (W)	Power Output (W)	Rotary SW No	External input voltage (V)
No-load	Rated	Rated	Starting	No-load	Starting				
70.4	63.3	28	94	0.8	4.0	42	62	9	9.3~9.7
64.5	63.3	28		0.7		42	62	8	8.3~8.7
58.6	58.6	28		0.6		39	60	7	7.3~7.7
52.8	52.8	29		0.6		35	56	6	6.3~6.7
46.9	46.9	29		0.5		31	51	5	5.3~5.7
41.0	41.0	30		0.5		27	47	4	4.3~4.7
35.2	35.2	30		0.4		23	43	3	3.3~3.7
29.3	29.3	30		0.4		19	38	2	2.3~2.7
23.5	23.5	31		0.3		16	34	1	1.3~1.7
17.6	17.6	31		0.3		12	29	0	0.3~0.7

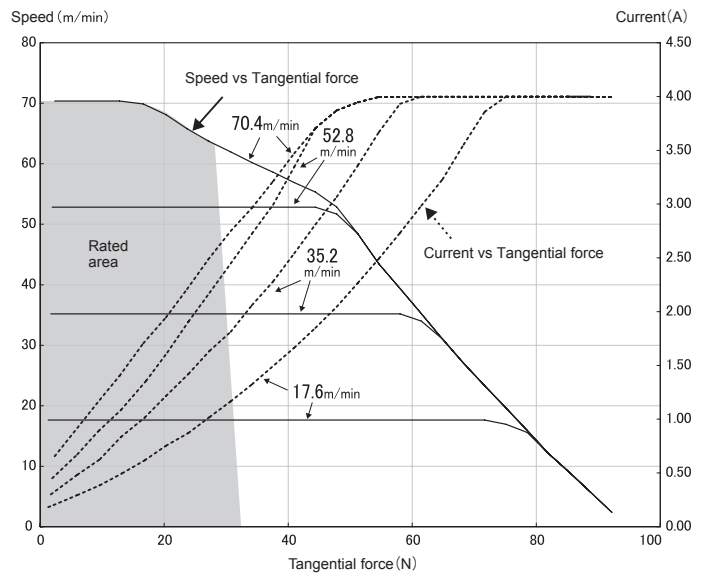

### PM570FE-210

Speed (m/min)		Tangential Force (N)		Input Current (A)		Power Input (W)	Power Output (W)	Rotary SW No	External input voltage (V)
No-load	Rated	Rated	Starting	No-load	Starting				
250.2	225.2	9	30	0.8	4.0	42	62	9	9.3~9.7
229.4	225.2	9		0.7		42	62	8	8.3~8.7
208.5	208.5	9		0.6		39	60	7	7.3~7.7
187.7	187.7	9		0.6		35	56	6	6.3~6.7
166.8	166.8	9		0.5		31	51	5	5.3~5.7
146.0	146.0	9		0.5		27	47	4	4.3~4.7
125.1	125.1	10		0.4		23	43	3	3.3~3.7
104.3	104.3	10		0.4		19	38	2	2.3~2.7
83.4	83.4	10		0.3		16	34	1	1.3~1.7
62.6	62.6	10		0.3		12	29	0	0.3~0.7

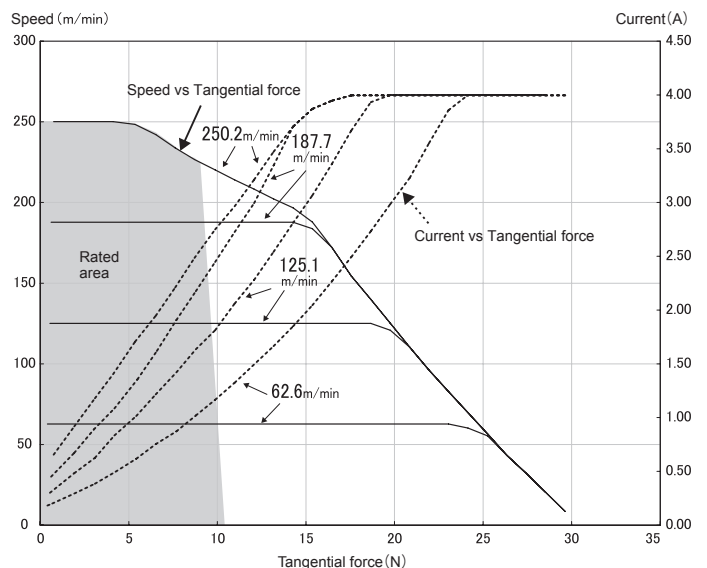

\*The values in the characteristics list are only for your reference and not the warranted values. The values represent the characteristics of a single standard motor roller (no linked operation) without including other specifications, and the values may change when including other specifications or with linked operation.



Minimum tube length



Spring loaded shaft

# MDR Brushless DC Motor standard type PM605FE

Roller diameter  $\varnothing 60.5$

## Roller diameter $\varnothing 60.5$ PM605FE

- Roller diameter /  $\varnothing 60.5$
- Thickness / t3.2
- Voltage / 24V DC
- Tube material / STKM12
- Surface treatment / Trivalent chromate processing

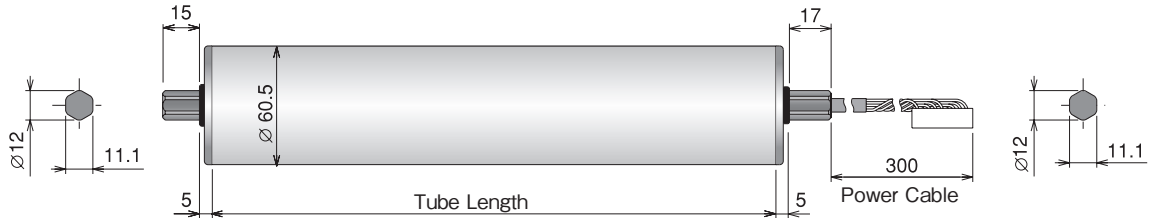

### Tube Length : PM605FE

	300mm		300mm $\leq$						
Tube Length (mm)	300	400	500	600	700	800	900	1000	
Weight (kg)	3.6	4.1	4.6	5.1	5.6	6.1	6.6	7.1	
Spring loaded shaft	<input type="checkbox"/>	<input type="checkbox"/>	<input type="checkbox"/>	<input type="checkbox"/>	<input type="checkbox"/>	<input type="checkbox"/>	<input type="checkbox"/>	<input type="checkbox"/>	

- Conveyor frame inside dimension and frame hole shape vary by the manufacturer.
- A gap of 2-5mm is required between the frame inside dimension and Power Moller.

### Product Designation :

**PM605FE - 17 - 400 - D - 024 - BR**

Power Moller model    Nominal Tube Speed Length    Voltage    Options

- Motor type : FE
- Nominal Speed : 17,60,210
- Tube Length : Specify in mm.
- Voltage : D-024 (24VDC)
- Options : Each of the following optional specification may be selected.

### Mounting Bracket : No.MBB-081

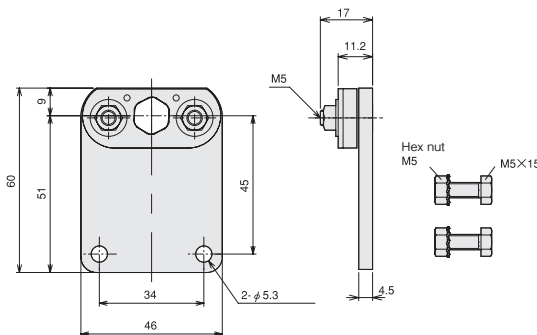

\*Attach to the power cable side.

- Apply 6-10Nm torque for securing the Power Moller mounting shaft, and 3.5Nm for securing the bracket.

### Options : PM605FE

	<b>Rubber Laggings - NR, UR, NB, CR</b> Natural rubber, Urethane, NBR, Neoprene	P.66
	<b>BR Built-In Brake - BR<sup>*1</sup></b> <input type="checkbox"/> 370mm <input type="checkbox"/> 370mm $\leq$	P.67
	<b>VG Poly V-Belt Pulley</b> <input type="checkbox"/> 300mm <input type="checkbox"/> 300mm $\leq$	P.70
	<b>VP V-Belt Pulley</b> <input type="checkbox"/> 300mm <input type="checkbox"/> 300mm $\leq$	P.71

**JD**

### Both-end D-shaped shaft

\*1 When holding type built-in brake is required, specify along with a driver card compatible with such brake specification.  
[Electric brake (no holding function)] is included in the standard specification.

- For other specification, refer to P.73.

# MDR Brushless DC Motor standard type PM605FE

Roller diameter  $\varnothing 60.5$

 [MDR Selection Tool] is available on our web page.

## Operating characteristics with CB-016N6 driver card

### PM605FE-17

Speed (m/min)		Tangential Force (N)		Input Current (A)		Power Input (W)	Power Output (W)	Internal Rotary Switch No.		External input voltage (V)
No-load	Rated	Rated	Starting	No-load	Starting			SW1#5	SW5	
21.0	18.2	96		0.8		45	67	9	9.6~9.9	276
19.3	18.2	96		0.7		45	67	8	9.1~9.4	
18.4	18.2	96		0.7		45	67	7	8.6~8.9	
17.5	17.5	96		0.6		43	67	6	8.1~8.4	
16.6	16.6	97		0.6		41	65	5	7.6~7.9	
15.8	15.8	97		0.6		39	64	4	7.1~7.4	
14.0	14.0	99		0.5		35	60	3	6.6~6.9	
13.1	13.1	99		0.5		32	56	2	6.1~6.4	
12.3	12.3	100		0.5		30	53	1	5.6~5.9	
11.4	11.4	100		0.5	4.0	28	52	0	5.1~5.4	
10.5	10.5	101		0.4		26	50	9	4.6~4.9	OFF
9.6	9.6	102		0.4		24	48	8	4.1~4.4	
8.8	8.8	102		0.4		22	44	7	3.6~3.9	
7.9	7.9	103		0.4		20	41	6	3.1~3.4	
7.0	7.0	103		0.3		17	38	5	2.6~2.9	
6.1	6.1	104		0.3		15	37	4	2.1~2.4	
5.3	5.3	105		0.3		13	34	3	1.6~1.9	
4.4	4.4	105		0.2		11	31	2	1.1~1.4	
3.5	3.5	106		0.2		9	28	1	0.6~0.9	
2.6	2.6	106		0.2		7	25	0	0.1~0.4	

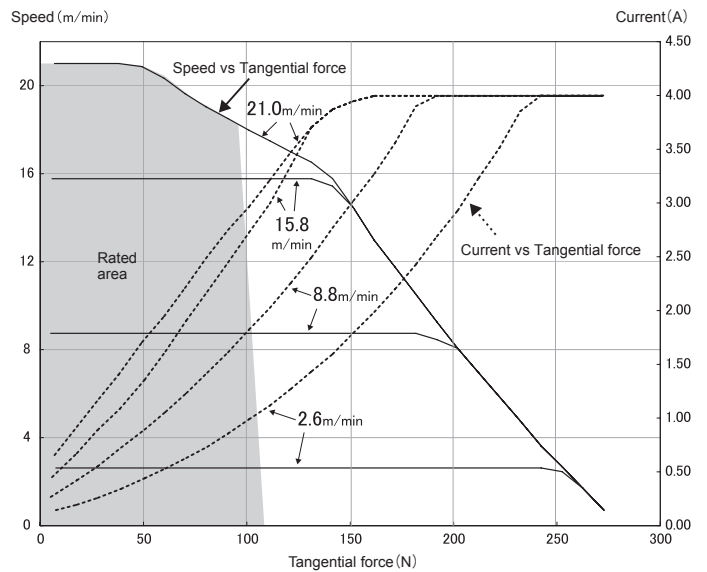

### PM605FE-60

Speed (m/min)		Tangential Force (N)		Input Current (A)		Power Input (W)	Power Output (W)	Internal Rotary Switch No.		External input voltage (V)
No-load	Rated	Rated	Starting	No-load	Starting			SW1#5	SW5	
74.7	64.7	31		0.8		45	67	9	9.6~9.9	88
68.5	64.7	31		0.7		45	67	8	9.1~9.4	
65.4	64.7	31		0.7		45	67	7	8.6~8.9	
62.2	62.2	31		0.6		43	67	6	8.1~8.4	
59.1	59.1	31		0.6		41	65	5	7.6~7.9	
56.0	56.0	31		0.6		39	64	4	7.1~7.4	
49.8	49.8	31		0.5		35	60	3	6.6~6.9	
46.7	46.7	32		0.5		32	56	2	6.1~6.4	
43.6	43.6	32		0.5		30	53	1	5.6~5.9	
40.5	40.5	32		0.4	4.0	28	52	0	5.1~5.4	
37.3	37.3	32		0.4		26	50	9	4.6~4.9	OFF
34.2	34.2	32		0.4		24	48	8	4.1~4.4	
31.1	31.1	33		0.4		22	44	7	3.6~3.9	
28.0	28.0	33		0.4		20	41	6	3.1~3.4	
24.9	24.9	33		0.3		17	38	5	2.6~2.9	
21.8	21.8	33		0.3		15	37	4	2.1~2.4	
18.7	18.7	33		0.3		13	34	3	1.6~1.9	
15.6	15.6	34		0.2		11	31	2	1.1~1.4	
12.4	12.4	34		0.2		9	28	1	0.6~0.9	
9.3	9.3	34		0.2		7	25	0	0.1~0.4	

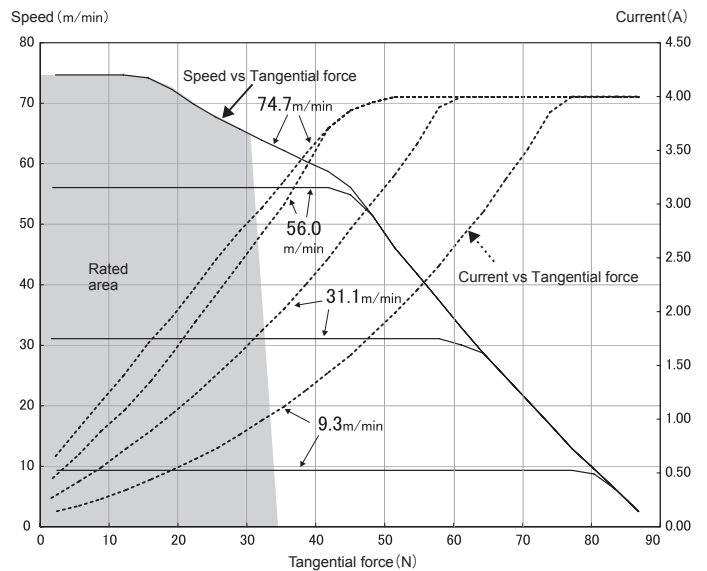

### PM605FE-210

Speed (m/min)		Tangential Force (N)		Input Current (A)		Power Input (W)	Power Output (W)	Internal Rotary Switch No.		External input voltage (V)
No-load	Rated	Rated	Starting	No-load	Starting			SW1#5	SW5	
265.6	230.2	10		0.8		45	67	9	9.6~9.9	28
243.4	230.2	10		0.7		45	67	8	9.1~9.4	
232.4	230.2	10		0.7		45	67	7	8.6~8.9	
221.3	221.3	10		0.6		43	67	6	8.1~8.4	
210.2	210.2	10		0.6		41	65	5	7.6~7.9	
199.2	199.2	10		0.6		39	64	4	7.1~7.4	
177.0	177.0	10		0.5		35	60	3	6.6~6.9	
166.0	166.0	10		0.5		32	56	2	6.1~6.4	
154.9	154.9	10		0.5		30	53	1	5.6~5.9	
143.9	143.9	10		0.5	4.0	28	52	0	5.1~5.4	
132.8	132.8	10		0.4		26	50	9	4.6~4.9	OFF
121.7	121.7	10		0.4		24	48	8	4.1~4.4	
110.7	110.7	10		0.4		22	44	7	3.6~3.9	
99.6	99.6	10		0.4		20	41	6	3.1~3.4	
88.5	88.5	11		0.3		17	38	5	2.6~2.9	
77.5	77.5	11		0.3		15	37	4	2.1~2.4	
66.4	66.4	11		0.3		13	34	3	1.6~1.9	
55.3	55.3	11		0.2		11	31	2	1.1~1.4	
44.3	44.3	11		0.2		9	28	1	0.6~0.9	
33.2	33.2	11		0.2		7	25	0	0.1~0.4	

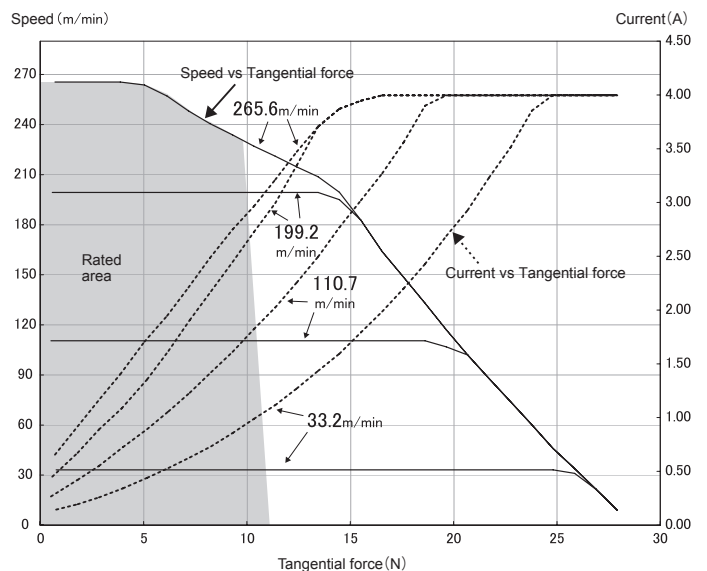

\*The values in the characteristics list are only for your reference and not the warranted values. The values represent the characteristics of a single standard motor roller (no linked operation) without including other specifications, and the values may change when including other specifications or with linked operation.

 [MDR Selection Tool] is available on our web page.

## Operating characteristics with HB-510N driver card

### PM605FE-17

Speed (m/min)		Tangential Force (N)		Input Current (A)		Power Input (W)	Power Output (W)	Rotary SW No	External input voltage (V)
No-load	Rated	Rated	Starting	No-load	Starting				
21.0	18.9	83	276	0.8	4.0	42	62	9	9.3~9.7
19.3	18.9	83		0.7		42	62	8	8.3~8.7
17.5	17.5	84		0.6		39	60	7	7.3~7.7
15.8	15.8	85		0.6		35	56	6	6.3~6.7
14.0	14.0	86		0.5		31	51	5	5.3~5.7
12.3	12.3	87		0.5		27	47	4	4.3~4.7
10.5	10.5	88		0.4		23	43	3	3.3~3.7
8.8	8.8	89		0.4		19	38	2	2.3~2.7
7.0	7.0	91		0.3		16	34	1	1.3~1.7
5.3	5.3	92		0.3		12	29	0	0.3~0.7

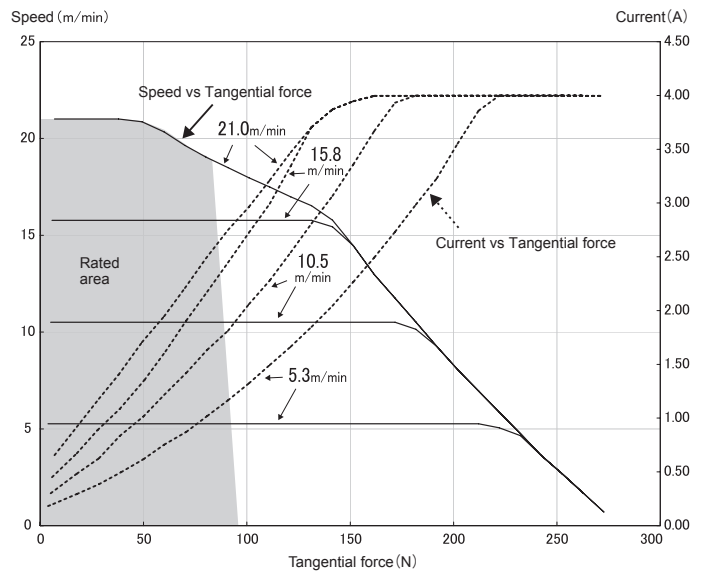

### PM605FE-60

Speed (m/min)		Tangential Force (N)		Input Current (A)		Power Input (W)	Power Output (W)	Rotary SW No	External input voltage (V)
No-load	Rated	Rated	Starting	No-load	Starting				
74.7	67.2	27	88	0.8	4.0	42	62	9	9.3~9.7
68.5	67.2	27		0.7		42	62	8	8.3~8.7
62.2	62.2	27		0.6		39	60	7	7.3~7.7
56.0	56.0	27		0.6		35	56	6	6.3~6.7
49.8	49.8	27		0.5		31	51	5	5.3~5.7
43.6	43.6	28		0.5		27	47	4	4.3~4.7
37.3	37.3	28		0.4		23	43	3	3.3~3.7
31.1	31.1	29		0.4		19	38	2	2.3~2.7
24.9	24.9	29		0.3		16	34	1	1.3~1.7
18.7	18.7	29		0.3		12	29	0	0.3~0.7

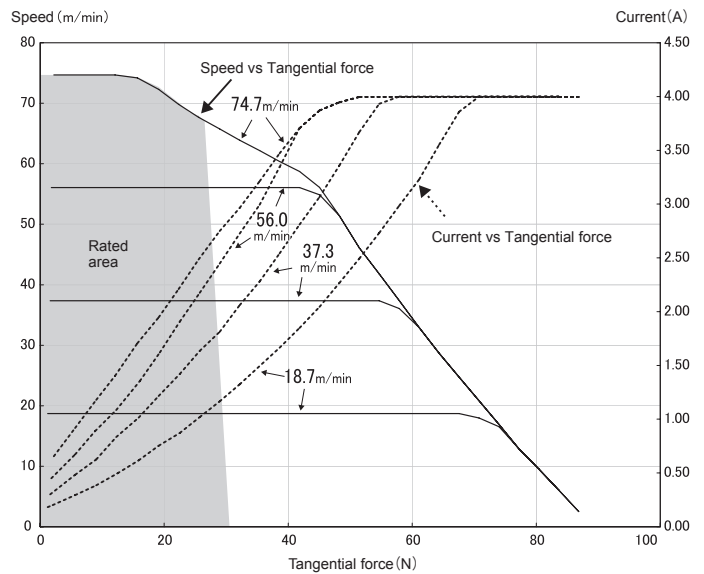

### PM605FE-210

Speed (m/min)		Tangential Force (N)		Input Current (A)		Power Input (W)	Power Output (W)	Rotary SW No	External input voltage (V)
No-load	Rated	Rated	Starting	No-load	Starting				
265.6	239.0	8	28	0.8	4.0	42	62	9	9.3~9.7
243.4	239.0	8		0.7		42	62	8	8.3~8.7
221.3	221.3	9		0.6		39	60	7	7.3~7.7
199.2	199.2	9		0.6		35	56	6	6.3~6.7
177.0	177.0	9		0.5		31	51	5	5.3~5.7
154.9	154.9	9		0.5		27	47	4	4.3~4.7
132.8	132.8	9		0.4		23	43	3	3.3~3.7
110.7	110.7	9		0.4		19	38	2	2.3~2.7
88.5	88.5	9		0.3		16	34	1	1.3~1.7
66.4	66.4	9		0.3		12	29	0	0.3~0.7

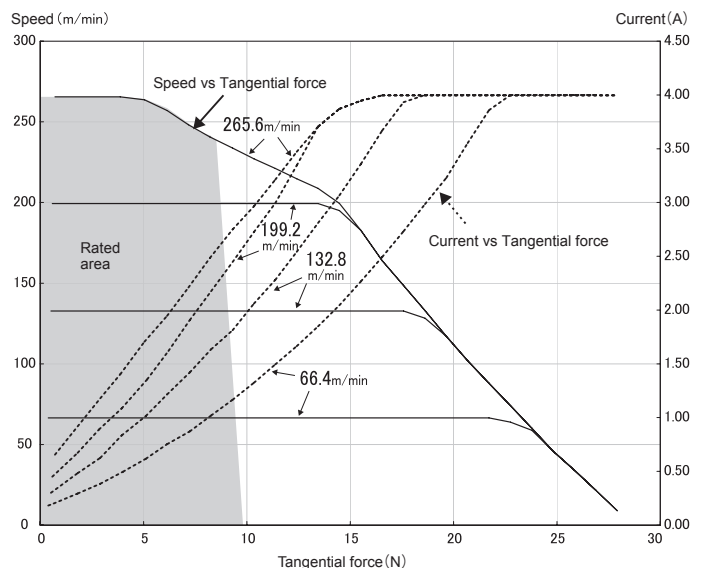

\*The values in the characteristics list are only for your reference and not the warranted values. The values represent the characteristics of a single standard motor roller (no linked operation) without including other specifications, and the values may change when including other specifications or with linked operation.



Minimum tube length



Spring loaded shaft

**MDR Brushless DC Motor High torque type PM500FP****Roller diameter  $\varnothing 50$** **Roller diameter  $\varnothing 50$   
PM500FP**

- Roller diameter /  $\varnothing 50$
- Thickness / t1.4
- Voltage / 24V DC
- Tube material / STKM12
- Surface treatment / Trivalent chromate processing

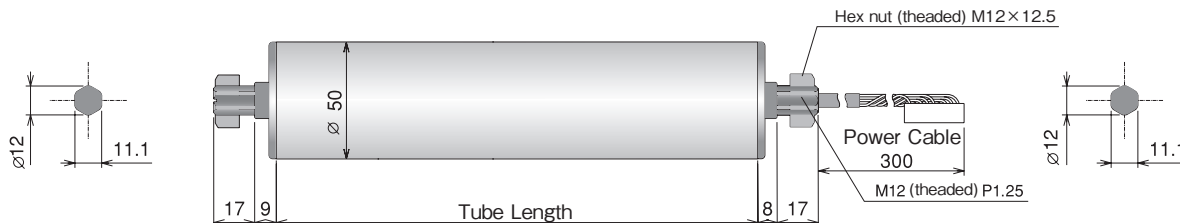
**Tube Length : PM500FP**

	370mm	370mm $\leq$					
Tube Length (mm)	400	500	600	700	800	900	1000
Weight (kg)	2.3	2.5	2.6	2.7	2.8	3.0	3.1
Spring loaded shaft	<input type="radio"/>	<input type="radio"/>	<input type="radio"/>	<input type="radio"/>	<input type="radio"/>	<input type="radio"/>	<input type="radio"/>

■ Conveyor frame inside dimension and frame hole shape vary by the manufacturer.

**Product Designation****PM500FP - 15 - 400 - D - 024 - BR**

Power Moller model    Nominal Speed    Tube Length    Voltage    Options

Motor type : FP

Nominal Speed : 15,55,255

Tube Length : Specify in mm.

Voltage : D-024 (24VDC)

Options : Each of the following optional specification may be selected.

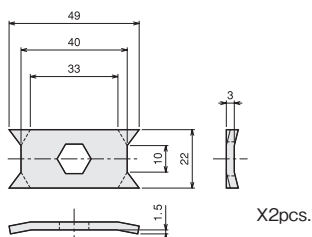
**Mounting Bracket :****No.P-0B1****Options : PM500FP****Rubber Laggings - NR, UR, NB, CR**

Natural rubber, Urethane, NBR, Neoprene

P.66

 **BR** **Built-In Brake - BR<sup>\*1</sup>**

440mm

 440mm  $\leq$ 

P.67

 **VP** **V-Belt Pulley**

370mm

 370mm  $\leq$ 

P.71

 **P2** **Double Grooved Tube<sup>\*\*2</sup>**

370mm

 370mm  $\leq$ 

P.72

<sup>\*1</sup> When holding type built-in brake is required, specify along with a driver card compatible with such brake specification.

[Electric brake (no holding function)] is included in the standard specification.

<sup>\*\*2</sup> Up to 800mm can be produced.

■ For other specification, refer to P.73.

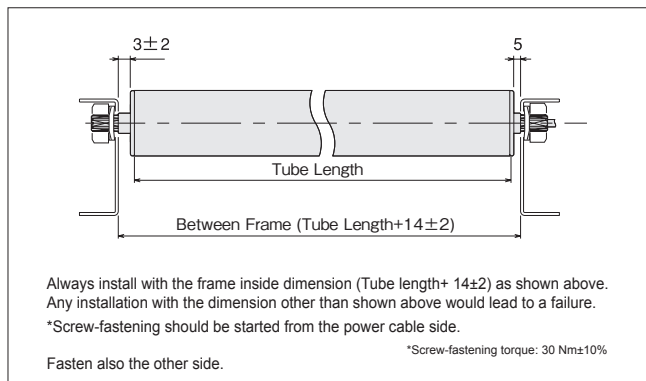



# MDR Brushless DC Motor High torque type PM500FP Roller diameter $\varnothing 50$

 [MDR Selection Tool] is available on our web page.

## Operating characteristics with CB-016N6 driver card

### PM500FP-15

Speed (m/min)		Tangential Force (N)		Input Current (A)		Power Input (W)	Power Output (W)	Internal Rotary Switch No.		External input voltage (V)
No-load	Rated	Rated	Starting	No-load	Starting			SW1#5	SW5	
17.8	14.6	158		0.9		60	84	9	9.6~9.9	4.0
16.3	14.6	158		0.8		60	84	8	9.1~9.4	
15.5	14.6	158		0.8		60	84	7	8.6~8.9	
14.8	14.6	158		0.8		60	84	6	8.1~8.4	
14.1	14.1	159		0.7		57	82	5	7.6~7.9	
13.3	13.3	160		0.7		54	78	4	7.1~7.4	
11.8	11.8	161		0.6		49	70	3	6.6~6.9	
11.1	11.1	161		0.6		45	68	2	6.1~6.4	
10.4	10.4	162		0.6		42	64	1	5.6~5.9	
9.6	9.6	163		0.5		39	61	0	5.1~5.4	
8.9	8.9	163		0.5		36	57	9	4.6~4.9	
8.1	8.1	164		0.5		33	53	8	4.1~4.4	
7.4	7.4	165		0.5		30	50	7	3.6~3.9	
6.6	6.6	165		0.4		27	47	6	3.1~3.4	
5.9	5.9	166		0.4		24	43	5	2.6~2.9	
5.2	5.2	167		0.4		21	40	4	2.1~2.4	
4.4	4.4	167		0.3		18	37	3	1.6~1.9	
3.7	3.7	168		0.3		15	32	2	1.1~1.4	
3.0	3.0	169		0.3		12	28	1	0.6~0.9	
2.2	2.2	169		0.2		9	25	0	0.1~0.4	

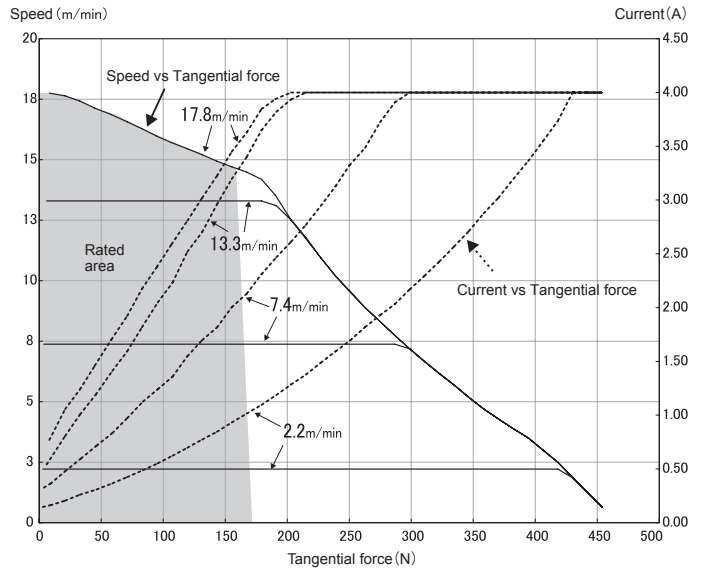

### PM500FP-55

Speed (m/min)		Tangential Force (N)		Input Current (A)		Power Input (W)	Power Output (W)	Internal Rotary Switch No.		External input voltage (V)
No-load	Rated	Rated	Starting	No-load	Starting			SW1#5	SW5	
67.0	55.0	48		0.9		60	84	9	9.6~9.9	4.0
61.4	55.0	48		0.8		60	84	8	9.1~9.4	
58.6	55.0	48		0.8		60	84	7	8.6~8.9	
55.9	55.0	48		0.8		60	84	6	8.1~8.4	
53.1	53.1	48		0.7		57	82	5	7.6~7.9	
50.3	50.3	48		0.7		54	78	4	7.1~7.4	
44.7	44.7	48		0.6		49	70	3	6.6~6.9	
41.9	41.9	49		0.6		45	68	2	6.1~6.4	
39.1	39.1	49		0.6		42	64	1	5.6~5.9	
36.3	36.3	49	136	0.5		39	61	0	5.1~5.4	
33.5	33.5	49		0.5		36	57	9	4.6~4.9	
30.8	30.8	49		0.5		33	53	8	4.1~4.4	
27.9	27.9	50		0.5		30	50	7	3.6~3.9	
25.1	25.1	50		0.4		27	47	6	3.1~3.4	
22.3	22.3	50		0.4		24	43	5	2.6~2.9	
19.5	19.5	50		0.4		21	40	4	2.1~2.4	
16.8	16.8	50		0.3		18	37	3	1.6~1.9	
14.0	14.0	51		0.3		15	32	2	1.1~1.4	
11.2	11.2	51		0.3		12	28	1	0.6~0.9	
8.3	8.3	51		0.2		9	25	0	0.1~0.4	

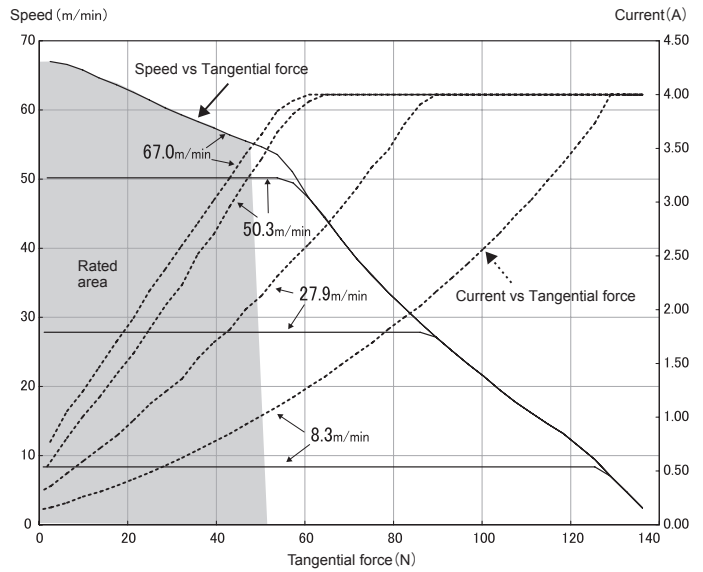

### PM500FP-255

Speed (m/min)		Tangential Force (N)		Input Current (A)		Power Input (W)	Power Output (W)	Internal Rotary Switch No.		External input voltage (V)
No-load	Rated	Rated	Starting	No-load	Starting			SW1#5	SW5	
305.4	250.7	12		0.9		60	84	9	9.6~9.9	4.0
279.8	250.7	12		0.8		60	84	8	9.1~9.4	
267.1	250.7	12		0.8		60	84	7	8.6~8.9	
254.5	250.7	12		0.8		60	84	6	8.1~8.4	
241.8	241.8	12		0.7		57	82	5	7.6~7.9	
229.2	229.2	12		0.7		54	78	4	7.1~7.4	
203.4	203.4	12		0.6		49	70	3	6.6~6.9	
190.8	190.8	12		0.6		45	68	2	6.1~6.4	
178.1	178.1	12		0.6		42	64	1	5.6~5.9	
165.4	165.4	12	34	0.5		39	61	0	5.1~5.4	
152.8	152.8	12		0.5		36	57	9	4.6~4.9	
140.1	140.1	12		0.5		33	53	8	4.1~4.4	
127.0	127.0	12		0.5		30	50	7	3.6~3.9	
114.4	114.4	12		0.4		27	47	6	3.1~3.4	
101.7	101.7	12		0.4		24	43	5	2.6~2.9	
89.0	89.0	13		0.4		21	40	4	2.1~2.4	
76.4	76.4	13		0.3		18	37	3	1.6~1.9	
63.7	63.7	13		0.3		15	32	2	1.1~1.4	
51.1	51.1	13		0.3		12	28	1	0.6~0.9	
38.0	38.0	13		0.2		9	25	0	0.1~0.4	

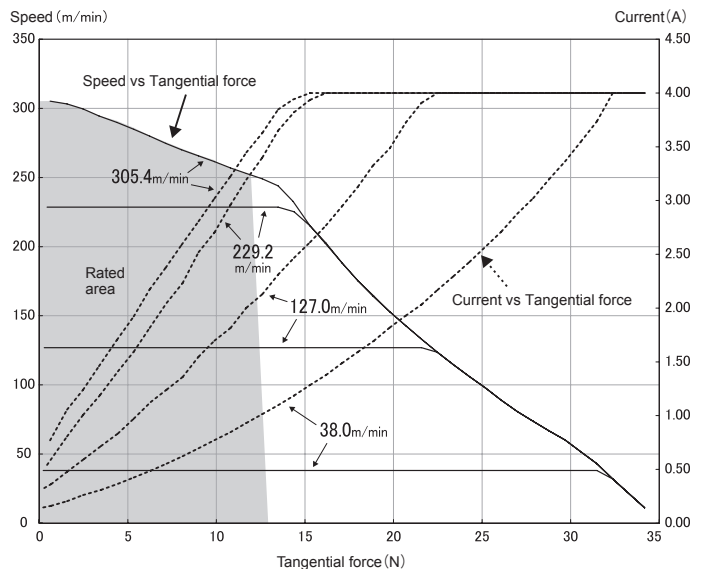

\*The values in the characteristics list are only for your reference and not the warranted values. The values represent the characteristics of a single standard motor roller (no linked operation) without including other specifications, and the values may change when including other specifications or with linked operation.



# MDR Brushless DC Motor High torque type PM500FP Roller diameter $\varnothing 50$

 [MDR Selection Tool] is available on our web page.

## Operating characteristics with HB-510N driver card

### PM500FP-15

Speed (m/min)		Tangential Force (N)		Input Current (A)		Power Input (W)	Power Output (W)	Rotary SW No	External input voltage (V)
No-load	Rated	Rated	Starting	No-load	Starting				
17.8	15.0	142	452	0.9	4.0	53	77	9	9.3~9.7
16.3	15.0	142		0.8		53	77	8	8.3~8.7
14.8	14.8	142		0.8		52	77	7	7.3~7.7
13.3	13.3	143		0.7		47	72	6	6.3~6.7
11.8	11.8	145		0.6		42	67	5	5.3~5.7
10.4	10.4	146		0.6		36	59	4	4.3~4.7
8.9	8.9	147		0.5		31	52	3	3.3~3.7
7.4	7.4	149		0.5		26	46	2	2.3~2.7
5.9	5.9	150		0.4		21	39	1	1.3~1.7
4.4	4.4	151		0.3		16	32	0	0.3~0.7

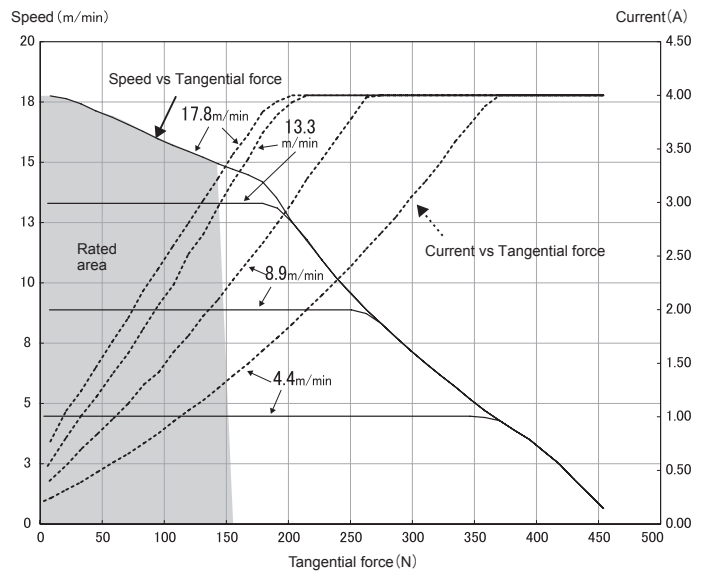

### PM500FP-55

Speed (m/min)		Tangential Force (N)		Input Current (A)		Power Input (W)	Power Output (W)	Rotary SW No	External input voltage (V)
No-load	Rated	Rated	Starting	No-load	Starting				
67.0	56.6	43	136	0.9	4.0	53	77	9	9.3~9.7
61.4	56.6	43		0.8		53	77	8	8.3~8.7
55.9	55.9	43		0.8		52	77	7	7.3~7.7
50.3	50.3	43		0.7		47	72	6	6.3~6.7
44.7	44.7	44		0.6		42	67	5	5.3~5.7
39.1	39.1	44		0.6		36	59	4	4.3~4.7
33.5	33.5	44		0.5		31	52	3	3.3~3.7
27.9	27.9	45		0.5		26	46	2	2.3~2.7
22.3	22.3	45		0.4		21	39	1	1.3~1.7
16.8	16.8	45		0.3		16	32	0	0.3~0.7

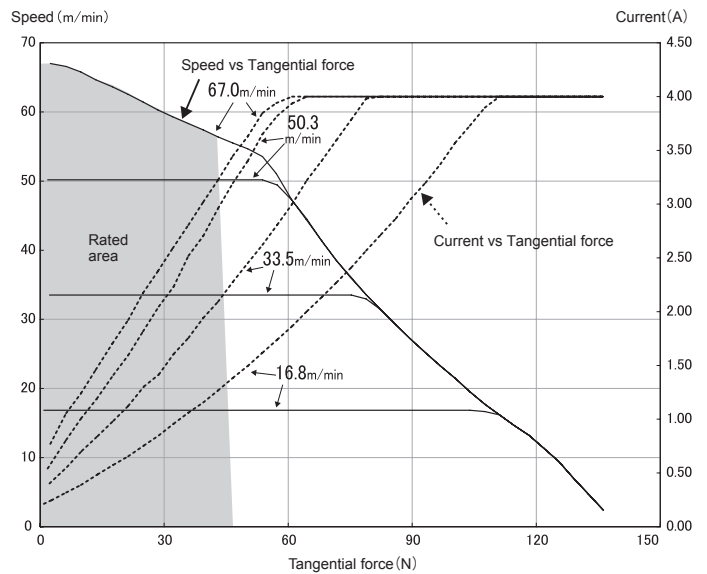

### PM500FP-255

Speed (m/min)		Tangential Force (N)		Input Current (A)		Power Input (W)	Power Output (W)	Rotary SW No	External input voltage (V)
No-load	Rated	Rated	Starting	No-load	Starting				
305.4	257.8	11	34	0.9	4.0	53	77	9	9.3~9.7
279.8	257.8	11		0.8		53	77	8	8.3~8.7
254.5	254.5	11		0.8		52	77	7	7.3~7.7
229.2	229.2	11		0.7		47	72	6	6.3~6.7
203.4	203.4	11		0.6		42	67	5	5.3~5.7
178.1	178.1	11		0.6		36	59	4	4.3~4.7
152.8	152.8	11		0.5		31	52	3	3.3~3.7
127.0	127.0	11		0.5		26	46	2	2.3~2.7
101.7	101.7	11		0.4		21	39	1	1.3~1.7
76.4	76.4	11		0.3		16	32	0	0.3~0.7

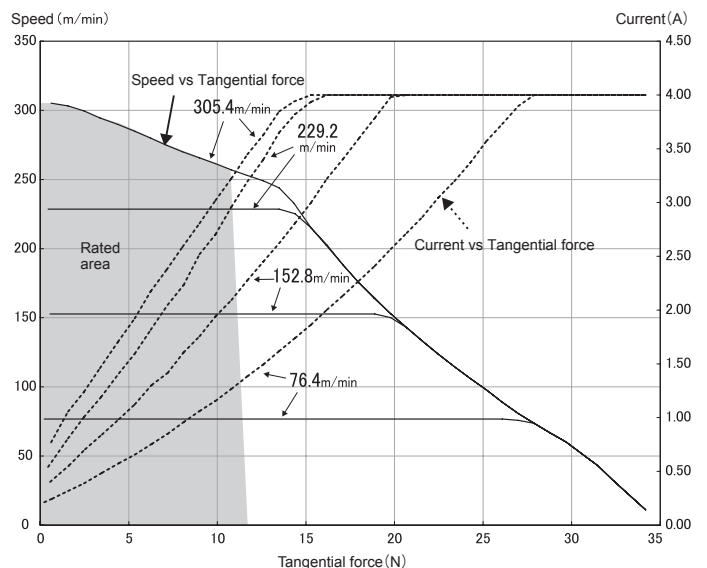

\*The values in the characteristics list are only for your reference and not the warranted values. The values represent the characteristics of a single standard motor roller (no linked operation) without including other specifications, and the values may change when including other specifications or with linked operation.



Minimum tube length



Spring loaded shaft

# MDR Brushless DC Motor High torque type PM486FP Roller diameter $\varnothing 48.6$

## Roller diameter $\varnothing 48.6$ PM486FP

- Roller diameter /  $\varnothing 48.6$
- Thickness / t1.4
- Voltage / 24V DC
- Tube material / STKM12
- Surface treatment / Trivalent chromate processing

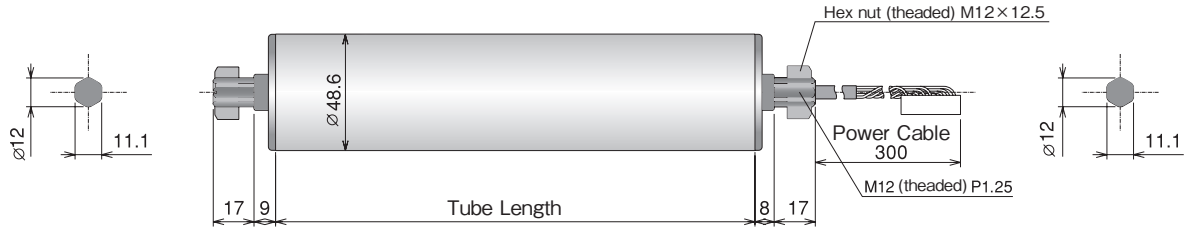

### Tube Length : PM486FP

	370mm	370mm $\leq$						
Tube Length (mm)	400	500	600	700	800	900	1000	
Weight (kg)	2.3	2.5	2.6	2.7	2.8	3.0	3.1	
Spring loaded shaft	<input type="radio"/>	<input type="radio"/>	<input type="radio"/>	<input type="radio"/>	<input type="radio"/>	<input type="radio"/>	<input type="radio"/>	

■ Conveyor frame inside dimension and frame hole shape vary by the manufacturer.

### Product Designation :

**PM486FP - 15 - 400 - D - 024 - BR**

Power Moller model    Nominal Speed    Tube Length    Voltage    Options

- Motor type : FP  
 Nominal Speed : 15,55,255  
 Tube Length : Specify in mm.  
 Voltage : D-024 (24VDC)  
 Options : Each of the following optional specification may be selected.

### Mounting Bracket :

No.P-0B1

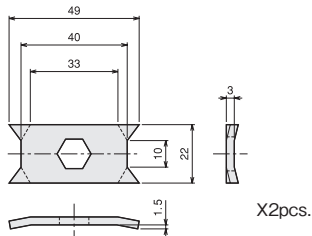

### Options : PM486FP

	<b>Rubber Laggings - NR, UR, NB, CR</b>	P.66
	Natural rubber, Urethane, NBR, Neoprene	
	<b>BR Built-In Brake - BR<sup>*1</sup></b>	P.67
	440mm	440mm $\leq$
	<b>VP V-Belt Pulley</b>	P.71
	370mm	370mm $\leq$
	<b>P2 Double Grooved Tube<sup>*2</sup></b>	P.72
	370mm	370mm $\leq$

<sup>\*1</sup> When holding type built-in brake is required, specify along with a driver card compatible with such brake specification.

[Electric brake (no holding function)] is included in the standard specification.

<sup>\*2</sup> Up to 800mm can be produced.

■ For other specification, refer to P.73.

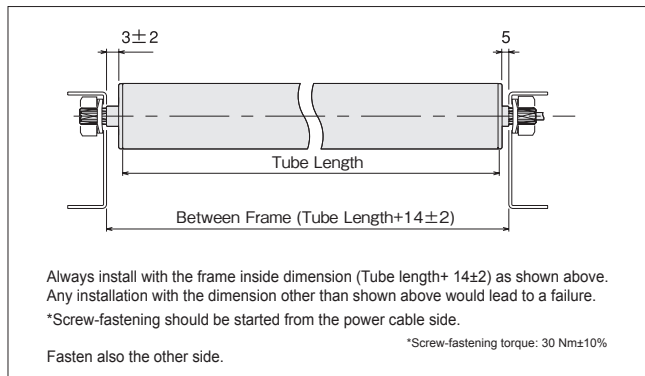

# MDR Brushless DC Motor High torque type PM486FP Roller diameter $\varnothing 48.6$

 [MDR Selection Tool] is available on our web page.

## Operating characteristics with CB-016N6 driver card

### PM486FP-15

Speed (m/min)		Tangential Force (N)		Input Current (A)		Power Input (W)	Power Output (W)	Internal Rotary Switch No.		External input voltage (V)
No-load	Rated	Rated	Starting	No-load	Starting			SW1#5	SW5	
17.3	14.2	163		0.9		60	84	9	9.6~9.9	465
15.8	14.2	163		0.8		60	84	8	9.1~9.4	
15.1	14.2	163		0.8		60	84	7	8.6~8.9	
14.4	14.2	163		0.8		60	84	6	8.1~8.4	
13.7	13.7	163		0.7		57	82	5	7.6~7.9	
13.0	13.0	164		0.7		54	78	4	7.1~7.4	
11.5	11.5	165		0.6		49	70	3	6.6~6.9	
10.8	10.8	166		0.6		45	68	2	6.1~6.4	
10.1	10.1	167		0.6		42	64	1	5.6~5.9	
9.4	9.4	167		0.5	4.0	39	61	0	5.1~5.4	
8.6	8.6	168		0.5		36	57	9	4.6~4.9	
7.9	7.9	169		0.5		33	53	8	4.1~4.4	
7.2	7.2	169		0.5		30	50	7	3.6~3.9	
6.5	6.5	170		0.4		27	47	6	3.1~3.4	
5.7	5.7	171		0.4		24	43	5	2.6~2.9	
5.0	5.0	171		0.4		21	40	4	2.1~2.4	
4.3	4.3	172		0.3		18	37	3	1.6~1.9	
3.6	3.6	173		0.3		15	32	2	1.1~1.4	
2.9	2.9	173		0.3		12	28	1	0.6~0.9	
2.1	2.1	174		0.2		9	28	0	0.1~0.4	

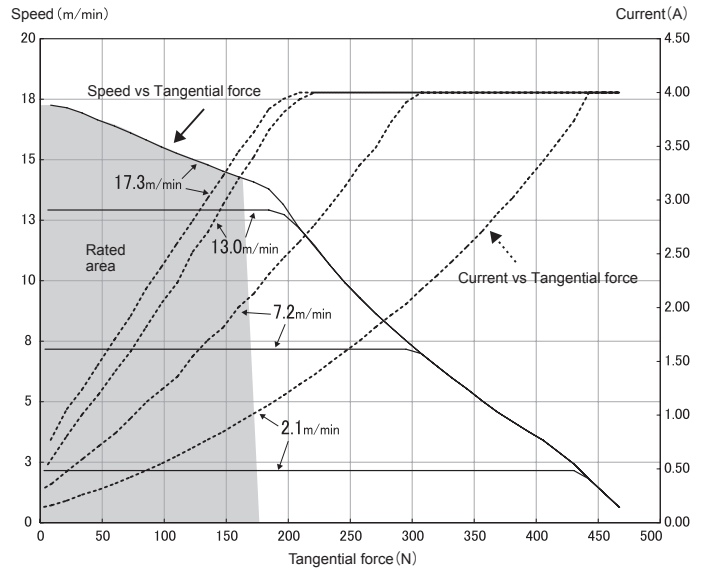

### PM486FP-55

Speed (m/min)		Tangential Force (N)		Input Current (A)		Power Input (W)	Power Output (W)	Internal Rotary Switch No.		External input voltage (V)
No-load	Rated	Rated	Starting	No-load	Starting			SW1#5	SW5	
65.2	53.5	49		0.9		60	84	9	9.6~9.9	140
59.7	53.5	49		0.8		60	84	8	9.1~9.4	
57.0	53.5	49		0.8		60	84	7	8.6~8.9	
54.3	53.5	49		0.8		60	84	6	8.1~8.4	
51.6	51.6	49		0.7		57	82	5	7.6~7.9	
48.9	48.9	49		0.7		54	78	4	7.1~7.4	
43.4	43.4	50		0.6		49	70	3	6.6~6.9	
40.7	40.7	50		0.6		45	68	2	6.1~6.4	
38.0	38.0	50		0.6		42	64	1	5.6~5.9	
35.3	35.3	50	140	0.5	4.0	39	61	0	5.1~5.4	
32.6	32.6	51		0.5		36	57	9	4.6~4.9	
29.9	29.9	51		0.5		33	53	8	4.1~4.4	
27.1	27.1	51		0.5		30	50	7	3.6~3.9	
24.4	24.4	51		0.4		27	47	6	3.1~3.4	
21.7	21.7	51		0.4		24	43	5	2.6~2.9	
19.0	19.0	52		0.4		21	40	4	2.1~2.4	
16.3	16.3	52		0.3		18	37	3	1.6~1.9	
13.6	13.6	52		0.3		15	32	2	1.1~1.4	
10.9	10.9	52		0.3		12	28	1	0.6~0.9	
8.1	8.1	52		0.2		9	25	0	0.1~0.4	

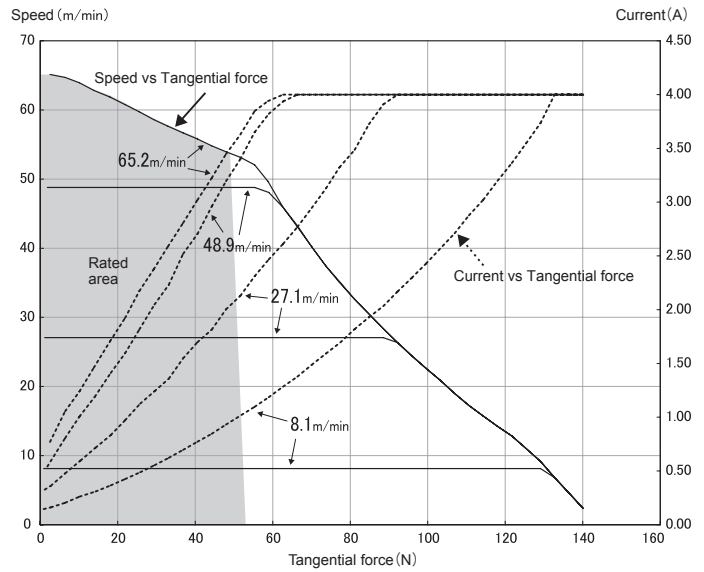

### PM486FP-255

Speed (m/min)		Tangential Force (N)		Input Current (A)		Power Input (W)	Power Output (W)	Internal Rotary Switch No.		External input voltage (V)
No-load	Rated	Rated	Starting	No-load	Starting			SW1#5	SW5	
296.8	243.7	12		0.9		60	84	9	9.6~9.9	35
272.0	243.7	12		0.8		60	84	8	9.1~9.4	
259.7	243.7	12		0.8		60	84	7	8.6~8.9	
247.4	243.7	12		0.8		60	84	6	8.1~8.4	
235.1	235.1	12		0.7		57	82	5	7.6~7.9	
222.8	222.8	12		0.7		54	78	4	7.1~7.4	
197.7	197.7	12		0.6		49	70	3	6.6~6.9	
185.4	185.4	12		0.6		45	68	2	6.1~6.4	
173.1	173.1	13		0.6		42	64	1	5.6~5.9	
160.8	160.8	13	35	0.5	4.0	39	61	0	5.1~5.4	
148.5	148.5	13		0.5		36	57	9	4.6~4.9	
136.2	136.2	13		0.5		33	53	8	4.1~4.4	
123.5	123.5	13		0.5		30	50	7	3.6~3.9	
111.2	111.2	13		0.4		27	47	6	3.1~3.4	
98.9	98.9	13		0.4		24	43	5	2.6~2.9	
86.6	86.6	13		0.4		21	40	4	2.1~2.4	
74.3	74.3	13		0.3		18	37	3	1.6~1.9	
62.0	62.0	13		0.3		15	32	2	1.1~1.4	
49.7	49.7	13		0.3		12	28	1	0.6~0.9	
36.9	36.9	13		0.2		9	25	0	0.1~0.4	

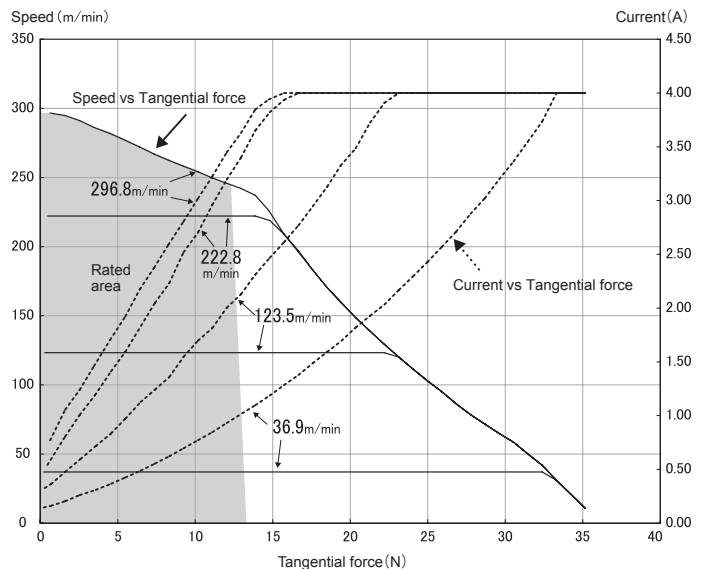

\*The values in the characteristics list are only for your reference and not the warranted values. The values represent the characteristics of a single standard motor roller (no linked operation) without including other specifications, and the values may change when including other characteristics or with linked operation.

# MDR Brushless DC Motor High torque type PM486FP Roller diameter $\varnothing 48.6$

 [MDR Selection Tool] is available on our web page.

## Operating characteristics with HB-510N driver card

### PM486FP-15

Speed (m/min)		Tangential Force (N)		Input Current (A)		Power Input (W)	Power Output (W)	Rotary SW No	External input voltage (V)
No-load	Rated	Rated	Starting	No-load	Starting				
17.3	14.6	146	465	0.9	4.0	53	77	9	9.3~9.7
15.8	14.6	146		0.8		53	77	8	8.3~8.7
14.4	14.4	147		0.8		52	77	7	7.3~7.7
13.0	13.0	148		0.7		47	72	6	6.3~6.7
11.5	11.5	149		0.6		42	67	5	5.3~5.7
10.1	10.1	150		0.6		36	59	4	4.3~4.7
8.6	8.6	152		0.5		31	52	3	3.3~3.7
7.2	7.2	153		0.5		26	46	2	2.3~2.7
5.7	5.7	154		0.4		21	39	1	1.3~1.7
4.3	4.3	155		0.3		16	32	0	0.3~0.7

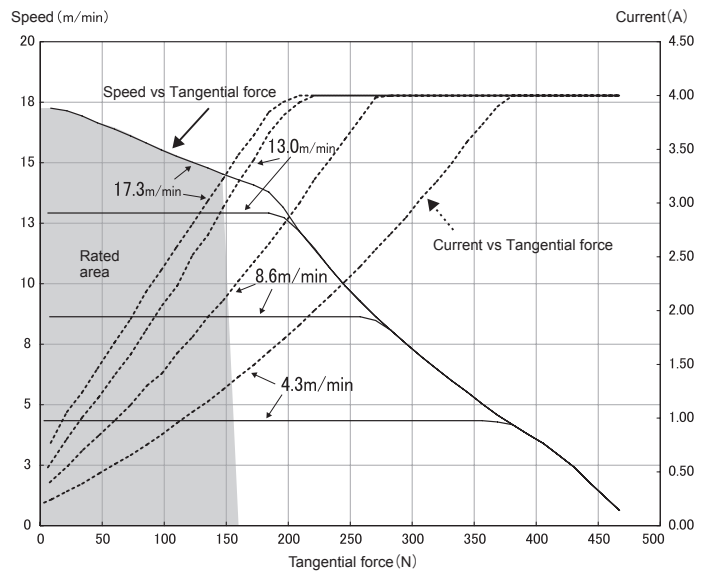

### PM486FP-55

Speed (m/min)		Tangential Force (N)		Input Current (A)		Power Input (W)	Power Output (W)	Rotary SW No	External input voltage (V)
No-load	Rated	Rated	Starting	No-load	Starting				
65.2	55.0	44	140	0.9	4.0	53	77	9	9.3~9.7
59.7	55.0	44		0.8		53	77	8	8.3~8.7
54.3	54.3	44		0.8		52	77	7	7.3~7.7
48.9	48.9	44		0.7		47	72	6	6.3~6.7
43.4	43.4	45		0.6		42	67	5	5.3~5.7
38.0	38.0	45		0.6		36	59	4	4.3~4.7
32.6	32.6	46		0.5		31	52	3	3.3~3.7
27.1	27.1	46		0.5		26	46	2	2.3~2.7
21.7	21.7	46		0.4		21	39	1	1.3~1.7
16.3	16.3	47		0.3		16	32	0	0.3~0.7

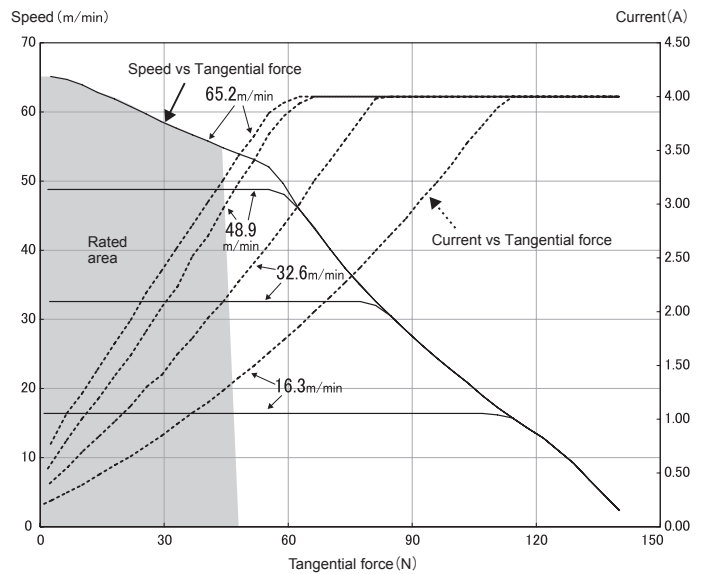

### PM486FP-255

Speed (m/min)		Tangential Force (N)		Input Current (A)		Power Input (W)	Power Output (W)	Rotary SW No	External input voltage (V)
No-load	Rated	Rated	Starting	No-load	Starting				
296.8	250.6	11	35	0.9	4.0	53	77	9	9.3~9.7
272.0	250.6	11		0.8		53	77	8	8.3~8.7
247.4	247.4	11		0.8		52	77	7	7.3~7.7
222.8	222.8	11		0.7		47	72	6	6.3~6.7
197.7	197.7	11		0.6		42	67	5	5.3~5.7
173.1	173.1	11		0.6		36	59	4	4.3~4.7
148.5	148.5	11		0.5		31	52	3	3.3~3.7
123.5	123.5	11		0.5		26	46	2	2.3~2.7
98.9	98.9	12		0.4		21	39	1	1.3~1.7
74.3	74.3	12		0.3		16	32	0	0.3~0.7

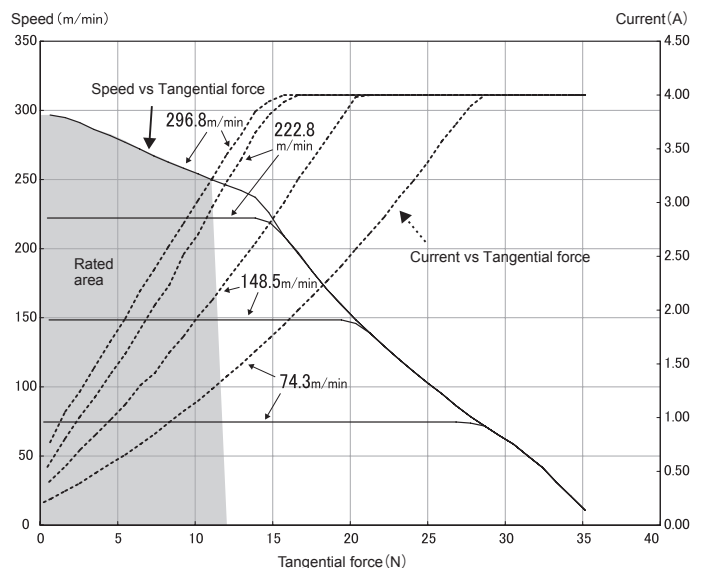

\*The values in the characteristics list are only for your reference and not the warranted values. The values represent the characteristics of a single standard motor roller (no linked operation) without including other specifications, and the values may change when including other characteristics or with linked operation.



Minimum tube length



Spring loaded shaft

# MDR Brushless DC Motor Ultra high torque type PM605KE Roller diameter $\phi 60.5$

## Roller diameter $\phi 60.5$ PM605KE

- Roller diameter /  $\phi 60.5$
- Thickness / t3.2
- Tube material / STKM12
- Voltage / 24V DC
- Surface treatment / Trivalent chromate processing
- Output shaft side surface treatment / Parkerizing
- Power supply shaft side surface treatment / Parkerizing

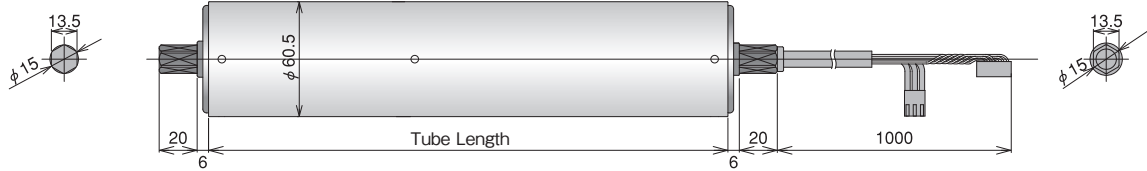

### Tube Length : PM605KE

	360mm		360mm $\leq$						
Tube Length (mm)	400	500	600	700	800	900	1000	1100	1200
Weight (kg)	5.1	5.5	6.0	6.4	6.9	7.3	7.8	8.2	8.7

- Conveyor frame inside dimension and frame hole shape vary by the manufacturer.
- For installation of MDR, frame inside dimension should be produced to (Tube length + 17mm).

### Product Designation :

**PM605KE - 15 - 1000 - D - 024 -**

Power Moller model    Nominal Speed    Tube Length    Voltage    Options

- Motor type : KE
- Nominal Speed : 15 / 55
- Tube Length : Specify in mm.
- Voltage : D-024 (24VDC)
- Options : Each of the following optional specification may be selected.



**CAUTION**

$\leq 3.2$ mm thick frame is recommended. Consult us for other frame thickness.

### Mounting Bracket :

- No.MBK-0K1-6 (including 2pcs. of the fixing bracket)
- No.MBK-0K1-7 (including 1pce. of the fixing bracket)

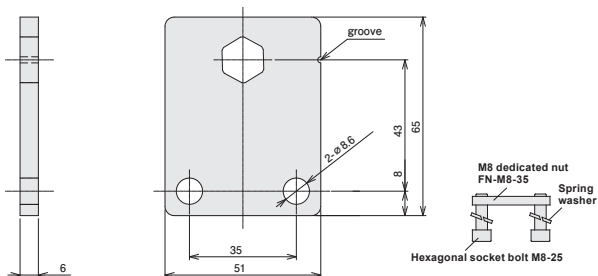

- MBK-0K6 is mounted to the power cable side.
- MBK-0K7 is mounted to the spring loaded shaft.
- Install MBK-0K1-6 with its groove symmetrically positioned.
- Fasten the bracket with the torque of 27.2Nm.

### Options : PM605KE



**Poly V-Belt Pulley**

360mm



360mm  $\leq$

P.70

# MDR Brushless DC Motor Ultra high torque type PM605KE Roller diameter $\phi$ 60.5

 [MDR Selection Tool] is available on our web page.

## Operating characteristics with CBM-103 driver card

### PM605KE-15

Speed (m/min)		Tangential Force (N)		Input Current (A)		Power Input (W)	Power Output (W)	Internal Rotary Switch No. SW2	External input voltage (V)
No-load	Rated	Rated	Starting	No-load	Starting				
15.2	15.2	165		0.7		49	76	9	9.5~9.9
14.3	14.2	175		0.6		49	74	8	8.9~9.3
13.3	13.3	183		0.6		48	71	7	8.2~8.6
12.4	12.4	188		0.5		45	67	—	7.6~8.0
11.4	11.4	193		0.5		43	67	6	7.0~7.4
10.5	10.5	201		0.5		41	62	—	6.4~6.8
9.5	9.5	210		0.4		39	61	5	5.7~6.1
8.6	8.6	212	1067	0.4	10.0	41	56	—	5.1~5.5
7.6	7.6	215		0.4		35	57	4	4.5~4.9
6.7	6.7	244		0.3		33	53	—	3.9~4.3
5.7	5.7	274		0.3		30	52	3	3.2~3.6
4.8	4.8	281		0.3		26	48	—	2.6~3.0
3.8	3.8	289		0.2		22	45	2	2.0~2.4
2.9	2.8	303		0.2		17	41	1	1.4~1.8
1.9	1.9	309		0.1		12	36	0	0.7~1.1
1.0	1.0	314		0.1		6	30	—	0.1~0.5

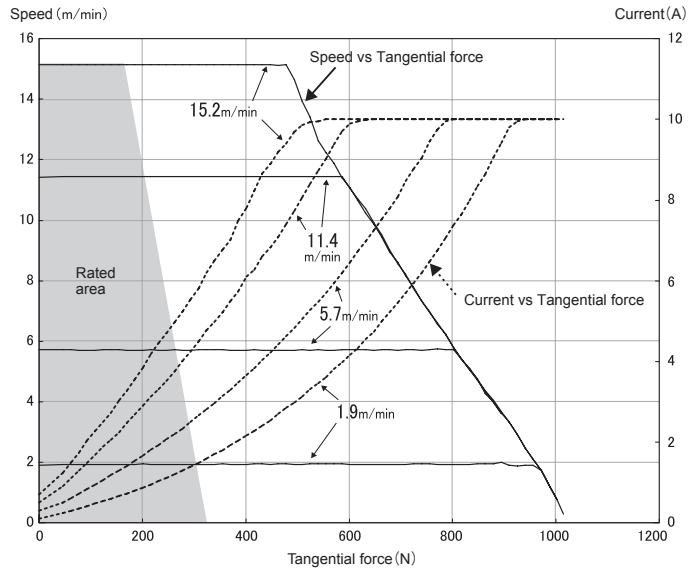

### PM605KE-55

Speed (m/min)		Tangential Force (N)		Input Current (A)		Power Input (W)	Power Output (W)	Internal Rotary Switch No. SW2	External input voltage (V)
No-load	Rated	Rated	Starting	No-load	Starting				
57.9	57.6	46		0.8		49	76	9	9.5~9.9
54.3	54.0	49		0.7		49	74	8	8.9~9.3
50.7	50.4	51		0.7		48	71	7	8.2~8.6
47.1	47.1	52		0.6		45	67	—	7.6~8.0
43.4	43.3	53		0.6		43	67	6	7.0~7.4
39.8	39.8	56		0.6		41	62	—	6.4~6.8
36.2	36.2	58		0.5		39	61	5	5.7~6.1
32.6	32.6	59	296	0.5	10.0	41	56	—	5.1~5.5
29.0	29.0	59		0.4		35	57	4	4.5~4.9
25.3	25.3	68		0.3		33	53	—	3.9~4.3
21.7	21.7	76		0.3		30	52	3	3.2~3.6
18.1	18.1	78		0.3		26	48	—	2.6~3.0
14.5	14.4	80		0.2		22	45	2	2.0~2.4
10.9	10.8	84		0.2		17	41	1	1.4~1.8
7.2	7.2	86		0.1		12	36	0	0.7~1.1
3.6	3.6	87		0.1		6	30	—	0.1~0.5

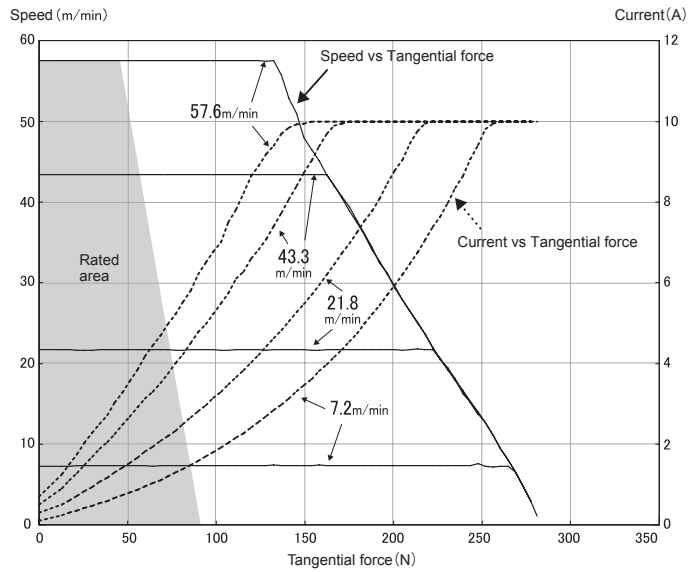

\*The values in the characteristics list are only for your reference and not the warranted values. The values represent the characteristics of a single standard motor roller (no linked operation) without including other specifications, and the values may change when including other specifications or with linked operation.



Minimum tube length



Spring loaded shaft

# MDR Brushless DC Motor Integral motor driver type PM486XE/PM486XP

Roller diameter  $\varnothing 48.6$

## Roller diameter $\varnothing 48.6$ PM486XE PM486XP

- Roller diameter /  $\varnothing 48.6$
- Thickness / t1.4
- Voltage / 24V DC
- Tube material / STKM12
- Surface treatment / Trivalent chromate processing

### Product Designation :

**PM486XE - 17 - 400 - D - 024 - C007 - NN - VG**

Power Moller model	Nominal Speed	Tube Length	Voltage	Cable	Input/Output Signal	Options

- Motor type** : XE / XP  
**Nominal Speed** : 17,30,60,100  
**Tube Length** : Specify in mm.  
**Voltage** : D-024 (24VDC)  
**Input/Output Signal** : NN-NPN input-output / NP-NPN input, PNP output  
 \*Drip proof and 5P metal connector specification does not require designation. Leave this position blank.  
**Cable Options** : Type and length of the power cable  
 : Each of the following optional specification may be selected.

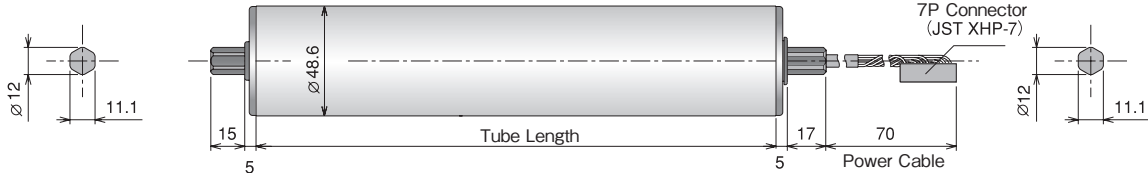

### Tube Length : PM486XE/PM486XP

	350mm		350mm $\leq$				
Tube Length (mm)	400	500	600	700	800	900	1000
Weight (kg)	2.9	3.1	3.2	3.4	3.5	3.7	3.8
Spring loaded shaft	<input type="checkbox"/>	<input type="checkbox"/>	<input type="checkbox"/>	<input type="checkbox"/>	<input type="checkbox"/>	<input type="checkbox"/>	<input type="checkbox"/>

- Conveyor frame inside dimension and frame hole shape vary by the manufacturer.
- A gap of 2-5mm is required between the frame inside dimension and Power Moller.

### Options : PM486XE/PM486XP

**RUBBER LAGGINGS - NR, UR, NB, CR** P.66  
 Natural rubber, Urethane, NBR, Neoprene

**DR DRIP PROOF** P.68  
 350mm 350mm  $\leq$

**VG Poly V-Belt Pulley** P.70  
 350mm 350mm  $\leq$

**P2 Double Grooved Tube**<sup>\*1</sup> P.72  
 400mm 400mm  $\leq$

### JD Both-end D-shaped shaft

- \*1 Up to 800mm can be produced.
- For other specification, refer to P.73.

### Mounting Bracket : No.MBB-A80-G<sup>\*\*</sup>

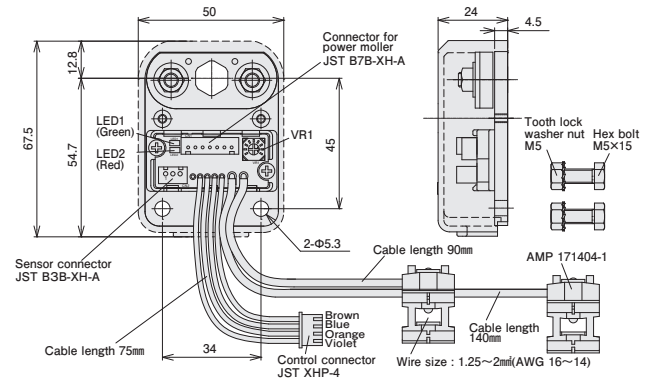

- Attach to the power cable side.
- Apply 6-10Nm torque for securing the Power Moller mounting shaft, and 3.5Nm for securing the bracket.

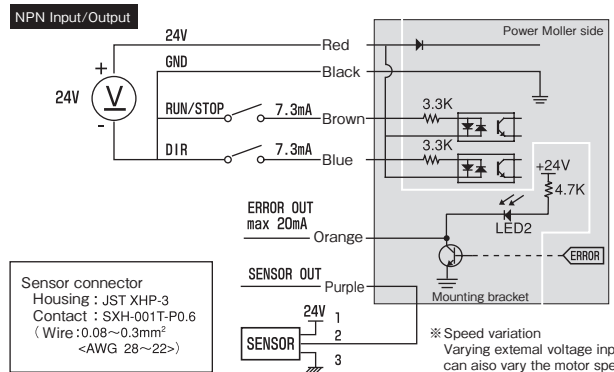

※ Speed variation Varying external voltage input can also vary the motor speed instead of external resistor.

### Mounting Bracket : No.MBB-081

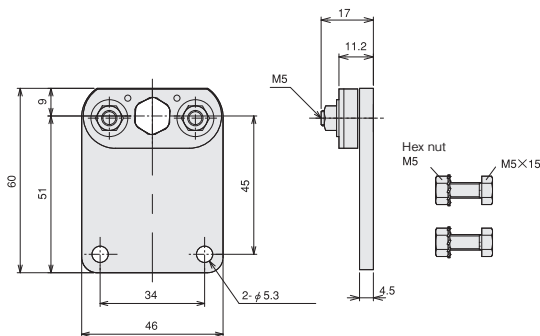

- \*Attach to the power cable side.
- Apply 6-10Nm torque for securing the Power Moller mounting shaft, and 3.5Nm for securing the bracket.

### Dripproof option/M8 5P connector cable

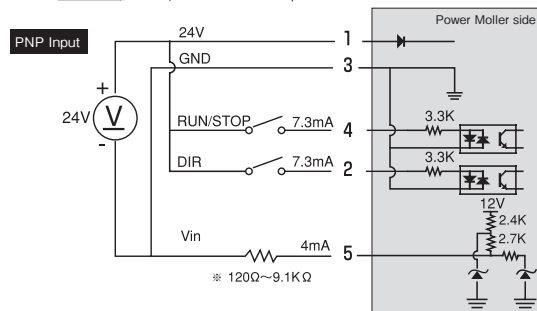
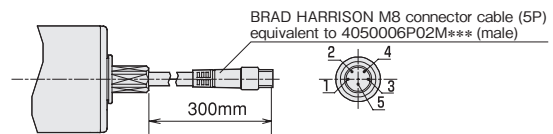

※ Speed variation Varying external voltage input can also vary the motor speed instead of external resistor.



 [MDR Selection Tool] is available on our web page.

Operating characteristics : PM486XE

PM486XE-17

Speed (m/min)		Tangential Force (N)		Input Current (A)		Power Input (W)	Power Output (W)	External resistor ( $\Omega$ )	External input voltage (V)
No-load	Rated	Rated	Starting	No-load	Starting				
16.9	16.9	72	268	0.5	2.0	31	41	9.1K or over or open	9.3~10*
15.5	15.5	78		0.5		30	41	6.2K	8.5 $\pm$ 0.2
12.7	12.7	84		0.4		27	38	4.3K	7.5 $\pm$ 0.2
11.3	11.3	88		0.4		24	36	3.3K	6.5 $\pm$ 0.2
9.9	9.9	91		0.3		23	34	2.2K	5.5 $\pm$ 0.2
8.4	8.4	97		0.3		21	31	1.8K	4.5 $\pm$ 0.2
5.6	5.6	103		0.3		14	24	1.2K	3.5 $\pm$ 0.2
4.2	4.2	110		0.2		12	22	750	2.5 $\pm$ 0.2
2.8	2.8	116		0.2		8	19	430	1.5 $\pm$ 0.2
2.1	2.1	116		0.2		6	17	120 or less of short	0~0.9

\*9.3~10 or No input Voltage

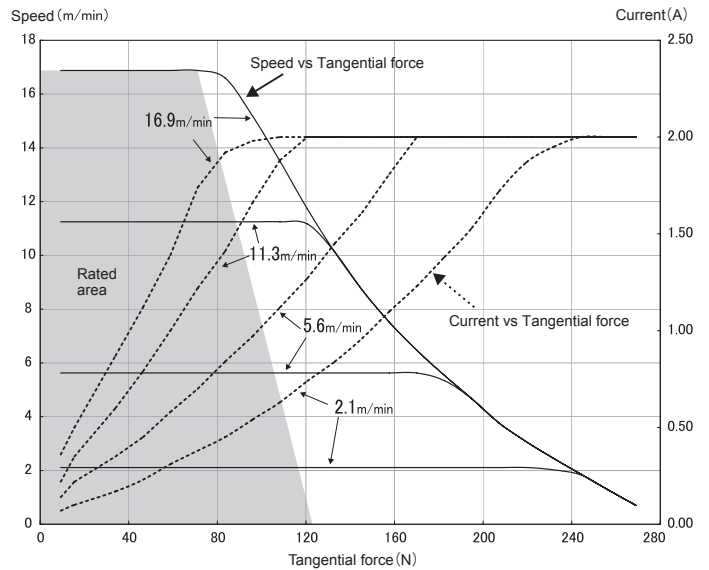

PM486XE-30

Speed (m/min)		Tangential Force (N)		Input Current (A)		Power Input (W)	Power Output (W)	External resistor ( $\Omega$ )	External input voltage (V)
No-load	Rated	Rated	Starting	No-load	Starting				
28.4	28.4	49	183	0.5	2.0	31	41	9.1K or over or open	9.3~10*
26.0	26.0	53		0.5		30	41	6.2K	8.5 $\pm$ 0.2
21.3	21.3	57		0.4		27	38	4.3K	7.5 $\pm$ 0.2
18.9	18.9	60		0.4		24	36	3.3K	6.5 $\pm$ 0.2
16.6	16.6	62		0.3		23	34	2.2K	5.5 $\pm$ 0.2
14.2	14.2	67		0.3		21	31	1.8K	4.5 $\pm$ 0.2
9.5	9.5	71		0.3		14	24	1.2K	3.5 $\pm$ 0.2
7.1	7.1	75		0.2		12	22	750	2.5 $\pm$ 0.2
4.7	4.7	79		0.2		8	19	430	1.5 $\pm$ 0.2
3.6	3.6	79		0.2		6	17	120 or less of short	0~0.9

\*9.3~10 or No input Voltage

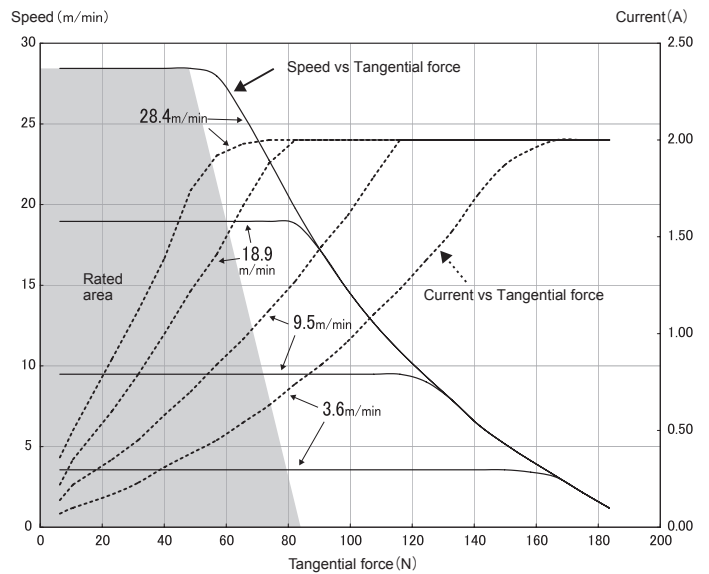

PM486XE-60

Speed (m/min)		Tangential Force (N)		Input Current (A)		Power Input (W)	Power Output (W)	External resistor ( $\Omega$ )	External input voltage (V)
No-load	Rated	Rated	Starting	No-load	Starting				
60.0	60.0	23	87	0.5	2.0	31	41	9.1K or over or open	9.3~10*
55.0	55.0	25		0.5		30	41	6.2K	8.5 $\pm$ 0.2
45.0	45.0	27		0.4		27	38	4.3K	7.5 $\pm$ 0.2
40.0	40.0	28		0.4		24	36	3.3K	6.5 $\pm$ 0.2
35.0	35.0	30		0.3		23	34	2.2K	5.5 $\pm$ 0.2
30.0	30.0	31		0.3		21	31	1.8K	4.5 $\pm$ 0.2
20.0	20.0	33		0.3		14	24	1.2K	3.5 $\pm$ 0.2
15.0	15.0	35		0.2		12	22	750	2.5 $\pm$ 0.2
10.0	10.0	37		0.2		8	19	430	1.5 $\pm$ 0.2
7.5	7.5	37		0.2		6	17	120 or less of short	0~0.9

\*9.3~10 or No input Voltage

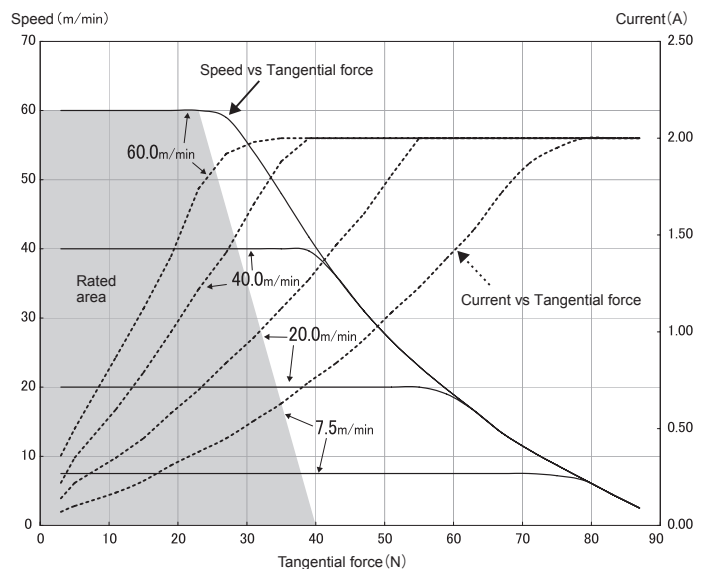

\*The values in the characteristics list are only for your reference and not the warranted values. The values represent the characteristics of a single standard motor roller (no linked operation) without including other specifications, and the values may change when including other specifications or with linked operation.

 [MDR Selection Tool] is available on our web page.

Operating characteristics : PM486XE

PM486XE-100

Speed (m/min)		Tangential Force (N)		Input Current (A)		Power Input (W)	Power Output (W)	External resistor ( $\Omega$ )	External input voltage (V)
No-load	Rated	Rated	Starting	No-load	Starting				
101.1	101.1	16		0.5		31	41	9.1K or over or open	9.3~10 *
92.7	92.7	17		0.5		30	41	6.2K	8.5 $\pm$ 0.2
75.8	75.8	19		0.4		27	38	4.3K	7.5 $\pm$ 0.2
67.4	67.4	19		0.4		24	36	3.3K	6.5 $\pm$ 0.2
59.0	59.0	20		0.3		23	34	2.2K	5.5 $\pm$ 0.2
50.6	50.6	21		0.3		21	31	1.8K	4.5 $\pm$ 0.2
33.7	33.7	23		0.3		14	24	1.2K	3.5 $\pm$ 0.2
25.3	25.3	24		0.2		12	22	750	2.5 $\pm$ 0.2
16.9	16.9	26		0.2		8	19	430	1.5 $\pm$ 0.2
12.6	12.6	26		0.2		6	17	120 or less of short	0~0.9

\*9.3~10 or No input Voltage

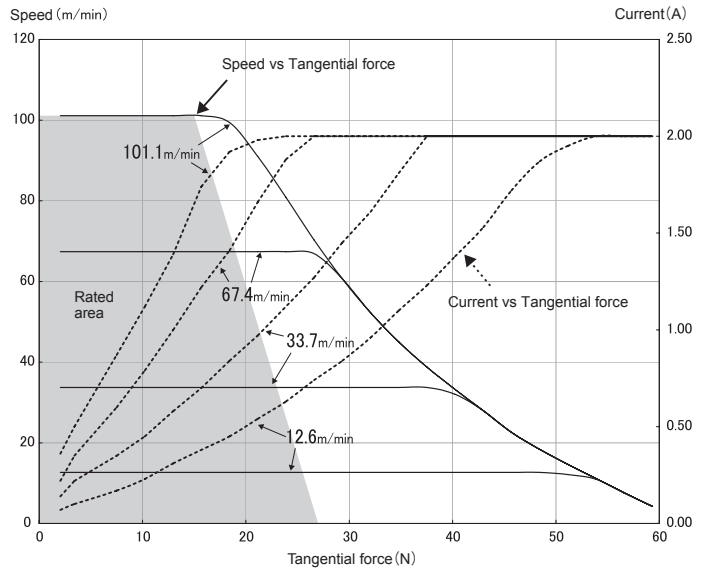

Operating characteristics : PM486XP

PM486XP-17

Speed (m/min)		Tangential Force (N)		Input Current (A)		Power Input (W)	Power Output (W)	External resistor ( $\Omega$ )	External input voltage (V)
No-load	Rated	Rated	Starting	No-load	Starting				
16.9	16.9	84		0.5		36	48	9.1K or over or open	9.3~10 *
15.5	15.5	90		0.5		35	48	6.2K	8.5 $\pm$ 0.2
12.7	12.7	97		0.4		31	43	4.3K	7.5 $\pm$ 0.2
11.3	11.3	100		0.4		28	38	3.3K	6.5 $\pm$ 0.2
9.9	9.9	102		0.3		24	36	2.2K	5.5 $\pm$ 0.2
8.4	8.4	105		0.3		22	34	1.8K	4.5 $\pm$ 0.2
5.6	5.6	110		0.3		16	26	1.2K	3.5 $\pm$ 0.2
4.2	4.2	110		0.2		12	24	750	2.5 $\pm$ 0.2
2.8	2.8	116		0.2		8	19	430	1.5 $\pm$ 0.2
2.1	2.1	116		0.2		6	17	120 or less of short	0~0.9

\*9.3~10 or No input Voltage

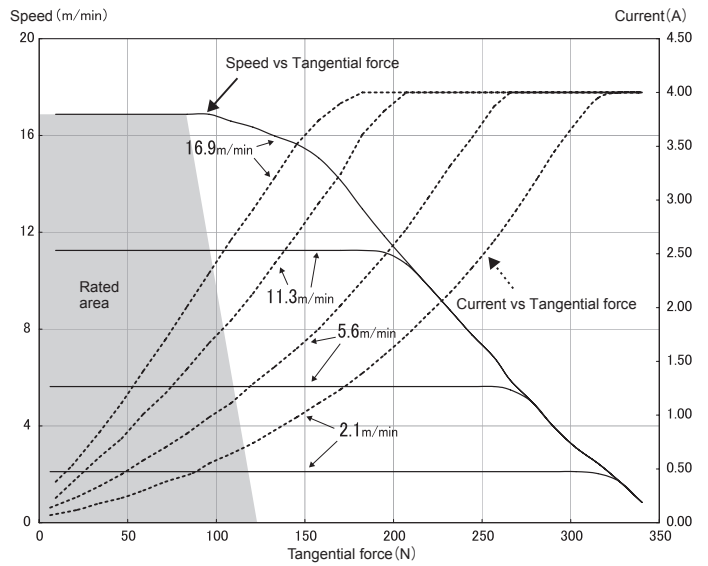

PM486XP-30

Speed (m/min)		Tangential Force (N)		Input Current (A)		Power Input (W)	Power Output (W)	External resistor ( $\Omega$ )	External input voltage (V)
No-load	Rated	Rated	Starting	No-load	Starting				
28.4	28.4	57		0.5		36	48	9.1K or over or open	9.3~10 *
26.0	26.0	62		0.5		35	48	6.2K	8.5 $\pm$ 0.2
21.3	21.3	67		0.4		31	43	4.3K	7.5 $\pm$ 0.2
18.9	18.9	68		0.4		28	38	3.3K	6.5 $\pm$ 0.2
16.6	16.6	70		0.3		24	36	2.2K	5.5 $\pm$ 0.2
14.2	14.2	72		0.3		22	34	1.8K	4.5 $\pm$ 0.2
9.5	9.5	75		0.3		16	26	1.2K	3.5 $\pm$ 0.2
7.1	7.1	75		0.2		12	24	750	2.5 $\pm$ 0.2
4.7	4.7	79		0.2		8	19	430	1.5 $\pm$ 0.2
3.6	3.6	79		0.2		6	17	120 or less of short	0~0.9

\*9.3~10 or No input Voltage

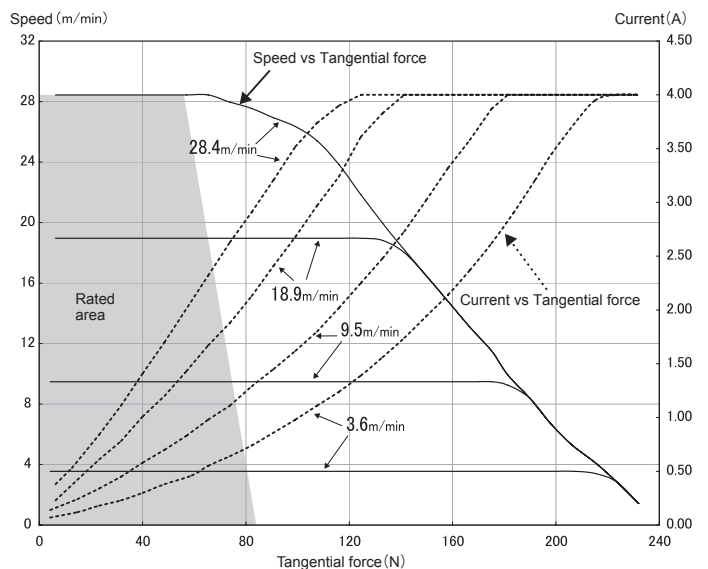

\*The values in the characteristics list are only for your reference and not the warranted values. The values represent the characteristics of a single standard motor roller (no linked operation) without including other specifications, and the values may change when including other characteristics or with linked operation.

 [MDR Selection Tool] is available on our web page.

Operating characteristics : PM486XP

PM486XP-60

Speed (m/min)		Tangential Force (N)		Input Current (A)		Power Input (W)	Power Output (W)	External resistor ( $\Omega$ )	External input voltage (V)
No-load	Rated	Rated	Starting	No-load	Starting				
60.0	60.0	27	112	0.5	4.0	36	48	9.1K or over or open	9.3~10 *
55.0	55.0	29		0.5		35	48	6.2K	8.5 $\pm$ 0.2
45.0	45.0	31		0.4		31	43	4.3K	7.5 $\pm$ 0.2
40.0	40.0	32		0.4		28	38	3.3K	6.5 $\pm$ 0.2
35.0	35.0	33		0.3		24	36	2.2K	5.5 $\pm$ 0.2
30.0	30.0	34		0.3		22	34	1.8K	4.5 $\pm$ 0.2
20.0	20.0	35		0.3		16	26	1.2K	3.5 $\pm$ 0.2
15.0	15.0	35		0.2		12	24	750	2.5 $\pm$ 0.2
10.0	10.0	37		0.2		8	19	430	1.5 $\pm$ 0.2
7.5	7.5	37		0.2		6	17	120 or less of short	0~0.9

\*9.3~10 or No input Voltage

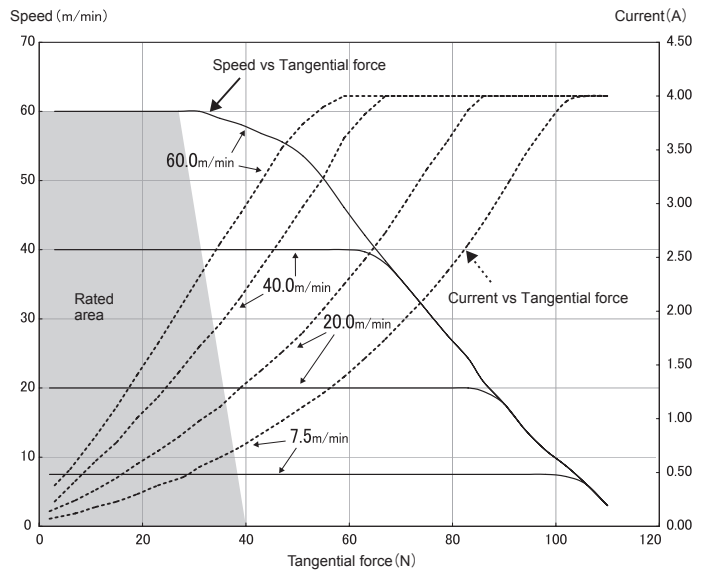

PM486XP-100

Speed (m/min)		Tangential Force (N)		Input Current (A)		Power Input (W)	Power Output (W)	External resistor ( $\Omega$ )	External input voltage (V)
No-load	Rated	Rated	Starting	No-load	Starting				
101.1	101.1	19	77	0.5	4.0	36	48	9.1K or over or open	9.3~10 *
92.7	92.7	20		0.5		35	48	6.2K	8.5 $\pm$ 0.2
75.8	75.8	21		0.4		31	43	4.3K	7.5 $\pm$ 0.2
67.4	67.4	22		0.4		28	38	3.3K	6.5 $\pm$ 0.2
59.0	59.0	23		0.3		24	36	2.2K	5.5 $\pm$ 0.2
50.6	50.6	23		0.3		22	34	1.8K	4.5 $\pm$ 0.2
33.7	33.7	24		0.3		16	26	1.2K	3.5 $\pm$ 0.2
25.3	25.3	24		0.2		12	24	750	2.5 $\pm$ 0.2
16.9	16.9	26		0.2		8	19	430	1.5 $\pm$ 0.2
12.6	12.6	26		0.2		6	17	120 or less of short	0~0.9

\*9.3~10 or No input Voltage

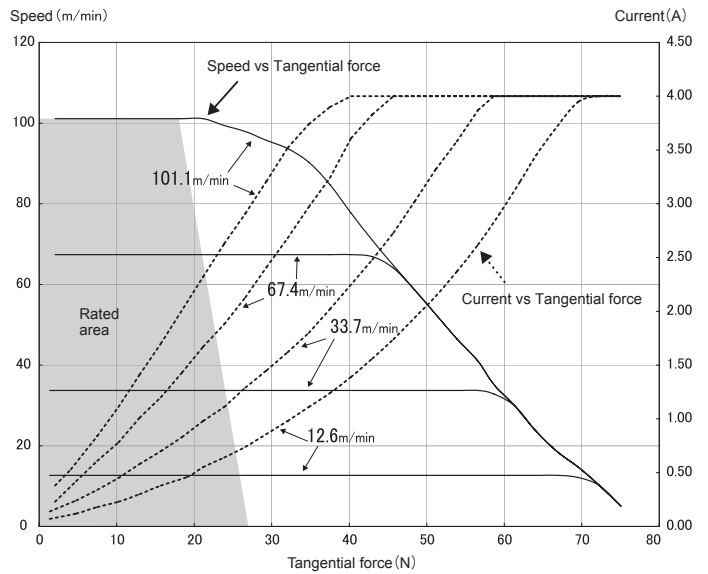

\*The values in the characteristics list are only for your reference and not the warranted values. The values represent the characteristics of a single standard motor roller (no linked operation) without including other specifications, and the values may change when including other specifications or with linked operation.



Minimum tube length



Spring loaded shaft

# MDR Brushless DC Motor Integral motor driver type PM500XE/PM500XP

Roller diameter  $\varnothing 50$

## Roller diameter $\varnothing 50$ PM500XE PM500XP

- Roller diameter /  $\varnothing 50$
- Thickness /  $t1.4$
- Voltage / 24V DC
- Tube material / STKM12
- Surface treatment / Trivalent chromate processing

### Product Designation :

**PM500XE - 17 - 400 - D - 024 - C007 - NN - VG**

Power Moller model	Nominal Speed	Tube Length	Voltage	Cable	Input/Output Signal	Options

- Motor type** : XE / XP  
**Nominal Speed** : 17,30,60,100  
**Tube Length** : Specify in mm.  
**Voltage** : D-024 (24VDC)  
**Input/Output Signal** : NN-NPN input-output / NP-NPN input, PNP output  
 \*Drip proof and 5P metal connector specification does not require designation. Leave this position blank.  
**Cable Options** : Type and length of the power cable  
 : Each of the following optional specification may be selected.

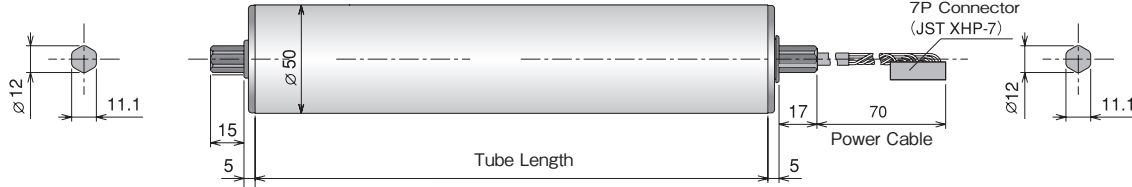

### Tube Length : PM500XE/PM500XP

	350mm	350mm $\leq$					
Tube Length (mm)	400	500	600	700	800	900	1000
Weight (kg)	2.9	3.1	3.2	3.4	3.5	3.7	3.8
Spring loaded shaft	<input type="radio"/>	<input type="radio"/>	<input type="radio"/>	<input type="radio"/>	<input type="radio"/>	<input type="radio"/>	<input type="radio"/>

- Conveyor frame inside dimension and frame hole shape vary by the manufacturer.
- A gap of 2-5mm is required between the frame inside dimension and Power Moller.

### Options : PM500XE/PM500XP

**RUBBER LAGGINGS - NR, UR, NB, CR** P.66  
 Natural rubber, Urethane, NBR, Neoprene

**DR DRIP PROOF** P.68  
 350mm 350mm  $\leq$

**VG Poly V-Belt Pulley** P.70  
 350mm 350mm  $\leq$

**P2 Double Grooved Tube**<sup>\*1</sup> P.72  
 400mm 400mm  $\leq$

### JD Both-end D-shaped shaft

- \*1 Up to 800mm can be produced.
- For other specification, refer to P.73.

### Mounting Bracket : No.MBB-A80-G<sup>\*\*</sup>

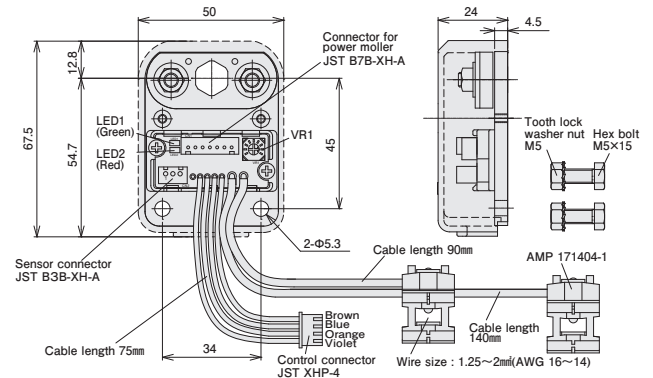

- Attach to the power cable side.
- Apply 6-10Nm torque for securing the Power Moller mounting shaft, and 3.5Nm for securing the bracket.

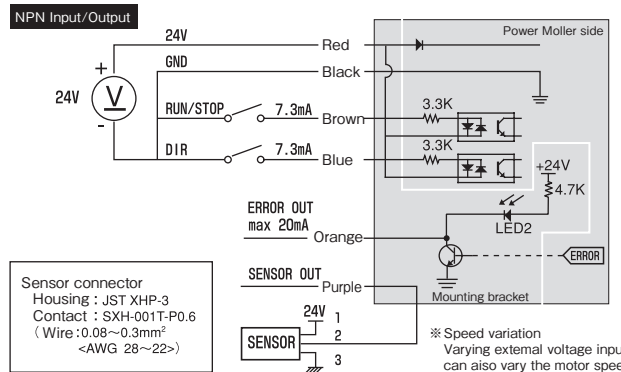

### Mounting Bracket : No.MBB-081

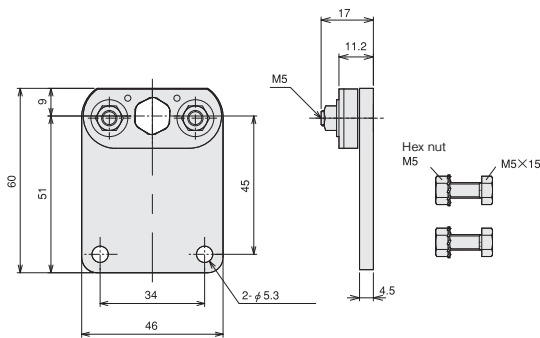

- \*Attach to the power cable side.
- Apply 6-10Nm torque for securing the Power Moller mounting shaft, and 3.5Nm for securing the bracket.

### Dripproof option/M8 5P connector cable

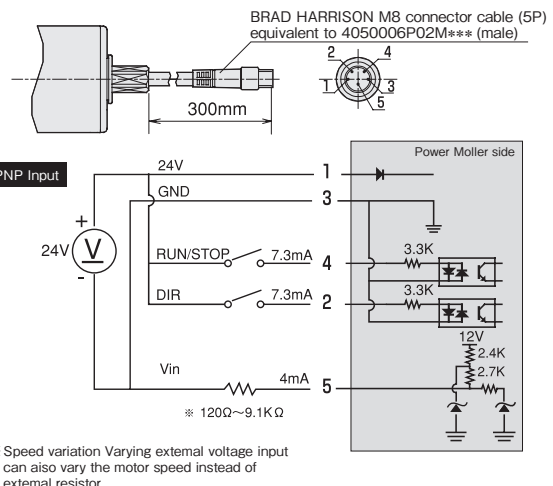

- \*Speed variation Varying external voltage input can also vary the motor speed instead of external resistor.

# MDR Brushless DC Motor Integral motor driver type PM500XE Roller diameter $\varnothing$ 50

[MDR Selection Tool] is available on our web page.

## Operating characteristics : PM500XE

### PM500XE-17

Speed (m/min)		Tangential Force (N)		Input Current (A)		Power Input (W)	Power Output (W)	External resistor ( $\Omega$ )	External input voltage (V)
No-load	Rated	Rated	Starting	No-load	Starting				
17.4	17.4	70		0.5		30	41	9.1K or over or open	9.3~10 *
15.9	15.9	76		0.5		30	41	6.2K	8.5 $\pm$ 0.2
13.0	13.0	82		0.4		27	38	4.3K	7.5 $\pm$ 0.2
11.6	11.6	85		0.4		24	36	3.3K	6.5 $\pm$ 0.2
10.1	10.1	89		0.3		23	34	2.2K	5.5 $\pm$ 0.2
8.7	8.7	95		0.3		21	31	1.8K	4.5 $\pm$ 0.2
5.8	5.8	101		0.3		14	24	1.2K	3.5 $\pm$ 0.2
4.3	4.3	106		0.2		12	22	750	2.5 $\pm$ 0.2
2.9	2.9	112		0.2		8	19	430	1.5 $\pm$ 0.2
2.2	2.2	112		0.2		6	17	120 or less of short	0~0.9

\*9.3~10 or No input Voltage

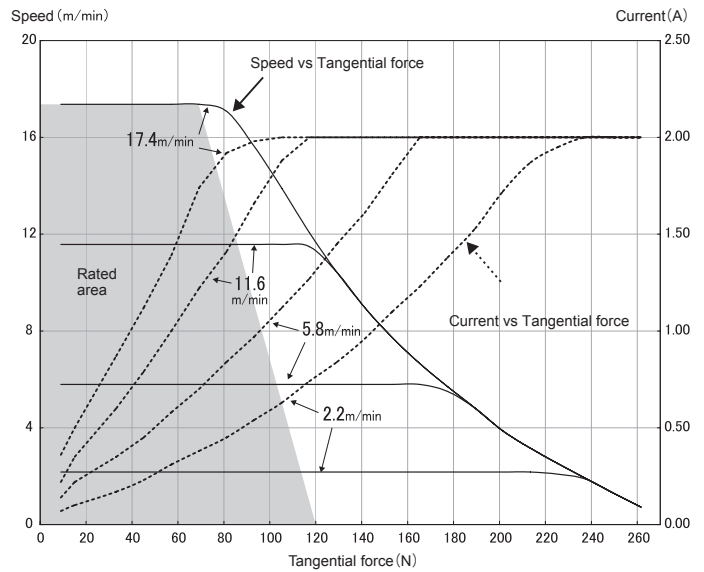

### PM500XE-30

Speed (m/min)		Tangential Force (N)		Input Current (A)		Power Input (W)	Power Output (W)	External resistor ( $\Omega$ )	External input voltage (V)
No-load	Rated	Rated	Starting	No-load	Starting				
29.2	29.2	48		0.5		31	41	9.1K or over or open	9.3~10 *
26.8	26.8	52		0.5		30	41	6.2K	8.5 $\pm$ 0.2
21.9	21.9	56		0.4		27	38	4.3K	7.5 $\pm$ 0.2
19.5	19.5	58		0.4		24	36	3.3K	6.5 $\pm$ 0.2
17.0	17.0	61		0.3		23	34	2.2K	5.5 $\pm$ 0.2
14.6	14.6	65		0.3		21	31	1.8K	4.5 $\pm$ 0.2
9.7	9.7	69		0.3		14	24	1.2K	3.5 $\pm$ 0.2
7.3	7.3	73		0.2		12	22	750	2.5 $\pm$ 0.2
4.9	4.9	77		0.2		8	19	430	1.5 $\pm$ 0.2
3.7	3.7	77		0.2		6	17	120 or less of short	0~0.9

\*9.3~10 or No input Voltage

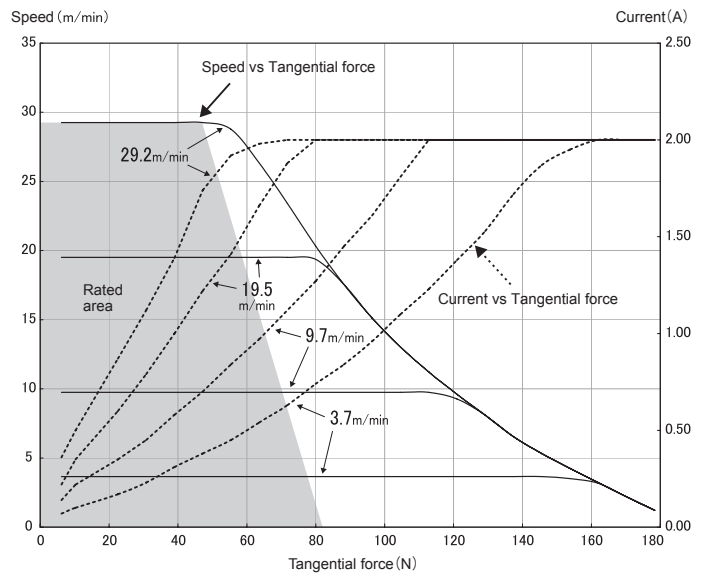

### PM500XE-60

Speed (m/min)		Tangential Force (N)		Input Current (A)		Power Input (W)	Power Output (W)	External resistor ( $\Omega$ )	External input voltage (V)
No-load	Rated	Rated	Starting	No-load	Starting				
61.7	61.7	23		0.5		31	41	9.1K or over or open	9.3~10 *
56.6	56.6	24		0.5		30	41	6.2K	8.5 $\pm$ 0.2
46.3	46.3	26		0.4		27	38	4.3K	7.5 $\pm$ 0.2
41.2	41.2	28		0.4		24	36	3.3K	6.5 $\pm$ 0.2
36.0	36.0	29		0.3		23	34	2.2K	5.5 $\pm$ 0.2
30.9	30.9	31		0.3		21	31	1.8K	4.5 $\pm$ 0.2
20.6	20.6	33		0.3		14	24	1.2K	3.5 $\pm$ 0.2
15.4	15.4	34		0.2		12	22	750	2.5 $\pm$ 0.2
10.3	10.3	36		0.2		8	19	430	1.5 $\pm$ 0.2
7.7	7.7	36		0.2		6	17	120 or less of short	0~0.9

\*9.3~10 or No input Voltage

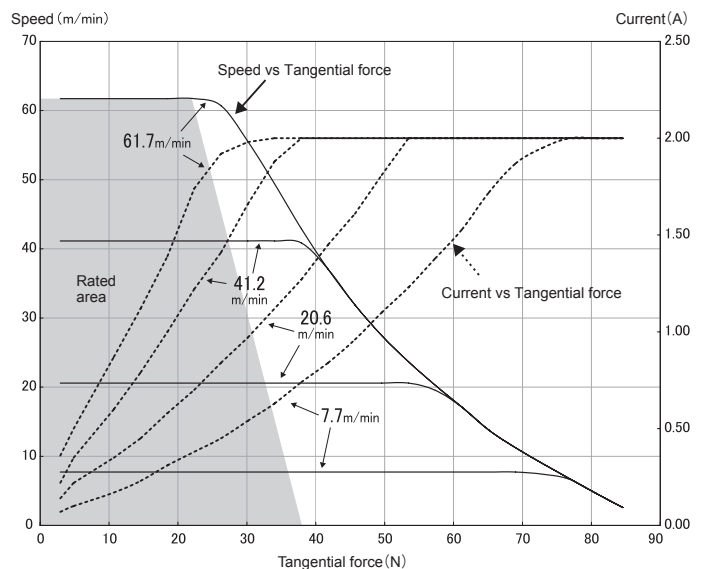

\*The values in the characteristics list are only for your reference and not the warranted values. The values represent the characteristics of a single standard motor roller (no linked operation) without including other specifications, and the values may change when including other specifications or with linked operation.

 [MDR Selection Tool] is available on our web page.

Operating characteristics : PM500XE

PM500XE-100

Speed (m/min)		Tangential Force (N)		Input Current (A)		Power Input (W)	Power Output (W)	External resistor ( $\Omega$ )	External input voltage (V)
No-load	Rated	Rated	Starting	No-load	Starting				
104.0	104.0	15	57	0.5	2.0	31	41	9.1K or over or open	9.3~10 *
95.4	95.4	17		0.5		30	41	6.2K	8.5 $\pm$ 0.2
78.0	78.0	18		0.4		27	38	4.3K	7.5 $\pm$ 0.2
69.4	69.4	19		0.4		24	36	3.3K	6.5 $\pm$ 0.2
60.7	60.7	20		0.3		23	34	2.2K	5.5 $\pm$ 0.2
52.0	52.0	21		0.3		21	31	1.8K	4.5 $\pm$ 0.2
34.7	34.7	22		0.3		14	24	1.2K	3.5 $\pm$ 0.2
26.0	26.0	23		0.2		12	22	750	2.5 $\pm$ 0.2
17.3	17.3	25		0.2		8	19	430	1.5 $\pm$ 0.2
13.0	13.0	25		0.2		6	17	120 or less of short	0~0.9

\*9.3~10 or No input Voltage

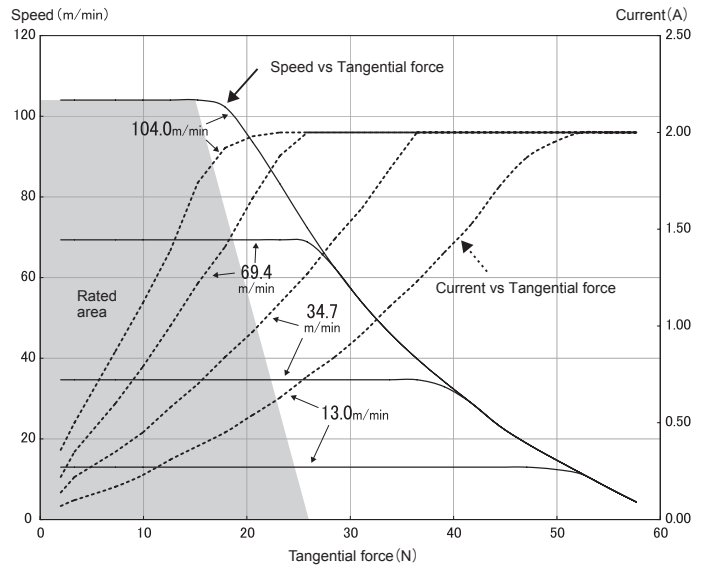

Operating characteristics : PM500XP

PM500XP-17

Speed (m/min)		Tangential Force (N)		Input Current (A)		Power Input (W)	Power Output (W)	External resistor ( $\Omega$ )	External input voltage (V)
No-load	Rated	Rated	Starting	No-load	Starting				
17.4	17.4	82	337	0.5	4.0	36	48	9.1K or over or open	9.3~10 *
15.9	15.9	88		0.5		35	48	6.2K	8.5 $\pm$ 0.2
13.0	13.0	95		0.4		31	43	4.3K	7.5 $\pm$ 0.2
11.6	11.6	97		0.4		28	38	3.3K	6.5 $\pm$ 0.2
10.1	10.1	99		0.3		24	36	2.2K	5.5 $\pm$ 0.2
8.7	8.7	102		0.3		22	34	1.8K	4.5 $\pm$ 0.2
5.8	5.8	106		0.3		16	26	1.2K	3.5 $\pm$ 0.2
4.3	4.3	106		0.2		12	24	750	2.5 $\pm$ 0.2
2.9	2.9	112		0.2		8	19	430	1.5 $\pm$ 0.2
2.2	2.2	112		0.2		6	17	120 or less of short	0~0.9

\*9.3~10 or No input Voltage

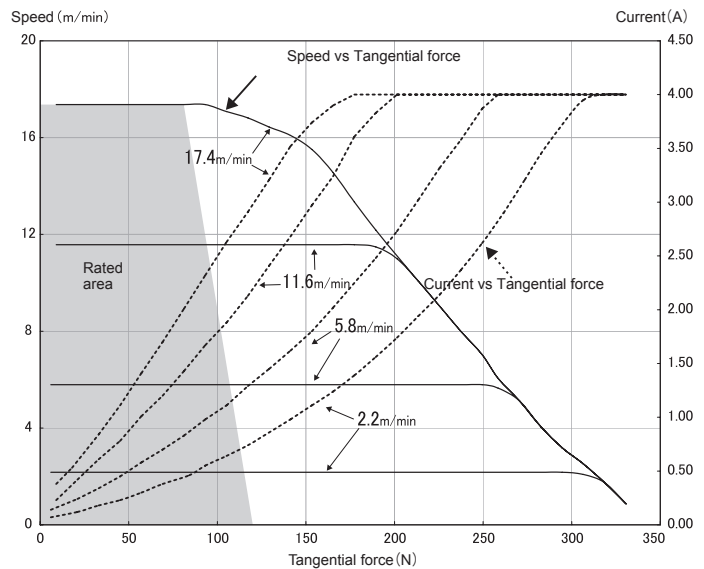

PM500XP-30

Speed (m/min)		Tangential Force (N)		Input Current (A)		Power Input (W)	Power Output (W)	External resistor ( $\Omega$ )	External input voltage (V)
No-load	Rated	Rated	Starting	No-load	Starting				
29.2	29.2	56	230	0.5	4.0	36	48	9.1K or over or open	9.3~10 *
26.8	26.8	60		0.5		35	48	6.2K	8.5 $\pm$ 0.2
21.9	21.9	65		0.4		31	43	4.3K	7.5 $\pm$ 0.2
19.5	19.5	66		0.4		28	38	3.3K	6.5 $\pm$ 0.2
17.0	17.0	68		0.3		24	36	2.2K	5.5 $\pm$ 0.2
14.6	14.6	70		0.3		22	34	1.8K	4.5 $\pm$ 0.2
9.7	9.7	73		0.3		16	26	1.2K	3.5 $\pm$ 0.2
7.3	7.3	73		0.2		12	24	750	2.5 $\pm$ 0.2
4.9	4.9	77		0.2		8	19	430	1.5 $\pm$ 0.2
3.7	3.7	77		0.2		6	17	120 or less of short	0~0.9

\*9.3~10 or No input Voltage

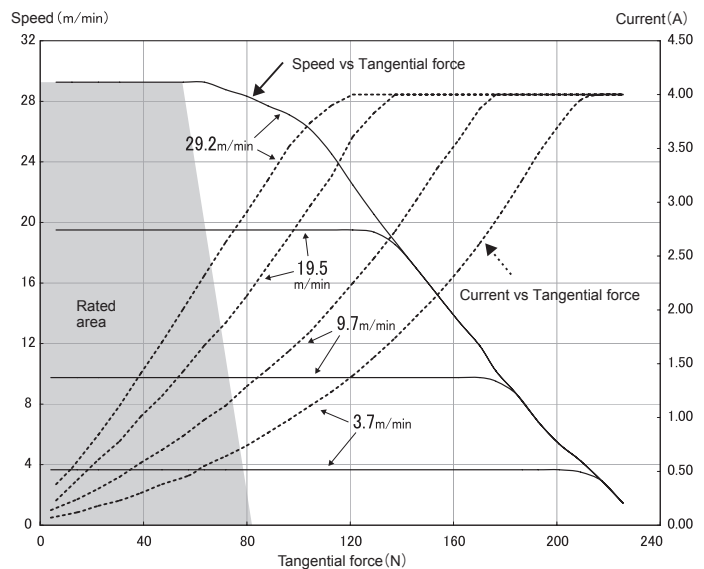

\*The values in the characteristics list are only for your reference and not the warranted values. The values represent the characteristics of a single standard motor roller (no linked operation) without including other specifications, and the values may change when including other specifications or with linked operation.

 [MDR Selection Tool] is available on our web page.

Operating characteristics : PM500XP

PM500XP-60

Speed (m/min)		Tangential Force (N)		Input Current (A)		Power Input (W)	Power Output (W)	External resistor ( $\Omega$ )	External input voltage (V)
No-load	Rated	Rated	Starting	No-load	Starting				
61.7	61.7	26	109	0.5	4.0	36	48	9.1K or over or open	9.3~10 *
56.6	56.6	28		0.5		35	48	6.2K	8.5 $\pm$ 0.2
46.3	46.3	31		0.4		31	43	4.3K	7.5 $\pm$ 0.2
41.2	41.2	31		0.4		28	38	3.3K	6.5 $\pm$ 0.2
36.0	36.0	32		0.3		24	36	2.2K	5.5 $\pm$ 0.2
30.9	30.9	33		0.3		22	34	1.8K	4.5 $\pm$ 0.2
20.6	20.6	34		0.3		16	26	1.2K	3.5 $\pm$ 0.2
15.4	15.4	34		0.2		12	24	750	2.5 $\pm$ 0.2
10.3	10.3	36		0.2		8	19	430	1.5 $\pm$ 0.2
7.7	7.7	36		0.2		6	17	120 or less of short	0~0.9

\*9.3~10 or No input Voltage

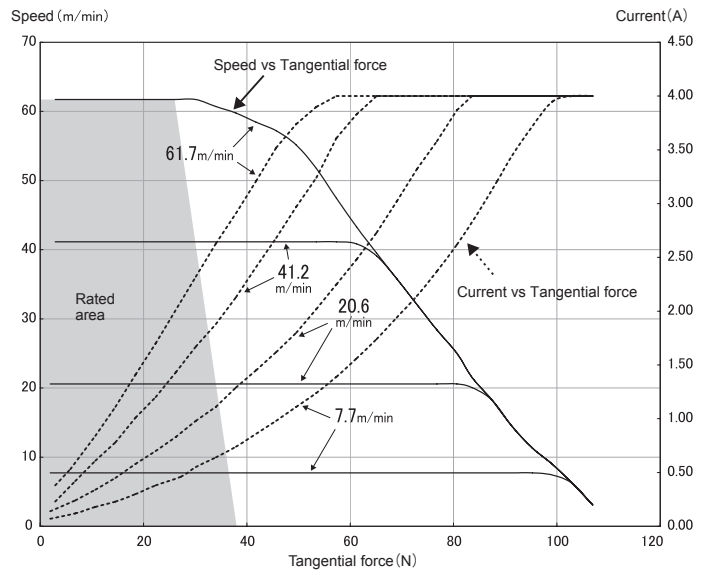

PM500XP-100

Speed (m/min)		Tangential Force (N)		Input Current (A)		Power Input (W)	Power Output (W)	External resistor ( $\Omega$ )	External input voltage (V)
No-load	Rated	Rated	Starting	No-load	Starting				
104.0	104.0	18	74	0.5	4.0	36	48	9.1K or over or open	9.3~10 *
95.4	95.4	19		0.5		35	48	6.2K	8.5 $\pm$ 0.2
78.0	78.0	21		0.4		31	43	4.3K	7.5 $\pm$ 0.2
69.4	69.4	21		0.4		28	38	3.3K	6.5 $\pm$ 0.2
60.7	60.7	22		0.3		24	36	2.2K	5.5 $\pm$ 0.2
52.0	52.0	22		0.3		22	34	1.8K	4.5 $\pm$ 0.2
34.7	34.7	23		0.3		16	26	1.2K	3.5 $\pm$ 0.2
26.0	26.0	23		0.2		12	24	750	2.5 $\pm$ 0.2
17.3	17.3	25		0.2		8	19	430	1.5 $\pm$ 0.2
13.0	13.0	25		0.2		6	17	120 or less of short	0~0.9

\*9.3~10 or No input Voltage

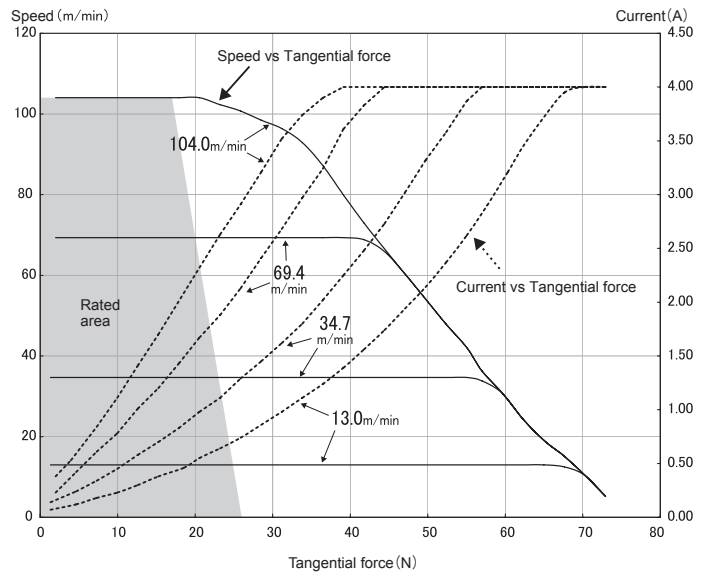

\*The values in the characteristics list are only for your reference and not the warranted values. The values represent the characteristics of a single standard motor roller(no linked operation) without including other specifications, and the values may change when including other specifications or with linked operation.